

# CLASS SCHEDULE

FALL 2017



CONTRA  
COSTA  
COLLEGE

WWW.CONTRACOSTA.EDU

FALL REGISTRATION  
STARTS MAY 1

CLASSES START  
AUGUST 11



[f/contracostacollege](https://www.facebook.com/contracostacollege) [/lifeatccc](https://www.instagram.com/lifeatccc)

# FALL 2017 ACADEMIC CALENDAR

March 2 - April 15	Filing period to submit early fall 2017 graduation application to receive early registration appointment for fall 2017
April 1-30	Filing period for continuing and returning students with over 100 degree applicable units or on second semester probation or dismissal who want to appeal their registration date
May 1-2	Priority registration for EOPS, DSPS, veterans, foster youth and CalWORKs students
May 3	Priority registration for DSPS notetakers, early graduation petitioners and intercollegiate athletes
May 4-16	Priority registration for continuing students and Middle College HS students who have completed the Student Success Program**
May 13	Priority registration for graduating high school seniors who have completed the Student Success Program**
May 17	Priority registration for new students who have completed the Student Success Program** and returning students with less than 100 degree applicable units
May 22	Registration for continuing and returning students with over 100 degree applicable units or on second semester probation or dismissal
May 26	Commencement
May 29	Holiday - Memorial Day
May 31-July 31	College is closed on Fridays during the summer
June 5-6	Registration for new students who did not complete the Student Success Program** and exempt students
June 26	In-person registration for concurrent special admit high school students
August 3-September 15	Filing period for early graduation petitioners to apply for priority registration for spring 2018
August 11	First day of instruction
August 12-13	Saturday/Sunday classes begin
August 25	Last day to add a full-term class
August 25	Last day to drop full-term classes with eligibility for fee refund
September 1	Last day to withdraw from a full-term class without a "W" appearing on transcript (in person)
September 4	Last day to withdraw from a full-term class without a "W" appearing on transcript (online)
September 4	Holiday - Labor Day
September 5	Census for full-term courses
September 8	Last day to choose Pass/No Pass (P/NP) grading option for full-term courses
September 22	Holiday - Native American Day
November 1	Last day to petition to graduate for fall 2017
November 1-30	Appeal filing period for continuing and returning students with over 100 degree applicable units or on 2nd semester probation or dismissal for spring registration
November 10	Holiday - Veterans Day
November 17	Last day to withdraw from a full-term class with a "W" appearing on transcript
November 17	Last day to add or adjust a variable-unit class
November 23-24	Thanksgiving Holiday
November 25-26	No Saturday/Sunday classes
December 9-15	Final examination week
December 15	Last day of instruction for fall
December 21-January 2	Winter Recess - CONTRA COSTA COLLEGE IS CLOSED

\*\* The Student Success Program includes assessment, orientation, and completion of an educational plan (Enroll in COUNS-108 or ESL-108)  
Info: Students may register online until 11:59pm, the day prior to the first class meeting.

**IMPORTANT NOTE:** For short-term courses the dates to add, receive a refund, or drop are calculated individually based on the length of each course.  
For detailed course-specific deadline dates, log into your Insite WebAdvisor student account and select "My Class Schedule." You may also check with your instructor, who has this information on the class roster.



# FINAL EXAM SCHEDULE • FALL 2017

## FINALS WEEK: DECEMBER 9-15

Final examination week at Contra Costa College is Saturday, December 9 through Friday, December 15. All final exams must be given in accordance with the following schedule. For example: if your class starts at 9:10 a.m. on Monday, Wednesday, and Friday, look at the schedule below and find the row that shows 9:10 a.m. To the right, you will see that your final exam for that course will be Wednesday, December 13, from 9:00 a.m. to 11:00 a.m.

### MWF, MW, WF, MTWTH or Daily Classes (M-F)

If your class begins at:

Your final exam is on:

	Monday, December 11	Wednesday, December 13
8:10/8:40 a.m.	8:00 a.m. to 9:50 a.m.	
9:10/9:40 a.m.		9:00 a.m. to 10:50 a.m.
10:10/10:40 a.m.	10:00 a.m. to 11:50 p.m.	
11:10/11:40 a.m.		11:00 a.m. to 12:50 p.m.
12:10/12:40 p.m.	Noon to 1:50 p.m.	
1:10/1:40 p.m.		1:00 p.m. to 2:50 p.m.
2:10/2:40 p.m.	2:00 p.m. to 3:50 p.m.	
3:10/3:40 p.m.		3:00 p.m. to 4:50 p.m.

### TTH or Daily Classes

If your class begins at:

Your final exam is on:

	Tuesday, December 12th	Thursday, December 14th
8:10/8:40 a.m.	8:00 a.m. to 9:50 a.m.	
9:10/9:40 a.m.		9:00 a.m. to 10:50 a.m.
10:10/10:40 a.m.	10:00 a.m. to 11:50 p.m.	
11:10/11:40 a.m.		11:00 a.m. to 12:50 p.m.
12:10/12:40 p.m.	Noon to 1:50 p.m.	
1:10/1:40 p.m.		1:00 p.m. to 2:50 p.m.
2:10/2:40 p.m.	2:00 p.m. to 3:50 p.m.	
3:10/3:40 p.m.		3:00 p.m. to 4:50 p.m.

Evening classes that meet after 4:00 p.m. will meet once during finals week. Short-term classes will follow their regular schedule during finals week.

CONFLICT RESOLUTION DAY: Final exam times which conflict may be held on December 9.

# FINANCIAL AID INFORMATION

The Office  
of Financial Assistance  
is now on social media!  
Follow for updates, deadlines,  
and other important financial aid  
information. Find us at @finaidatccc  
on Facebook, Instagram  
and Twitter.

## Board of Governors (BOG) Fee Waiver

Students who meet specific income and academic requirements can have their class fees waived. Applications are available online at [www.contracosta.edu](http://www.contracosta.edu). If you have already filed your 2017-2018 Free Application for Federal Student Aid (FAFSA) you may already have a fee waiver awarded. Please check your Insite WebAdvisor account under Financial Aid Status by Term by logging on to [www.ccd.edu/insite](http://www.ccd.edu/insite).

## FAFSA

Fill out the FREE Application for Federal Student Aid (FAFSA) to see if you are eligible to receive free cash aid to go to school. Apply online at [www.fafsa.gov](http://www.fafsa.gov). To apply for financial aid for the fall 2017 semester you must complete the 2017-18 FAFSA. Contra Costa College's school code is 001190.

## Cal Grant Deadline

The State of California offers state aid through the Cal Grant program. To determine your eligibility for this additional state aid you must complete all necessary application paperwork by the Cal Grant deadline. The deadline is March 2 annually for the following academic year, with a second deadline of September 2 annually (for community college students only). For more information, visit [www.calgrants.org](http://www.calgrants.org).

## California Dream Act

If you are not a U.S. citizen or eligible non-citizen (including undocumented and DACA students) and meet AB540 requirements, you may qualify for state financial aid programs. Apply online by completing the Dream Act Application at [www.caldreamact.org](http://www.caldreamact.org). The deadline is March 2 annually for the following academic year.

**For additional information** about financial aid, including important policies, guidelines, and processes, please visit [www.contracosta.edu/financialaid](http://www.contracosta.edu/financialaid). You can also stop by the Office of Financial Assistance located in the Student Services Center, Room 102, or call us with general questions at (510) 215-6026.

## Pell Lifetime Eligibility Limit

The duration of a student's eligibility to receive a Federal Pell Grant is 12 full-time semesters (or its equivalent). The calculation of the duration of a student's eligibility will include all years of the student's receipt of Federal Pell Grant funding. Once a student has received a Federal Pell Grant for 12 full-time semesters (or its equivalent), the student will no longer be eligible for a Federal Pell Grant for future semesters. There is no appeal process for this limit.

## High School Graduation Requirements

Students who do not have a high school diploma or a recognized equivalent (e.g., GED), or do not meet the home school requirements, will not be eligible to receive federal student aid. Students may qualify for federal student aid under one of the Ability-to-Benefit (ATB) alternatives if the student was enrolled in an eligible program prior to July 1, 2012. The ATB alternatives include the student passing an independently administered, approved ATB test or successfully completing at least six credit hours of postsecondary education.

## Financial Aid Repeat Course Policy

The Department of Education has set a limit on the number of times a course can be repeated before it is excluded from a student's enrollment status for financial aid purposes. To read the policy in its entirety, visit [www.contracosta.edu/financialaid](http://www.contracosta.edu/financialaid).

## Satisfactory Academic Progress (SAP) Policy

In accordance with federal financial aid regulations, students are required to maintain minimum academic and progress requirements in order to remain eligible to receive financial assistance. To read the SAP Policy in its entirety, visit [www.contracosta.edu/financialaid](http://www.contracosta.edu/financialaid).

## Need help filling out your application online?

Visit the Financial Aid Computer Lab for one-on-one help from a financial aid staff member. The Financial Aid Computer Lab is located in the Assessment Center in the Student Services Center. The lab is open during limited hours. For a listing of lab hours, visit [www.contracosta.edu/financialaid](http://www.contracosta.edu/financialaid). Applying for financial aid has never been easier!

# Where do I start at Contra Costa College?

## STEPS TO SUCCESS • FALL 2017

### STEP 1 - Submit an Application for Admission

Go to [www.contracosta.edu/apply](http://www.contracosta.edu/apply) to complete your application online. To submit an application in person visit the Welcome Center, Room 111 in the Student Services Center.

### STEP 2 - Apply for Financial Aid

College can be expensive, but we are here to help! Federal and state financial aid is available to students who qualify. If you are a U.S. citizen or eligible non-citizen, get help paying for college by completing the Free Application for Federal Student Aid (FAFSA) online at [www.fafsa.gov](http://www.fafsa.gov). If you are not a U.S. citizen or eligible non-citizen (including undocumented students, nonresidents, and DACA students) and meet AB 540 requirements, complete the Dream Act Application to qualify for state aid programs at [www.caldreamact.org](http://www.caldreamact.org). Not sure if you meet AB540? See the Admissions & Records Office to inquire on your status.

Students who complete the FAFSA or Dream Act Application will be automatically considered for the Board of Governors (BOG) Fee Waiver, which waives your class fees. There's no need to fill out a separate application! If you would like to apply for only the BOG and not for grants, loans, or work study, you may complete the BOG application, which is available on our website. You can also visit the Office of Financial Assistance in person to pick up a paper application.

Need help filling out your application online? Visit the Financial Aid Computer Lab for one-on-one help from a financial aid staff member. For lab hours, visit [www.contracosta.edu/financialaid](http://www.contracosta.edu/financialaid). Applying for financial aid has never been easier!

### STEP 3 - Complete the Assessment

We want to meet you where you are! Assessing your math and English or English as a Second Language (ESL) skills will help you choose the right classes. You have two options to find out your class placement recommendation. Visit [www.contracosta.edu/assessment](http://www.contracosta.edu/assessment) to use your high school transcripts to self-report grades from classes you have already taken. You can also make an appointment, online or in person, to take an assessment test in the Assessment Center, Room 104 of the Student Services Center.

### STEP 4 - Complete orientation or Enroll in ESL-108\*

New students at Contra Costa College are required to complete orientation. Orientation is offered online through self-paced modules where you will learn a wealth of information about programs, classes, support services, and campus policies. After you submit your application for admission, you will receive

an email with a link to the online orientation.

\* For non-native English speakers and learners, an in-person class, ESL-108 was designed as an alternative to the online orientation. Information on ESL-108 can be found at [insite.4cd.edu/search](http://insite.4cd.edu/search).

### STEP 5 - Enroll in Counseling-108 (COUNS-108) and Develop an Educational Plan

An educational plan is a map to help you identify the courses required to complete your goals. By enrolling in COUNS-108: Introduction to Educational Planning, you will work with a counselor to identify your specific program of study and the most direct route from start to finish. Information on COUNS-108 can be found at [www.contracosta.edu/steps-to-success](http://www.contracosta.edu/steps-to-success).

### STEP 6 - Register for Classes

Now that you have a plan for meeting your educational goals, registering for classes is simple. Log in to the Insite Portal to register for classes directly from your student educational plan. If you need help in person, visit the Welcome Center located in the Student Services Center, Room 111.

### GET YOUR STUDENT ID

Visit the Welcome Center in the Student Services Center, Room 111. Bring proof of enrollment and personal identification.

### NEED HELP?

If you need additional support and guidance getting started with the admissions or registration process, please visit the Welcome Center in the Student Services Center, Room 111. Call (510) 215-4110 for current center hours of operation or visit [www.contracosta.edu/welcomecenter](http://www.contracosta.edu/welcomecenter).

### PARKING INFORMATION

A parking permit is needed to park on campus. You may purchase a parking permit for the semester online via the InSite Portal. Log in and click on "Students" tab then select "Academic Services"; have your vehicle registration information ready to enter. You may also purchase daily permits at machines located in multiple campus parking lots.

### Bookstore

For information about required textbooks and prices, please visit the bookstore's website at [www.contracostabooks.com](http://www.contracostabooks.com).

**Admissions  
& Records**  
(510) 215 6027  
SSC, Rm 115

**Assessment  
Center**  
(510) 215 3896  
SSC, Rm 104

**Counseling**  
(510) 215 3934  
or (510) 215 3936  
SSC, Rm 108

**Financial Aid**  
(510) 215 6026  
SSC, Rm 102

**Welcome Center**  
(510) 215 4110  
SSC, Rm 111

# Como comienzo en Contra Costa College?

## PASOS AL ÉXITO • OTOÑO 2017

### PASO 1 - Presentar una Solicitud de Admisión

Para completar su solicitud de admisión visite la página: [www.contracosta.edu/apply](http://www.contracosta.edu/apply). Para presentar una solicitud en persona puede visitar la oficina de Welcome Center en el edificio de Student Services Center, oficina 111.

### PASO 2 - Aplicar para Ayuda Financiera

Asistir al colegio puede ser costoso, pero estamos aquí para ayudar! Tenemos disponible ayuda financiera Federal y Estatal para los estudiantes que califican. Si usted es un ciudadano estadounidense o extranjero que califica tiene derecho a obtener ayuda para pagar su educación al completar la Solicitud Gratuita de Ayuda Federal para Estudiantes (FAFSA) en línea [www.fafsa.gov](http://www.fafsa.gov). Si usted no es un ciudadano estadounidense o extranjero elegible (incluyendo a los estudiantes indocumentados, residentes y estudiantes DACA) y cumple con los requisitos de Assembly Bill AB540: complete la aplicación de Dream Act para calificar para programas de ayudas estatales ingresando a [www.caldreamact.org](http://www.caldreamact.org). ¿No está seguro si cumple los requisitos de AB540? visite la oficina de Admissions & Records, oficina 115.

Los estudiantes que completen la aplicación de FAFSA o Dream Act serán considerados automáticamente para la exoneración de cuotas a través del programa Board of Governors (BOG Fee Waiver) que cubre el costo de matrícula. No hay necesidad de llenar una solicitud por separado! Si desea solicitar sólo el BOG y no los demás tipos de ayuda como grants, préstamos, o work-study, usted puede completar la solicitud que está disponible en nuestro sitio web. También puede visitar la Oficina de Financial Aid para recoger una solicitud. ¿Necesita ayuda para llenar su solicitud en línea? La oficina de Financial Aid ofrece asistencia individual, para horas exactas en el laboratorio visite [visit www.contracosta.edu/financialaid](http://www.contracosta.edu/financialaid), y haga clic en Financial Aid. Solicitar ayuda financiera nunca ha sido tan fácil!

### PASO 3 - Completar la Evaluación de Inglés, Matemáticas o Inglés como Segunda Lengua

Vamos a ayudarte a elegir los cursos correctos! Evaluar tus habilidades en matemáticas, Inglés o Inglés como Segundo Lengua (ESL) te ayudará a elegir las clases correctas. Tienes dos opciones para saber cuáles son tus niveles académicos en dichas áreas. Puedes usar tus high school transcripts y auto-reportar tus calificaciones de la secundaria o puede hacer una cita, en línea o en persona, para tomar la prueba de evaluación en el Assessment Center, Sala 104 en Student Services Center. Visita [www.contracosta.edu/assessment](http://www.contracosta.edu/assessment) para más información.

### PASO 4 - Completa Orientación o Inscribirse en ESL-108\*

Contra Costa College requiere que estudiantes nuevos completen una orientación. La orientación se ofrece en línea a través de módulos donde aprenderá una gran cantidad de información acerca de los programas, clases de apoyo, servicios y pólizas del colegio. Después de presentar su solicitud de admisión, usted recibirá un correo electrónico que proporciona instrucciones de como completar la orientación en línea. \*Para los estudiantes cuyo segundo idioma es Inglés, tienen la opción de completar la orientación en persona por medio de la clase ESL-108. Los horarios de estas clases los puede encontrar en [insite.4cd.edu/search](http://insite.4cd.edu/search).

### PASO 5 - Inscribirse en Counseling-108 (COUNS-108) y Desarrollar un Plan de Educación

Por medio del curso de Counseling-108 los estudiantes obtienen un plan educativo que le ayudará a identificar los cursos necesarios para completar sus metas. Al inscribirse en COUNS-108: Introduction to Educational Planning, trabajará con un consejero para identificar el programa específico de estudio y la ruta más directa para completarlo. La información sobre las clases disponibles de COUNS-108 se puede encontrar en [www.contracosta.edu/steps-to-success](http://www.contracosta.edu/steps-to-success).

### PASO 6 - Inscribirse en las Clases

Ahora que tiene un plan para alcanzar sus metas educativas registrarse para las clases es simple. Ingrese a su cuenta de estudiante InSite/ WebAdvisor por medio de: [www.contracosta.edu](http://www.contracosta.edu). Si necesita ayuda en persona, visite la oficina Welcome Center en el edificio de Student Services Center.

### OBTENGA SU TARJETA DE IDENTIFICACIÓN DE ESTUDIANTE

Visite el Welcome Center ubicado en el edificio de Student Services Center, oficina 111. Necesitará prueba de inscripción y una identificación personal.

### ¿NECESITA AYUDA O ESTÁ CONFUNDIDO?

Si necesita ayuda adicional para empezar con el proceso de admisión o registro, visite el Welcome Center ubicado en el edificio de Student Services Center, oficina 111. Para el horario de la oficina llame al (510) 215-4110 o visite [www.contracosta.edu/welcomecenter](http://www.contracosta.edu/welcomecenter).

### INFORMACIÓN ACERCA DEL ESTACIONAMIENTO

Necesitará un permiso para poder estacionarse en el colegio. Usted puede comprar un permiso de estacionamiento en línea a través de InSite. Al ingresar a su cuenta, inicie su sesión por medio de WebAdvisor y haga clic en "Students" y luego en "Academic Services". Necesitará la información de registro del vehículo. Usted también puede comprar permisos de estacionamiento diarios en las máquinas situadas en varios estacionamientos en el colegio.

### OTRA INFORMACIÓN IMPORTANTE

**Bookstore:** Para obtener información acerca de los libros de texto requeridos y los precios, por favor visite [www.contracostabooks.com](http://www.contracostabooks.com).

**Admissions & Records**  
(510) 215 6027  
SSC, Rm 115

**Assessment Center**  
(510) 215 3896  
SSC, Rm 104

**Counseling**  
(510) 215 3934  
o (510) 215 3936  
SSC, Rm 108

**Financial Aid**  
(510) 215 6026  
SSC, Rm 102

**Welcome Center**  
(510) 215 4110  
SSC, Rm 111

# HOW DO I APPLY ONLINE TO CCC?

Visit [www.contracosta.edu/apply](http://www.contracosta.edu/apply).

Under “Step 1- Submit an Application”, click “Apply Now” to access the “Create an Account” page if it is your first time applying. Access [www.4cd.edu/insite](http://www.4cd.edu/insite) if you have an account.\*

**IMPORTANT!** Provide a valid email address.

**\*NOTE:** Returning students who previously applied using CCCApply must create a new account. OpenCCC is our new application system.

For future reference, be sure to write down your:

Username: \_\_\_\_\_  
Password: \_\_\_\_\_

If you forgot your account, click on “Sign In” and then “I forgot my username” and/or “I forgot my password”.

**APPLY NOW**

**Application to College**

Before applying to college you must first have an OpenCCC account.

The OpenCCC single sign-in account allows you to access the online services of the California Community Colleges.

OpenCCC is a service of the California Community Colleges Chancellors Office. The information in your account is kept private and secure.

[Create an Account](#) or [Sign In](#)

**Note:** OpenCCC is a new systemwide account. Accounts from our previous application system are not available. Please create an account if you have not already done so.

OpenCCC is a service of the  
CALIFORNIA COMMUNITY COLLEGES  
CHANCELLOR'S OFFICE

Sign in

OpenCCC

To continue to a California Community College secure web application, please sign in or create a new account.

Username:  [I forgot my username](#)

Password:  [I forgot my password](#) [Sign In](#)

[Create a New Account](#)

[Help](#) [Privacy Policy](#)

OpenCCC is a service of the  
CALIFORNIA COMMUNITY COLLEGES  
CHANCELLOR'S OFFICE

CONTRA COSTA COLLEGE  
a premier community college right in your backyard

Welcome First Last [Sign Out](#) | [My Applications](#) | [Help](#)

For your security always sign out before leaving.

**My Applications** [Cambiar A Español](#)

First Middle Last | [Edit My OpenCCC Account](#)

[Start A New Application](#)

OpenCCC is a service of the  
CALIFORNIA COMMUNITY COLLEGES  
CHANCELLOR'S OFFICE

Click on  
“Start A New Application”  
to begin your application.

## IMPORTANT

It is recommended but not required to provide your Social Security Number when you apply. If you provide your SSN on this application you may find it easier to access your student records when you need them if you forget or misplace your CCC student ID number. If you **do not** provide your SSN or do not have one, you will always need to use your CCC student ID number to access your student records. This information is emailed to you when you apply online. You will need to come in person to the Admissions & Records office or Enrollment Lab and bring a photo ID to obtain your student ID number and InSite WebAdvisor User Name if you misplace this information. All institutions are required by law to keep your SSN private and secure, and not to reveal it without your permission.

# How Do I Register for Classes via Student Planning?

1) Log into Insite Portal &  
Click **Student Planning**

2) Select **Student Planning**  
3) Click #2 **Plan & Register**

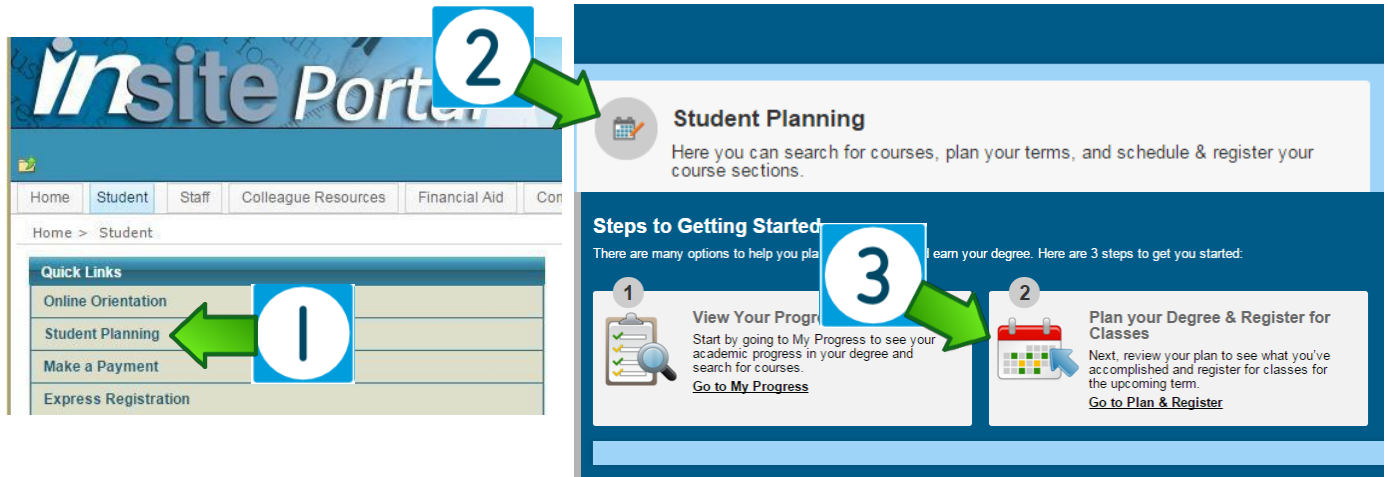

4) Search classes in **Course Search Box** (at top right of page)

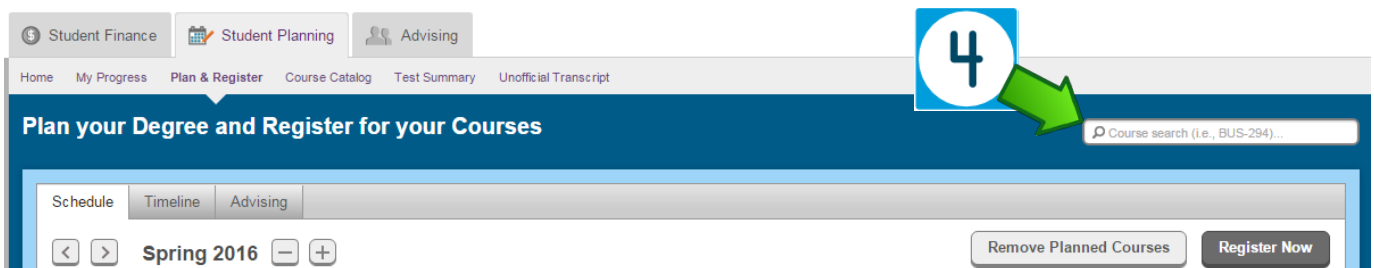

5) Click **Add Course to Plan**

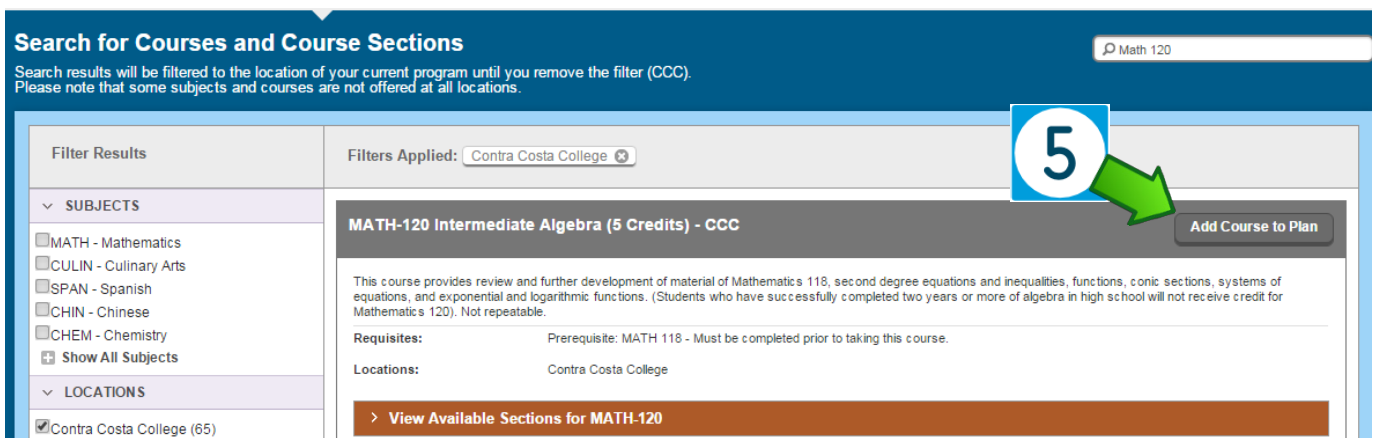

– continued on the next page



6) **Select a Term** from the dropdown menu

7) Click **Add Course to Plan**

**Course Details**

**MATH-120: Intermediate Algebra**

This course provides review and further development of material of Mathematics 118, second degree equations and inequalities, functions, conic sections, systems of equations, and exponential and logarithmic functions. (Students who have successfully completed two years or more of algebra in high school will not receive credit for Mathematics 120). Not repeatable.

**Credits** 5

**Locations Offered** Contra Costa College

**Requisites** ⚠ Prerequisite: MATH 118 - Must be completed prior to taking this course.

**Term** Select a Term...  
Fall 2015  
**Spring 2016**  
Summer 2016  
Fall 2016  
Spring 2017  
Summer 2017  
Fall 2017  
Spring 2018

Close Add Course to Plan

8) Return to **Plan & Register** Select the term using the arrows

9) Click **View other sections** to select a section for each class

10) Click **Register Now** after selecting your sections

Student Finance Student Planning Advising

Home My Progress Plan & Register Course Catalog Test Summary Unofficial Transcript

**Plan your Degree and Register Courses**

Schedule Timeline Advising

Spring 2016

⚠ Your registration period for Spring 2016 begins on 12/16/2015 at 7:00 AM Refresh

Planned: 9 Credits Enrolled: 0 Credits Waitlisted: 0 Credits

Filter Sections Print Save to iCal

ENGL-001A: Composition and Reading

Prerequisite: ENGL 142B or ESL-195 with a minimum grade of C, or a passing COMPASS score. - Must be completed prior to taking this course.

View other sections

1 of 4

ENGL-001A-1551: Composition and Reading

Seats Available: 30

Instructor: Lam, D

Time: TTh 5:40 PM - 7:30 PM

Dates: 1/22/2016 - 5/27/2016

Location: Contra Costa College Liberal Arts 105 (Composition)

ENGL-001A-1854

ENGL-001A-4122

ENGL-001A-1854

ENGL-001A-4122

ENGL-001A-2053

ENGL-001A-1552

ENGL-001A-1552

ENGL-001A-3190

Remove Planned Courses Register Now

**\*\* Once the semester has started, students must use Express Registration/Search & Register instead \*\***

# FEES AND TUITION

FEE TYPE	AMOUNT *	COMMENTS
Enrollment Fee.*	\$46 per unit	California residents pay an enrollment fee of \$46* per unit of credit.
Nonresident Fee	\$300 total per unit	Nonresidents of California pay an enrollment fee of \$46* per unit of credit, plus \$228 in tuition per unit of credit, plus \$26 for a capital outlay fee, per unit.
Non-U.S. Citizen Tuition (including International Students)	\$300 total per unit	Non-U.S. citizens who cannot establish California residency pay an enrollment fee of \$46* per unit of credit, plus \$228 in tuition per unit of credit, plus \$26 for a capital outlay fee, per unit of credit.
Health Insurance for International Students	\$500 for fall per student \$700 for spring/summer 2018 per student	Health insurance for international students is mandatory. Students who do not provide proof of health insurance to the International Office before the term begins will be automatically enrolled in a health plan offered by the district.
Parking Permit	\$48 per semester for a car or \$3 per day, (subject to change at any time without notice) and \$30 per semester for a motorcycle. Mid-semester parking - \$24 cars and \$15 motorcycles	Term-length parking permits can only be purchased online through the Insite Portal. BOGW (fee waiver) recipients receive a discount on parking permits.
Instructional Material Fees <sup>1</sup>	Variable by course	See policy statement below.
Student Activity Fee** (This is an optional fee.)	\$5.00 per semester	The Student Activity Fee allows the Contra Costa College Associated Students Union (student government) to provide funding for campus clubs, events, activities, and campus-based programs that will benefit the student population. Examples of programs which the activity fee could support are student scholarships, textbook scholarships, multi-cultural campus events, and community resource outreach programs.
Student Representation Fee	\$1 per semester, required. Non-refundable.	All students.
Student ID Card	No charge for ID card or semester stickers	Student ID cards and semester stickers can be obtained in the Welcome Center located in the Student Services Center. All students must show proof of registration.
Transcript Fee <sup>2</sup>	All requests require written authorization and advance payment. Standard: First 2 copies in the district are free, \$5 thereafter. Rush: \$15 per transcript; \$10 if the student qualifies for either of his/her 2 free copies. Express: \$30 per transcript; \$25 if the student qualifies for either of his/her 2 free copies.	Standard: Mailed through the U.S. Postal Service within 7-10 business days. No student pick up allowed for standard service. Rush: Mailed by U.S. Postal Service next business day or for pick up. Express: Same day service prepared for student pick up (may not always be available).
Verification Fee	\$2 per copy First 2 copies are free \$5 letterhead verification	Written authorization is required. Verifications requested through the Admissions & Records Office will be charged \$2 for each request. Students can receive free verifications of enrollment through the Insite Portal.

\* This amount may be changed by the governor/state legislature without notice.

\*\* Fee is voluntary. Refund forms are available at the Student Life Office. Refund forms must be submitted in person to the Cashier's Office within the first two (2) weeks of instruction. Refund checks will be issued monthly after the first two (2) weeks of instruction each term.

1. Instructional Material Fees: For your convenience the bookstore offers required course materials at a reasonable cost. You have the option to purchase your materials from another vendor. If you choose this option, please obtain a note from your instructor and take it to the Cashier's Office to have the fees removed from your account.
2. Transcripts: Students may receive two (2) free transcripts across the district (e.g. one (1) at CCC and one (1) at DVC equals two (2)).

A Transcript Request Form is available on the college website and at the Admissions & Records Office. It can be mailed **or** faxed to (510) 412-0769. All requests must include payment for associated fees. This includes electronic transcripts.

# FALL 2017 SCHEDULE OF CLASSES

**NOTE:** Classes shaded in "Grey" are evening classes!

**sec days hrs rm instr dates**

## Administration of Justice

### ADJUS-120 Introduction to Administration of Justice - (LR) - 3 Units

3417 TTH 12:40-2:00pm AA-142 Ramos, R 8/11 - 12/15

#### Online and Partially Online Sections

3423 ONLINE Ramos, R 8/11 - 12/15

Section 3423 is an online class. All instruction will be online. Students should go to <https://contracosta.instructure.com> and choose. This course and watch the course video tour. Your instructor will send a college email to you prior to class. You may contact your instructor at [rramos@contracosta.edu](mailto:rramos@contracosta.edu).

### ADJUS-121 Concepts of Criminal Law - (LR) - 3 Units

3424 TTH 9:40-11:00am AA-135 Ramos, R 8/11 - 12/15

### ADJUS-122 Criminal Procedures - (LR) - 3 Units

#### Online and Partially Online Sections

3427 ONLINE Ramos, R 8/11 - 12/15

Section 3427 is an online class. All instruction will be online. Students should go to <https://contracosta.instructure.com> and choose. This course and watch the course video tour. Your instructor will send a college email to you prior to class. You may contact your instructor at [rramos@contracosta.edu](mailto:rramos@contracosta.edu).

### ADJUS-124 Introduction to Corrections - (LR) - 3 Units

3305 MW 11:10-12:30pm AA-142 Harrison, P 8/11 - 12/15

### ADJUS-125 Report Preparation - (LR) - 3 Units

**Prerequisite:** ADJUS-121 (may be taken concurrently).

1395 M 6:10-9:00pm AA-142 Martin, K 8/11 - 12/15

### ADJUS-126 Counseling and Placement - (LR) - 3 Units

4126 MW 9:40-11:00am HS-3 Harrison, P 8/11 - 12/15

### ADJUS-135 Law and Democracy - (LR) - 3 Units

#### Online and Partially Online Sections

2173 ONLINE McCarty-Snead, S 8/11 - 12/15

Section 2173 is an online class. Students should go to <https://contracosta.instructure.com> and choose This course and watch the course video tour. Your instructor will send a college email to you prior to class. For more information email [smccarty@contracosta.edu](mailto:smccarty@contracosta.edu). This course transfers to CSU, UC and UCB as a social science elective.

### ADJUS-221 Legal Aspects of Evidence - (LR) - 3 Units

#### Online and Partially Online Sections

3419 ONLINE Ramos, R 8/11 - 12/15

Section 3419 is an online class. All instruction will be online. Students should go to <https://contracosta.instructure.com> and choose this course and watch the course video tour. Your instructor will send a college email to you prior to class. You may contact your instructor at [rramos@contracosta.edu](mailto:rramos@contracosta.edu).

**sec days hrs rm instr dates**

## African American Studies

### AFRAM-110 Introduction to African American Studies - (SC) - 3 Units

5055 TTH 11:10-12:30pm GE-312 Hodge, C 8/11 - 12/15

This class is part of the AFRAM Studies program.

### AFRAM-120 Black Experience Through Film - (SC) - 3 Units

1152 F 1:10-4:00pm GE-312 Martinez, D 8/11 - 12/15

This class is a part of the AFRAM Studies program.

### AFRAM-226 Black Male and Female Relationships - (SC) - 3 Units

6002 TTH 2:10-3:30pm GE-312 Dugas, S 8/11 - 12/15

This class is part of the AFRAM Studies program.

### DRAMA-110 African American Theatre - (SC) - 3 Units

1062 MW 2:10-3:30pm GE-312 Ivory, T 8/11 - 12/15

This class is a part of the AFRAM Studies program.

### HIST-110 History of African Civilization - (SC) - 3 Units

1158 TTH 12:40-2:00pm GE-313 Ampim, M 8/11 - 12/15

Section 1158 is required for all students in the Per Ankh Program, but is open to all students. This class is part of the AFRAM Studies program.

### HIST-122 History of African Americans in the U.S. - (SC) - 3 Units

3573 TTH 9:40-11:00am GE-312 Hodge, C 8/11 - 12/15

This class is a part of the AFRAM Studies program.

2244 MW 11:10-12:30pm GE-312 Hodge, C 8/11 - 12/15

This class is a part of the AFRAM Studies program.

1331 MW 4:10-5:30pm GE-312 Hodge, C 8/11 - 12/15

This class is a part of the AFRAM Studies program.

### HUMAN-113 African American Humanities - (SC) - 3 Units

1099 MW 9:40-11:00am GE-113 Artry Diouf, E 8/11 - 12/15

This class is a part of the AFRAM Studies program.

1097 TTH 12:40-2:00pm GE-312 Martinez, D 8/11 - 12/15

This class is a part of the AFRAM Studies program.

### POLSC-225 Dynamics of African American Politics in America - (SC) - 3 Units

1713 MW 9:40-11:00am GE-312 Hodge, C 8/11 - 12/15

This class is a part of the AFRAM Studies program.

sec	days	hrs	rm	instr	dates
<b>Anthropology</b>					
<b>ANTHR-130 Cultural Anthropology - (SC) - 3 Units</b>					
0932	TTH	9:40-11:00am	GE-314	Hawthorne, N	8/11 - 12/15
7266	MW	11:10-12:30pm	GE-314	Revenaugh, A	8/11 - 12/15
8381	M	6:10-9:00pm	GE-212	Hawthorne, N	8/11 - 12/15

<b>ANTHR-140 Introduction to Physical Anthropology - (LR) - 3 Units</b>					
1364	F	8:10-11:00am	GE-314	Schwappach-Shirriff, L	8/11 - 12/15
7267	TTH	2:10-3:30pm	GE-314	Olson, K	8/11 - 12/15
1163	TTH	3:40-5:00pm	GE-314	Olson, K	8/11 - 12/15
1732	W	6:10-9:00pm	GE-314	Schwappach-Shirriff, L	8/11 - 12/15

**Online and Partially Online Sections**

0946	ONLINE			Schwappach-Shirriff, L	8/11 - 12/15
------	--------	--	--	------------------------	--------------

Section 0946 is offered in an online format with a mandatory online orientation. All instruction will be online. Contact is lschwappach-shirrif@contracosta.edu

**ANTHR-140L Physical Anthropology Laboratory - (LR) - 1 Unit**

**Prerequisite:** ANTHR-140 (may take concurrently)

1367	W	2:10-5:00pm	GE-314	Staff, C	8/11 - 12/15
7268	F	3:40-6:30pm	GE-314	Olson, K	8/11 - 12/15

**ANTHR-150 Magic, Witchcraft and Religion - (LR) - 3 Units**

2150	MW	9:40-11:00am	GE-314	Staff, C	8/11 - 12/15
------	----	--------------	--------	----------	--------------

**Art**

<b>ART-101 2-D Foundations in Art - (SC) - 3 Units</b>					
4101	MW	12:40-3:30pm	A-6B	Massadas, B	8/11 - 12/15

<b>ART-117 Appreciation of Art &amp; Architecture - (SC) - 3 Units</b>					
0860	MW	9:40-11:00am	A-2	Engelberg, T	8/11 - 12/15
0862	TTH	12:40-2:00pm	A-2	Massadas, B	8/11 - 12/15

**Online and Partially Online Sections**

0864	ONLINE			Holt, B	8/11 - 12/15
------	--------	--	--	---------	--------------

Section 0864 is offered online. An orientation meeting will be held on Monday, 8/14 from 5:40-8:30pm in CTC-128. This orientation is optional, but highly recommended for any students unfamiliar with online classes. Your instructor will send a college email to you prior to class. You may contact your instructor at bholt@contracosta.edu.

**ART-118 Multi-Cultural Survey of American Art - (SC) - 3 Units**

**Advisory:** Completion of, or concurrent enrollment in ENGL-001A.

1098	TTH	12:40-2:00pm	GE-311	Holt, B	8/11 - 12/15
------	-----	--------------	--------	---------	--------------

<b>ART-120 Figure Drawing I - (SC) - 3 Units</b>					
1704	TTH	12:40-3:30pm	A-6A	Cole, F	8/11 - 12/15

<b>ART-124 Painting: Beginning I - (SC) - 3 Units</b>					
2230	TTH	9:10-10:00am	A-6A	Gordon, C	8/11 - 12/15
		10:00-12:00pm	A-6B		

**ART-125 Painting: Beginning II - (SC) - 3 Units**

**Prerequisite:** ART-124

2231	TTH	9:10-10:00am	A-6A	Gordon, C	8/11 - 12/15
		10:00-12:00pm	A-6B		

sec	days	hrs	rm	instr	dates
<b>ART-132 Digital Art: Beginning I - (SC) - 3 Units</b>					
0514	MW	12:40-3:00pm	A-1	Gordon, C	8/11 - 12/15
<b>Online and Partially Online Sections</b>					
3132			ONLINE	Gordon, C	8/11 - 12/15
			-		

Section 3132 is an online course. All instruction will be online. Your instructor will send a college email to you prior to class. You may contact your instructor at cgordon@contracosta.edu.

<b>ART-133 Digital Art: Beginning II - (SC) - 3 Units</b>					
0516	MW	12:40-3:00pm	A-1	Gordon, C	8/11 - 12/15

<b>ART-135 Hot Metals Jewelry - Beginning I - (SC) - 3 Units</b>					
4020	MW	6:10-9:00pm	A-7	McDermott, W	8/11 - 12/15

Section 4020 has a mandatory materials fee of \$9.00.

<b>ART-136 Hot Metals Jewelry - Beginning II - (SC) - 3 Units</b>					
<b>Prerequisite:</b> ART-135					
4021	MW	6:10-9:00pm	A-7	McDermott, W	8/11 - 12/15
Section 4021 has a mandatory materials fee of \$9.00.					

<b>ART-140 Sculpture: Beginning I - (SC) - 3 Units</b>					
1481	TTH	9:40-12:30pm	A-8	Lu, J	8/11 - 12/15
Section 1481 has a mandatory materials fee of \$9.00.					

<b>ART-141 Sculpture: Beginning II - (SC) - 3 Units</b>					
<b>Prerequisite:</b> ART-140					
1482	TTH	9:40-12:30pm	A-8	Lu, J	8/11 - 12/15
Section 1482 has a mandatory materials fee of \$9.00.					

<b>ART-145 Ceramics: Beginning I - (SC) - 3 Units</b>					
3052	MW	9:10-12:00pm	A-8	Law, M	8/11 - 12/15
Section 3052 has a mandatory materials fee of \$9.00.					

<b>ART-146 Ceramics: Beginning II - (SC) - 3 Units</b>					
<b>Prerequisite:</b> ART-145					
3053	MW	9:10-12:00pm	A-8	Law, M	8/11 - 12/15
Section 3053 has a mandatory materials fee of \$9.00.					

<b>ART-158 Digital Photography: Beginning I - (SC) - 3 Units</b>					
2158	MW	10:10-12:30pm	A-1	Davis, D	8/11 - 12/15

<b>ART-159 Digital Photography: Beginning II - (SC) - 3 Units</b>					
<b>Prerequisite:</b> ART-158					
3159	MW	10:10-12:30pm	A-1	Davis, D	8/11 - 12/15

<b>ART-174 Drawing and Composition: Beginning I - (SC) - 3 Units</b>					
2460	MW	9:10-10:00am	A-6A	Gordon, C	8/11 - 12/15
		10:00-12:00pm	A-6B		

<b>ART-175 Drawing and Composition: Beginning II - (SC) - 3 Units</b>					
<b>Prerequisite:</b> ART-174					
2462	MW	9:10-10:00am	A-6A	Gordon, C	8/11 - 12/15
		10:00-12:00pm	A-6B		



sec	days	hrs	rm	instr	dates
<b>ART-194 Survey of Asian Arts - (SC) - 3 Units</b>					
<b>Advisory:</b> Completion of, or concurrent enrollment in, English 1A.					
<b>Online and Partially Online Sections</b>					
1418			ONLINE	Holt, B	8/29 - 12/15
Section 1418 is offered online. An orientation meeting will be held on Tuesday, 8/29 from 6:10-9:00pm in CTC-128. This orientation is optional, but highly recommended for any students unfamiliar with online classes. Your instructor will send a college email to you prior to class. You may contact your instructor at bholt@contracosta.edu.					
<b>ART-224 Painting: Intermediate I - (SC) - 3 Units</b>					
<b>Prerequisite:</b> ART-125					
1705	TTH	9:10-10:00am	A-6A	Gordon, C	8/11 - 12/15
		10:00-12:00pm	A-6B		
<b>ART-225 Painting: Intermediate II - (SC) - 3 Units</b>					
<b>Prerequisite:</b> ART-224					
2225	TTH	9:10-10:00am	A-6A	Gordon, C	8/11 - 12/15
		10:00-12:00pm	A-6B		
<b>ART-232 Digital Art: Intermediate I - (SC) - 3 Units</b>					
<b>Prerequisite:</b> ART-133					
5123	MW	12:40-3:00pm	A-1	Gordon, C	8/11 - 12/15
<b>ART-233 Digital Art: Intermediate II - (SC) - 3 Units</b>					
<b>Prerequisite:</b> ART-232					
5124	MW	12:40-3:00pm	A-1	Gordon, C	8/11 - 12/15
<b>ART-235 Hot Metals Jewelry - Intermediate I - (SC) - 3 Units</b>					
<b>Prerequisite:</b> ART-136					
1709	MW	6:10-9:00pm	A-7	McDermott, W	8/11 - 12/15
Section 1709 has a mandatory materials fee of \$9.00.					
<b>ART-236 Hot Metals Jewelry - Intermediate II - (SC) - 3 Units</b>					
<b>Prerequisite:</b> ART-235					
1717	MW	6:10-9:00pm	A-7	McDermott, W	8/11 - 12/15
Section 1717 has a mandatory materials fee of \$9.00.					
<b>ART-240 Sculpture: Intermediate I - (SC) - 3 Units</b>					
<b>Prerequisite:</b> ART-141					
1496	TTH	9:40-12:30pm	A-8	Lu, J	8/11 - 12/15
Section 1496 has a mandatory materials fee of \$9.00.					
<b>ART-241 Sculpture: Intermediate II - (SC) - 3 Units</b>					
<b>Prerequisite:</b> ART-240					
1486	TTH	9:40-10:30am	A-8	Lu, J	8/11 - 12/15
		10:40-12:30pm			
Section 1486 has a mandatory materials fee of \$9.00.					
<b>ART-245 Intermediate Ceramics: Intermediate I - (SC) - 3 Units</b>					
<b>Prerequisite:</b> ART-146					
3054	MW	9:10-10:00am	A-8	Law, M	8/11 - 12/15
		10:10-12:00pm			
Section 3054 has a mandatory materials fee of \$9.00.					
<b>ART-246 Intermediate Ceramics: Intermediate II - (SC) - 3 Units</b>					
<b>Prerequisite:</b> ART-245					
3055	MW	9:10-10:00am	A-8	Law, M	8/11 - 12/15
		10:10-12:00pm			
Section 3055 has a mandatory materials fee of \$9.00.					

sec	days	hrs	rm	instr	dates
<b>ART-258 Digital Photography: Intermediate I - (SC) - 3 Units</b>					
<b>Prerequisite:</b> ART-159					
4258	MW	10:10-12:30pm	A-1	Davis, D	8/11 - 12/15
<b>ART-259 Digital Photography: Intermediate II - (SC) - 3 Units</b>					
<b>Prerequisite:</b> ART-258					
4259	MW	10:10-12:30pm	A-1	Davis, D	8/11 - 12/15
<b>ART-274 Drawing and Composition: Intermediate I - (SC) - 3 Units</b>					
<b>Prerequisite:</b> ART-175					
2464	MW	9:10-10:00am	A-6A	Gordon, C	8/11 - 12/15
		10:00-12:00pm	A-6B		
<b>ART-275 Drawing and Composition: Intermediate II - (SC) - 3 Units</b>					
<b>Prerequisite:</b> ART-274					
2465	MW	9:10-10:00am	A-6A	Gordon, C	8/11 - 12/15
		10:00-12:00pm	A-6B		
<b>ART-298 Independent Study - (SC) - 3 Units</b>					
<b>Short Term/Late Start</b>					
1739				Gordon, C	8/11 - 12/15
<b>ART-810N Drawing for the Older Adult Student - (P/NP) - 0 Unit</b>					
2763	F	9:10-12:00pm	A-6A	Lu, J	8/11 - 12/15
2762	M	3:10-4:00pm	OPENHOU	Thongvanh, S	8/11 - 12/15
Section 2762 meets off campus at Open House Senior Center, 6500 Stockton Ave., El Cerrito. For more information, contact Sai Thongvanh at sthongvanh@contracosta.edu.					
<b>ART-811N Beginning and Intermediate Painting for Older Adults - (P/NP) - 0 Unit</b>					
2765	F	12:10-3:00pm	A-6A	Lu, J	8/11 - 12/15
Section 2765 meets off campus. For more information contact Jiajun Lu at jlu@contracosta.edu.					
2764	W	1:10-4:00pm	OPENHOU	Fenstermaker, D	8/11 - 12/15
Section 2764 meets off campus at Open House Senior Center, 6500 Stockton Ave., El Cerrito. For more information, contact Donna Fenstermaker at dfenstermaker@contracosta.edu.					
<b>ART-812N Exploration in 2-D Art for Seniors - (P/NP) - 0 Unit</b>					
2767	T	10:10-1:00pm	HERCSRCT	Thongvanh, S	8/11 - 12/15
Section 2767 meets off campus at Hercules Senior Center, 111 Civic Dr. Hercules. For more information contact Sai Thongvanh at sthongvanh@contracosta.edu					
2766	T	1:10-4:00pm	A-6B	Fenstermaker, D	8/11 - 12/15
Section 2766 meets in A 6B. For more information, contact Donna Fenstermaker at dfenstermaker@contracosta.edu.					

## Astronomy

### ASTRO-120 Elementary Astronomy - (LR) - 3 Units

**Advisory:** ENGL-142B or ESL-192

4994	MWF	9:10-10:00am	PS-132	Celesia, J	8/11 - 12/15
4995	MW	12:40-2:00pm	PS-132	Celesia, J	8/11 - 12/15
2387	TTH	12:40-2:00pm	PS-132	Celesia, J	8/11 - 12/15

sec	days	hrs	rm	instr	dates
<b>Automotive Services</b>					

**AUSER-097 Automotive Service Advising - (SC) - 3 Units**

1637	TH	1:10-4:00pm	AT-101	Beatty, L	8/11 - 12/15
1638	T	6:10-9:00pm	AT-101	Beatty, L	8/11 - 12/15
1649	T	6:10-9:00pm	AT-101	Beatty, L	8/11 - 12/15

Section 1649 is for apprentice students.

**AUSER-099 Occupational Work Experience - (SC) - 1-4 Units**

1161		Sturgeon, B	8/11 - 12/15		
		Section 1161 requires students to be working in the automotive industry.			
1166		Salas, L	8/11 - 12/15		
		Section 1166 requires students to be working in the automotive collision repair industry.			

**AUSER-101 Automotive Fundamentals - (LR) - 4 Units**

1149	THF	9:10-10:30am	AT-110	Beatty, L	8/11 - 12/15
	THF	10:40-12:00pm	AT-111		
6924	MT	1:10-4:00pm	AT-111	Rupprecht, N	8/11 - 12/15

**AUSER-103 Automotive Electrical/Electronic Systems - (LR) - 5 Units**

**Prerequisite:** AUSER-101 (may take concurrently)

0703	MTW	9:10-10:00am	AT-110	Beatty, L	8/11 - 12/15
		10:00-12:00pm	AT-111		

**AUSER-107 Introduction to Hybrid Electric Vehicles0 - (LR) - 3 Units**

**Prerequisite:** AUSER-103 or AUSER-190

1633	M	6:10-9:00pm	AT-110	Cortes, P	8/11 - 12/15
		Section 1633 is for apprentice students.			
2295	M	6:10-9:00pm	AT-110	Cortes, P	8/11 - 12/15

**AUSER-111 Automotive Brakes - (SC) - 5 Units**

**Prerequisite:** AUSER-101 (may be taken concurrently)

1632	TWTH	6:10-7:00pm	AT-110	Sturgeon, B	8/11 - 12/15
		7:00-9:00pm	AT-111		
1636	TWTH	6:10-7:00pm	AT-110	Sturgeon, B	8/11 - 12/15
		7:00-9:00pm	AT-111		

Section 1636 is for apprentice students.

**AUSER-113 Automotive Suspension and Steering - (SC) - 5 Units**

**Prerequisite:** AUSER-101 (may be taken concurrently)

1635	WTHF	1:10-2:00pm	AT-110	Sturgeon, B	8/11 - 12/15
		2:00-4:00pm	AT-111		

**AUSER-123 Introduction to Auto Collision Repair Technology - (LR) - 4 Units**

2493	MTWTH	8:10-9:00am	AT-101	Salas, L	8/11 - 12/15
------	-------	-------------	--------	----------	--------------

**AUSER-125 Introduction to Automotive Collision Repair Technology Laboratory - (LR) - 5 Units**

**Corequisite:** AUSER-123

2494	MTWTHF	9:10-12:00pm	AT-101	Salas, L	8/11 - 12/15
------	--------	--------------	--------	----------	--------------

**AUSER-141 Introduction to Damage Report Writing - (LR) - 3 Units**

1372	W	6:10-9:00pm	AT-101	DeMello, M	8/11 - 12/15
------	---	-------------	--------	------------	--------------

**AUSER-225 Advanced Automotive Collision Repair Laboratory - (LR) - 5 Units**

**Prerequisite:** AUSER-123 and AUSER-125

1671	MTW	1:10-2:00pm	AT-101	Lock, P	8/11 - 12/15
		2:00-4:00pm	AT-102		

sec	days	hrs	rm	instr	dates
-----	------	-----	----	-------	-------

**AUSER-226 Advanced Automotive Painting and Refinishing - (LR) - 5 Units**

**Prerequisite:** AUSER-124 and AUSER-126

1677	MTW	1:10-2:00pm	AT-101	Lock, P	8/11 - 12/15
		2:00-4:00pm	AT-102		

**Biological Science**
**BIOSC-106 Experimental Analysis in Biology - (P/NP) - .5 Unit**

**Short Term/Late Start**

3371	TH	6:10-9:00pm	B-24	Ponomareff, G	8 - 9/28
		Section 3371 meets on: 8, 8/24, 8/31, 9/7, 9/14, and 9/29. No class meeting on 9/21.			
1023	F	10:10-1:00pm	B-24	Dixon, D	8/18 - 9/29
		Section 1023 meets on: 8/18, 8/25, 9/1, 9/8, 9/15, and 9/29. No class meeting on 9/22.			
5041	F	2:10-5:00pm	B-24	Ng, K	8/18 - 9/29
		Section 5041 meets on: 8/18, 8/25, 9/1, 9/8, 9/15, and 9/29. No class meeting on 9/22.			
2842	TH	6:10-9:00pm	B-24	Tarp, C	10/5 - 11/16
		Section 2842 meets on: 10/5, 10/12, 10/19, 10/26, 11/2, and 11/16. No class meeting on 11/9.			
1036	F	10:10-1:00pm	B-24	Coatney, E	10/6 - 11
		Section 1036 meets on: 10/6, 10/13, 10/20, 10/27, 11/3, and 11 No class meeting on 11/10.			

**BIOSC-110 Introduction to Biological Science - (LR) - 4 Units**

1349	MF	8:10-9:30am	B-7	Anderson, T	8/11 - 12/15
	W	8:10-11:00am	B-24		
5666	MW	11:10-12:30pm	B-7	Dixon, D	8/11 - 12/15
	W	1:10-4:00pm	B-24		
4206	TTH	11:10-12:30pm	B-2	Krolikowski, K	8/11 - 12/15
	T	1:10-4:00pm	B-24		
		Section 4206 emphasizes the relationship between biology topics and food. The lab includes community-based work and a number of field trips.			
5664	TTH	11:10-12:30pm	B-8	Ponomareff, G	8/11 - 12/15
	TH	1:10-4:00pm	B-24		
5665	W	4:10-7:00pm	B-8	Krolikowski, K	8/11 - 12/15
	M	4:40-7:30pm	B-24		
		Section 5665 emphasizes applications of biology in diagnostics, agriculture, and drug development. The lab includes hands-on use of biotechnology equipment.			
5668	M	6:10-9:00pm	B-12	Muick, P	8/11 - 12/15
	T	6:10-9:00pm	B-24		
5667	M	6:10-9:00pm	B-12	Muick, P	8/11 - 12/15
	W	6:10-9:00pm	B-24		

**BIOSC-119 Microbiology - (LR) - 4 Units**

**Prerequisite:** Either BIOSC-172L or BIOSC-106 and either BIOSC-110 or CHEM-119 or BIOSC-172 and BIOSC-172L.

1348	TTH	9:10-10:30am	B-8	Dixon, D	8/11 - 12/15
	TTH	10:40-12:00pm	B-21		
4209	TTH	2:10-3:30pm	B-21	Dixon, D	8/11 - 12/15
	TTH	3:40-5:00pm	B-8		
4210	TTH	6:10-7:30pm	B-8	Rowning, B	8/11 - 12/15
	TTH	7:40-9:00pm	B-21		

sec	days	hrs	rm	instr	dates
<b>BIOSC-132 Human Anatomy - (LR) - 4 Units</b>					
4207	MW	11:10-12:30pm	B-2	Ng, K	8/11 - 12/15
	M	1:10-4:00pm	B-39		
4216	MW	11:10-12:30pm	B-12	Coatney, E	8/11 - 12/15
	W	1:10-4:00pm	B-39		
1100	MW	12:40-2:00pm	B-12	Meltzer, M	8/11 - 12/15
	M	9:40-12:30pm	B-39		
4215	MW	12:40-2:00pm	B-12	Meltzer, M	8/11 - 12/15
	W	9:40-12:30pm	B-39		
4220	M	5:10-8:00pm	B-2	Barnes, D	8/11 - 12/15
	W	5:10-8:00pm	B-39		
4217	W	5:10-8:00pm	B-7	Fouladian Tabriz, N	8/11 - 12/15
	M	5:10-8:00pm	B-39		

#### BIOSC-134 Human Physiology - (LR) - 4 Units

**Prerequisite:** BIOSC-106 and either BIOSC-110 or CHEM-119

4239	T	9:40-12:30pm	B-7	Coatney, E	8/11 - 12/15
	TH	9:40-12:30pm	B-39		
4222	T	1:10-4:00pm	B-12	Meltzer, M	8/11 - 12/15
	TH	1:10-4:00pm	B-39		
4223	TH	1:10-4:00pm	B-12	TieberNielson, L	8/11 - 12/15
	T	1:10-4:00pm	B-39		
6253	T	6:10-9:00pm	B-7	Chan, L	8/11 - 12/15
	TH	6:10-9:00pm	B-39		

#### BIOSC-147 Cell and Molecular Biology - (LR) - 4 Units

**Prerequisite:** BIOSC-106, MATH-120 and CHEM-120

1361	MW	9:40-11:00am	B-7	Krolkowski, K	8/11 - 12/15
	F	9:40-12:30pm	B-18		

BIOSC-147: Students who choose to meet the CHEM-120 prerequisite by taking the course concurrently must register for BIOSC-147 in person at the Admissions and Records office.

#### BIOSC-160 Nutrition - (LR) - 3 Units

2753	W	6:10-9:00pm	B-12	Chan, L	8/11 - 12/15
------	---	-------------	------	---------	--------------

#### BIOSC-172 Introduction to Biotechnology - (LR) - 3 Units

6507	W	4:10-7:00pm	B-8	Krolkowski, K	8/11 - 12/15
------	---	-------------	-----	---------------	--------------

Section 6507 emphasizes applications of biology in diagnostics, agriculture, and drug development. The lab includes hands-on use of biotechnology equipment.

#### BIOSC-172L Introduction to Biotechnology Lab - (LR) - 1 Unit

**Prerequisite:** BIOSC-172 (may be taken concurrently) **Advisory:** MATH-118, ENGL-142, COUNS-103A

6510	M	4:40-7:30pm	B-24	Krolkowski, K	8/11 - 12/15
------	---	-------------	------	---------------	--------------

Section 6510 emphasizes applications of biology in diagnostics, agriculture, and drug development. The lab includes hands-on use of biotechnology equipment.

#### BIOSC-300 Field Studies - (SC) - .5-2 Units

3001	TH	2:40-7:10pm	B-18	Krolkowski, K	8/31 - 12/14
------	----	-------------	------	---------------	--------------

This section is for the core lab team of the soil micro biome project. Students must have completed a prior biotechnology course to participate. Please contact Dr. Krolkowski to enroll at [kkrolkowski@contracosta.edu](mailto:kkrolkowski@contracosta.edu).

#### Short Term/Late Start

3004	W	12:40-2:10pm	B-18	Krolkowski, K	8/30 - 12/13
------	---	--------------	------	---------------	--------------

This section is for the field team of the soil micro biome project with Urban Tilth. Please contact Dr. Krolkowski to enroll, [kkrolkowski@contracosta.edu](mailto:kkrolkowski@contracosta.edu).

sec	days	hrs	rm	instr	dates
<b>Business</b>					

#### BUS-109 Introduction to Business - (SC) - 3 Units

0816	MW	9:40-11:00am	CTC-112	DeTorres, J	8/11 - 12/15
3294	TTH	9:40-11:00am	M-110	Staff, C	8/11 - 12/15
3296	MW	11:10-12:30pm	AA-205	Staff, C	8/11 - 12/15
3291	TTH	11:10-12:30pm	GE-108	DeTorres, J	8/11 - 12/15
3293	M	6:10-9:00pm	CTC-112	DeTorres, J	8/11 - 12/15

#### BUS-120 Introduction to Management - (LR) - 3 Units

4120	MW	9:40-11:00am	B-12	Staff, C	8/11 - 12/15
4122	TTH	11:10-12:30pm	A-2	Staff, C	8/11 - 12/15
1594	T	6:10-9:00pm	CTC-112	DeTorres, J	8/11 - 12/15

#### BUS-186 Principles of Accounting I - (LR) - 4 Units

3321	MW	12:40-2:30pm	AA-135	Staff, C	8/11 - 12/15
1360	T	6:10-10:00pm	B-12	Yamamoto, T	8/11 - 12/15
3320	MW	6:40-8:30pm	AA-145	Yamamoto, T	8/11 - 12/15

#### Online and Partially Online Sections

1727			PART-ONL	Viertel, C	8/11 - 12/15
	F	4:10-6:00pm	CTC-112		

Section 1727 is offered in a partially online format with mandatory meetings on Fridays: 8/18, 9/15, 10/13, 11, 12/8, and 12/15 from 4:10-6:00pm in AA-135. Students must check their college email prior to orientation for course instructions and materials. For information contact [cviertel@contracosta.edu](mailto:cviertel@contracosta.edu)

#### BUS-187 Principles of Accounting II - (LR) - 4 Units

**Prerequisite:** BUS 186 with a grade of "C" or better.

#### Online and Partially Online Sections

1728			PART-ONL	Viertel, C	8/11 - 12/15
	F	6:10-8:00pm	CTC-112		

Section 1728 is offered in a partially online format with mandatory meetings on Fridays: 8/18, 9/15, 10/13, 11, 12/8, and 12/15 from 6:10pm to 8:00pm in HS101. Students must check their college email prior to orientation for course instructions and materials. For information contact [cviertel@contracosta.edu](mailto:cviertel@contracosta.edu).

#### BUS-294 Business Law - (SC) - 3 Units

4297	TTH	9:40-11:00am	GE-104	DeTorres, J	8/11 - 12/15
------	-----	--------------	--------	-------------	--------------

### Business Office Technologies

#### BOT-200 Basic Keyboarding - (LR) - 1 Unit

##### Short Term/Late Start

1579	TTH	11:40-1:30pm	CTC-131	Rudy, P	8/15 - 10/12
------	-----	--------------	---------	---------	--------------

#### BOT-210A Keyboard Skills Through Word Processing - (SC) - 2 Units

1580	MW	8:10-9:30am	CTC-131	Rudy, P	8/11 - 12/15
6069	TTH	8:10-9:30am	CTC-131	Rudy, P	8/11 - 12/15
6073	MW	9:40-11:00am	CTC-131	Rudy, P	8/11 - 12/15

#### BOT-224 Microsoft Excel for Business - (SC) - 3.5 Units

**Prerequisite:** CIS-135 with a minimum grade of "C"

2240	TTH	11:10-12:30pm	CTC-114	Staff, C	8/11 - 12/15
	TTH	12:30-1:30pm	CTC-128		

#### BOT-226 Microsoft Access for Business - (SC) - 3.5 Units

**Prerequisite:** CIS-135 with a minimum grade of "C"

1226	MW	11:10-1:30pm	CTC-131	Rudy, P	8/11 - 12/15
------	----	--------------	---------	---------	--------------

sec	days	hrs	rm	instr	dates
BOT-243	General Office Procedures - (SC) - 3 Units				
2243	TTH	9:40-11:00am	CTC-131	Rudy, P	8/11 - 12/15

## Chemistry

### CHEM-119 Introductory Chemistry - (SC) - 4 Units

**Prerequisite:** MATH-118

2116	MW	11:10-12:30pm	PS-106	Dang, T	8/11 - 12/15
	M	1:10-4:00pm	PS-14		
2120	MW	11:10-12:30pm	PS-106	Dang, T	8/11 - 12/15
	W	1:10-4:00pm	PS-14		
2117	TTH	11:10-12:30pm	PS-106	Becraft, K	8/11 - 12/15
	T	2:10-5:00pm	PS-14		
2119	TTH	11:10-12:30pm	PS-106	Becraft, K	8/11 - 12/15
	TH	2:10-5:00pm	PS-14		
2118	M	7:10-10:00pm	PS-106	Staff, C	8/11 - 12/15
	W	7:10-10:00pm	PS-14		

#### Online and Partially Online Sections

2124			PART-ONL	Dang, T	8/11 - 12/15
	S	9:10-1:00pm	PS-14		
	S	1:10-4:00pm	PS-106		

Section 2124 is offered in a partially online format with mandatory meetings on the following Saturdays: 8/12, 09/23, 10/28, and 12/9 from 9:10 to 4:00pm in PS-14 and PS-106.

### CHEM-120 General College Chemistry I - (SC) - 5 Units

**Prerequisite:** MATH-120 or equivalent (Intermediate Algebra). **Advisory:** High school science preparation including a course in chemistry with a laboratory (equivalent to CHEM 119). The ability to read and write at the ENGL 142B level. A diagnostic exam may be given to assist the student in determining whether or not she has adequate preparation for the course.

1494	TTH	8:10-9:30am	PS-106	Staff, C	8/11 - 12/15
	TTH	9:40-12:30pm	PS-6		
1488	MW	1:10-2:30pm	PS-106	Sidharta, S	8/11 - 12/15
	MW	2:40-5:30pm	PS-6		
1493	MW	5:40-7:00pm	PS-106	Kim, H	8/11 - 12/15
	MW	7:10-10:00pm	PS-6		

### CHEM-121 General College Chemistry II - (SC) - 5 Units

**Prerequisite:** CHEM 120 or equivalent.

5956	MW	9:40-11:00am	PS-106	Michaely, W	8/11 - 12/15
	MW	2:10-5:00pm	PS-5		

### CHEM-226 Organic Chemistry I - (SC) - 5 Units

**Prerequisite:** CHEM-120 or equivalent **Advisory:** ENGL-142B

1504	TTH	12:40-2:00pm	PS-106	Alexander, L	8/11 - 12/15
	T	2:10-8:00pm	PS-6		
1525	TTH	12:40-2:00pm	PS-106	Alexander, L	8/11 - 12/15
	TH	2:10-8:00pm	PS-6		

## Chinese

### CHIN-120 First-Semester Mandarin - (SC) - 5 Units

#### Online and Partially Online Sections

1234			PART-ONL	Teng, Y	8/11 - 12/15
	TH	11:10-1:30pm	HS-101		

Section 1234 is offered in a partially online format with mandatory meetings on Thursdays 11:10-1:30pm in HS-101. For more information contact Prof. Teng at yteng@contracosta.edu.

sec	days	hrs	rm	instr	dates
CHIN-121 Second-Semester Mandarin - (SC) - 5 Units					
Advisory: Chinese 120.					
Online and Partially Online Sections					
1090			PART-ONL	Teng, Y	8/11 - 12/15
	TH	11:10-1:30pm	HS-101		

Section 1090 is offered in a partially online format with mandatory meetings on Thursdays 11:10-1:30pm in HS-101. For more information contact Prof. Teng at yteng@contracosta.edu

## Computer Information Systems

### CIS-110 Fundamental Computer Literacy - (SC) - 2 Units

3110	MW	1:10-4:15pm	CTC-132	Hunt, J	8/21 - 10/18
------	----	-------------	---------	---------	--------------

Section 3110 requires permission to enroll and is primarily for TAA students. Please contact Evan Decker at edecker@contracosta.edu

### CIS-125 Computer Logic Concepts - (SC) - 3 Units

2125	MW	2:10-3:30pm	CTC-128	Chan, R	8/11 - 12/15
------	----	-------------	---------	---------	--------------

### CIS-135 Introduction to Computers - (SC) - 4 Units

**Corequisite:** CIS-095A, B, C, or D.

2555	TTH	8:10-9:30am	CTC-114	Chan, R	8/11 - 12/15
	TTH	9:40-11:00am	CTC-128		
2543	MW	9:40-11:00am	CTC-114	Watkins, R	8/11 - 12/15
	MW	11:10-12:30pm	CTC-128		
2553	MW	2:10-3:30pm	CTC-114	Staff, C	8/11 - 12/15
	MW	3:40-5:00pm	CTC-128		
1683	TTH	2:10-3:30pm	CTC-112	Staff, C	8/11 - 12/15
		3:30-5:00pm	CTC-131		

### CIS-166A Basic Web Page Development - (SC) - 1.75 Units

4166	MTTH	8:20-9:40am	DEANZAHS	Staff, C	8/11 - 12/15
------	------	-------------	----------	----------	--------------

Section 4166 is a dual enrollment course for students in the ITA Academy at De Anza High School.

4167	W	10:00-11:10am	KENNEDYH	Staff, C	8/11 - 12/15
------	---	---------------	----------	----------	--------------

Section 4167 is a dual enrollment course for students in the ITA Academy at Kennedy High School.

#### Short Term/Late Start

1666	TTH	11:10-1:30pm	CTC-127	Watkins, R	8/15 - 10/12
------	-----	--------------	---------	------------	--------------

### CIS-166B Advanced Web Page Development - (SC) - 1.75 Units

**Prerequisite:** CIS-166A

#### Short Term/Late Start

2166	TTH	11:10-1:35pm	CTC-127	Watkins, R	10 - 12/14
------	-----	--------------	---------	------------	------------

### CIS-190B Windows Fundamentals - (SC) - 1.5 Units

#### Short Term/Late Start

0190	MW	9:30-11:00am	CTC-127	Chan, R	10/16 - 12/13
		8:40-9:30am			

## Computer Science

### COMP-110 Introduction to Computational Science - (LR) - 2 Units

**Advisory:** MATH-171

4110	TTH	8:10-9:30AM	PS-107	Staff, C	8/11 - 12/15
------	-----	-------------	--------	----------	--------------

### COMP-251 Fundamentals of Computer Science C++ - (LR) - 4 Units

**Advisory:** MATH-171

4251	TTH	12:10-3:00PM	PS-107	Staff, C	8/11 - 12/15
------	-----	--------------	--------	----------	--------------



sec	days	hrs	rm	instr	dates
<b>Cooperative Education</b>					

#### COOP-160 General Work Experience Education - (LR) - 1-3 Units

1340 Baatin, A 8/11 - 12/15

Cooperative education (1-3 units) provides the opportunity for students to earn college credit for paid or volunteer experience. This course is designed to assist students whose employment or volunteer position does not relate to their college major or career goals. In collaboration with the college instructor and work site supervisor, the students set measurable goals to enhance on-the-job training. IMPORTANT: All registered students must attend mandatory orientation on Monday August 14 from 5:30-7:30pm in CCC Library Skills Center (LLRC 107). Please fill out and print the Coop Application, Documentation Log, and Learning Agreement ([www.contracosta.edu/coop](http://www.contracosta.edu/coop)) to submit during orientation. Incomplete forms without the site supervisor's signature will not be accepted. For questions, email [abaatin@contracosta.edu](mailto:abaatin@contracosta.edu).

#### COOP-170 Occupational Work Experience Education - (LR) - 1-4 Units

1342 Templeton, E 8/11 - 12/15

Cooperative Education (2-3 units) is a supervised work experience course designed to assist students in coordinating classroom studies with related experiences in business, industry or public service whether as a paid employee or a community volunteer. The program involves students, faculty, and community employers working together to enhance learning in the students' jobs. This Cooperative Education course is for students working or volunteering in jobs related to their major and/or career goals. IMPORTANT: mandatory orientation date and time to participate in this course is TO BE DETERMINED. Please fill out and print the Coop Application, Log, and Learning Agreement ([www.contracosta.edu/coop](http://www.contracosta.edu/coop)) to submit during orientation and to complete your registration for the course. Forms without site supervisor signatures will not be accepted. For questions, email [etempleton@contracosta.edu](mailto:etempleton@contracosta.edu)

1647 Baatin, A 8/11 - 12/15

Cooperative education (1-4 units) provides the opportunity for students to earn college credit for paid or volunteer experience. This course is designed to assist students whose employment or volunteer position relates to their college major or career goals. In collaboration with the college instructor and work site supervisor, the students set measurable goals to enhance on-the-job training. IMPORTANT: All registered students must attend mandatory orientation on Monday August 14, 2017 from 5:30pm-7:30pm in CCC Library Skills Center (LLRC 107). Please fill out and print the Coop Application, Documentation Log, and Learning Agreement (website <http://www.contracosta.edu/programs-departments/cooperative-education/>) to submit during orientation. Incomplete forms without the site supervisor's signature will not be accepted. For questions, email [abaatin@contracosta.edu](mailto:abaatin@contracosta.edu).

### Counseling

#### COUNS-103A Personal Development for College Success - (SC) - 1.5 Units

1052 T 11:10-12:30pm HS-3 Valdez-Jimenez, N 8/11 - 12/15

Section 1052 is part of the Puente Project. Students must also be enrolled in ENGL 142B-5990 (linked course) and attend an orientation to register for classes and join the Puente Project. For more information contact Norma Valdez-Jimenez at [nvaldez-jimenez@contracosta.edu](mailto:nvaldez-jimenez@contracosta.edu).

#### COUNS-103B Ensuring Transfer Success - (LR) - 1.5 Units

##### Short Term/Late Start

1057 T 2:10-6:30pm GE-310 Phillips, A 10/10 - 11/14

This course focuses on college admissions preparations: Scholarships, personal statements, university applications, and access to college tours. Meet university representatives from UC, CSU and private school.

sec	days	hrs	rm	instr	dates
-----	------	-----	----	-------	-------

#### COUNS-108 Introduction to Educational Planning - (P/NP) - .2 Unit

##### Short Term/Late Start

NOTE: All of these courses are intended for new students. Please complete the online orientation and the Math and English assessments prior to the first class meeting. Bring a printout of assessment results and high school transcripts, if applicable.

1750	M	9:10-1:00pm	L-107	Lockett, N	8/14 - 8/14
1753	M	1:10-5:00pm	CTC-127	Zambrano, M	8/14 - 8/14
1755	M	4:10-8:00pm	CTC-131	Moncada, L	8/14 - 8/14
1763	T	9:10-1:00pm	L-107	Zambrano, M	8/15 - 8/15
1764	T	3:10-7:00pm	CTC-127	Skoler, J	8/15 - 8/15
1765	F	9:10-1:00pm	CTC-127	Perez, D	8/18 - 8/18
2671	F	9:10-1:00pm	SSC-104	Gorman, R	10/6 - 10/6
2668	M	8:20-12:20pm	HERCHS	Galindo, M	11/6 - 11/6
2123	T	8:20-12:20pm	RICHMHS	Oseguera, A	11/7 - 11/7
2670	TH	8:10-12:10pm	PINOLEHS	Galindo, M	11/9 - 11/9
2625	TH	8:15-12:15pm	ELCERHS	Oseguera, A	11/9 - 11/9
2667	TH	8:20-12:20pm	DEANZHS	Perez, G	11/9 - 11/9
2621	F	8:20-12:20pm	KENNEDYH	Perez, G	11 - 11
2673	F	9:10-1:00pm	SSC-104	Castruita, L	11 - 11
2675	F	9:10-1:00pm	SSC-104	Gorman, R	12/1 - 12/1
2682	F	9:10-1:00pm	SSC-104	Huey, S	12/8 - 12/8

##### Weekend

2122	S	9:10-1:00pm	SSC-104	Lockett, N	8/19 - 8/19
2674	S	9:10-1:00pm	SSC-104	Skoler, J	11/18 - 11/18
2679	S	9:10-1:00pm	SSC-104	Webster, R	12/2 - 12/2
2686	S	9:10-1:00pm	SSC-104	Perez, D	12/9 - 12/9

##### Study Abroad

2672	S	9:10-1:00pm	SSC-104	Azizi, N	10/28 - 10/28
------	---	-------------	---------	----------	---------------

#### Online and Partially Online Sections

1714 ONLINE Boland Drain, S 8/14 - 8/21

Section 1714 is an Online course. All instruction will be online. This course is intended for new students. Please complete Math and English assessments prior to the first class meeting. Send a printout of assessment results and high school transcripts, if applicable.

2681 ONLINE Boland Drain, S 12/1 - 12/8

Section 2681 is an online course. All instruction will be online. This course is intended for new students. Please complete the online orientation and the Math and English assessments prior to the first class meeting. Bring a printout of assessment results and high school transcripts, if applicable.

#### COUNS-120 Managing College Success and Life Transitions - (SC) - 3 Units

1413 MW 11:10-12:30pm GE-108 Perez, D 8/11 - 12/15

Section 1413 is designated for EOPS students, but is open to all. For more information, contact Dionne Perez at [dperez@contracosta.edu](mailto:dperez@contracosta.edu).

1034 TTH 11:10-12:30pm CTC-112 Azizi, N 8/11 - 12/15

2889 TTH 12:40-2:00pm GE-314 Moncada, L 8/11 - 12/15

#### Online and Partially Online Sections

1710 ONLINE Perez, D 8/11 - 12/15

Section 1710 is offered in a fully online format. All instruction will be online. The instructor will send you a college email prior to the start of the course with information. Students may contact their instructor at [dperez@contracosta.edu](mailto:dperez@contracosta.edu).

#### COUNS-130 Career and Major Exploration - (SC) - 1.5 Units

##### Short Term/Late Start

1330 MW 9:10-10:20am B-8 Boland Drain, S 10/9 - 12/13

#### COUNS-140 Job Search Strategies - (SC) - 1.5 Units

##### Online and Partially Online Sections

4440 ONLINE Boland Drain, S 10/9 - 12/13

Section 4440 is an online course. All instruction will be online. You will receive a college email prior to the class. Students may contact their instructor at [sboland@contracosta.edu](mailto:sboland@contracosta.edu).

sec	days	hrs	rm	instr	dates
<b>COUNS-805N Building Pre-Collegiate Skills-Level I - (P/NP) - J</b>					
<b>Weekend</b>					
0251	S	10:10-2:00pm	AA-131	Lopez, R	8/26 - 12/9
Section 0251 is part of the Metas program and meets on 8/26, 9/9, 9/23, 10/7, 10/21, 11/4, 11/18, 12/2, 12/9.					
0280	S	10:10-2:00pm	AA-113	Shumate, S	8/26 - 12/9
Section 0280 is part of the Metas program and meets on 8/26, 9/9, 9/23, 10/7, 10/21, 11/4, 11/18, 12/2, 12/9.					
0855	S	10:10-2:00pm	AA-133	Alva, G	8/26 - 12/9
Section 0855 is part of the Metas program and meets on 8/26, 9/9, 9/23, 10/7, 10/21, 11/4, 11/18, 12/2, 12/9.					
1743	S	10:10-2:00pm	AA-145	Hernandez, V	8/26 - 12/9
Section 1743 is part of the Metas program and meets on 8/26, 9/9, 9/23, 10/7, 10/21, 11/4, 11/18, 12/2, 12/9.					

<b>COUNS-806N Building Pre-Collegiate Skills-Level II - (P/NP) - 0 Unit</b>					
<b>Weekend</b>					
0791	S	10:10-2:00pm	AA-103	Villafane, A	8/26 - 12/9
Section 0791 is part of the Metas program and meets on 8/26, 9/9, 9/23, 10/7, 10/21, 11/4, 11/18, 12/2, 12/9.					
0858	S	10:10-2:00pm	AA-137	Oseguera, A	8/26 - 12/9
Section 0858 is part of the Metas program and meets on 8/26, 9/9, 9/23, 10/7, 10/21, 11/4, 11/18, 12/2, 12/9.					

## Culinary Arts

<b>CULIN-095A Culinary Arts Laboratory - (P/NP) - 1 Unit</b>	
6308	SAB-130 Sharkes, N 8/11 - 12/15
Section 6308 is open-entry/open-exit.	

<b>CULIN-095B Culinary Arts Laboratory - (P/NP) - 1 Unit</b>	
6309	SAB-130 Sharkes, N 8/11 - 12/15
Section 6309 is open-entry/open-exit.	

<b>CULIN-095C Culinary Arts Laboratory - (P/NP) - 1 Unit</b>	
2359	SAB-130 Sharkes, N 8/11 - 12/15
Section 2359 is open-entry/open-exit.	

<b>CULIN-095D Culinary Arts Laboratory - (P/NP) - 1 Unit</b>	
2365	SAB-130 Sharkes, N 8/11 - 12/15
Section 2365 is open-entry/open-exit.	

<b>CULIN-099 Occupational Work Experience - (LR) - 1-4 Units</b>	
3252	SAB-130 Sharkes, N 8/11 - 12/15

<b>CULIN-120 Introduction to Fundamentals in Food Service - (LR) - 9 Units</b>	
<b>Corequisite:</b> CULIN-127 and CULIN-095	
3257	TWTH 9:00-2:10pm SAB-130 Schwarz, E 8/11 - 12/15
	F 8:40-2:10pm

<b>CULIN-127 Becoming ServSafe Certified - (LR) - 3 Units</b>	
2224	W 4:10-7:00pm SAB-130 Schwarz, E 8/11 - 12/15

sec	days	hrs	rm	instr	dates
<b>CULIN-130 Introduction to Commercial Baking - (LR) - 9 Units</b>					
<b>Corequisite:</b> CULIN-095 <b>Advisory:</b> CULIN-120 recommended					
2435	TWTHF	7:10-1:00pm	SAB-145	Legas, C	8/11 - 12/15
Section 2435 requires students to provide medical documentation of a negative tuberculosis test.					

<b>CULIN-131 Introduction to Pastry Product Preparation - (LR) - 9 Units</b>					
<b>Corequisite:</b> CULIN-95 <b>Advisory:</b> CULIN-120 recommended					
2436	TWTHF	7:10-1:00pm	SAB-145	Murakami, Y	8/11 - 12/15
Section 2436 requires students to provide medical documentation of a negative tuberculosis test.					

<b>CULIN-200 California Cuisine - (P/NP) - 3 Units</b>	
1368	T 4:10-7:00pm SAB-130 Sharkes, N 8/11 - 12/15

<b>CULIN-230 Commercial Baking - (LR) - 9 Units</b>	
<b>Prerequisite:</b> CULIN-120	
<b>Corequisite:</b> CULIN-095	
2736	TWTHF 7:10-1:00pm SAB-145 Legas, C 8/11 - 12/15
Section 2736 requires students to provide medical documentation of a negative tuberculosis test.	

<b>CULIN-231 Cake Finishing and Restaurant Desserts - (LR) - 9 Units</b>	
<b>Prerequisite:</b> CULIN-120 <b>Corequisite:</b> CULIN-095A, B, C, or D.	
3269	TWTHF 7:10-1:00pm SAB-145 Murakami, Y 8/11 - 12/15
Section 3269 requires students to provide medical documentation of a negative tuberculosis test.	

<b>CULIN-241A Introduction to Classical and Modern Food Preparation - (LR) - 8 Units</b>	
<b>Prerequisite:</b> CULIN-120	
<b>Corequisite:</b> CULIN-095A-D	
3270	MTWTH 9:10-3:00pm SAB-136 Sharkes, N 8/11 - 12/15

<b>CULIN-241B Advanced Classical and Modern Food Preparation - (LR) - 8 Units</b>	
<b>Prerequisite:</b> CULIN-241A <b>Corequisite:</b> CULIN-095A, B, C, or D.	
3271	MTWTH 9:10-3:00pm SAB-136 Sharkes, N 8/11 - 12/15

<b>CULIN-250 International Cuisine - (P/NP) - 1.5 Units</b>	
1366	TH 4:10-7:00pm SAB-130 Sharkes, N 8/11 - 12/15

<b>CULIN-280 Applied Math for Food Service - (P/NP) - 3 Units</b>	
4288	F 4:10-7:00pm BARESCUE Goodman, G 8/11 - 12/15
Section 4288 meets off campus at the Bay Area Rescue Mission, 200 MacDonald Ave, Richmond.	

## Dance

<b>DANCE-101 Introduction to Dance - (SC) - 3 Units</b>	
<b>Online and Partially Online Sections</b>	
1497	PART-ONL Tigner, L 10/13 - 12/15
	F 12:10-2:00PM
Section 1497 is offered in a partially online format with a mandatory meeting Friday, October13, 12:10-2pm in B-12. Students must email instructor after registering at ltigner@contracosta.edu. Students must also check their College email prior to the orientation for course information and materials required.	

sec	days	hrs	rm	instr	dates
DANCE-118A	Beginning Techniques of Hip Hop and Urban Funk - (LR) - 1 Unit				
1583	TTH	12:40-2:30pm	GA-10	Tigner, L	9/5 - 12/14
DANCE-161A	Beginning Ballroom Dance - (LR) - 1 Unit				
Weekend					
3241	S	10:10-1:00pm	GA-10	Clarke, N	8/11 - 12/15
DANCE-161B	Intermediate Ballroom Dance - (LR) - 1 Unit				
Prerequisite:	Dance 161A with a "C" or better				
Weekend					
5073	S	10:10-1:00pm	GA-10	Clarke, N	8/11 - 12/15
DANCE-163A	Beginning Latin Social Dance - (LR) - .5 Unit				
Short Term/Late Start					
1692	W	6:40-8:30pm	GA-10	Clarke, N	9/13 - 12/13

## Drama

<b>DRAMA-101 Introduction to Theatre - (SC) - 3 Units</b>						
<b>Advisory:</b> Eligibility for ENGL-001A or equivalent						
0720	TTH	9:40-11:00am	HS-101	LaBarre, A	8/11 - 12/15	
0726	MW	10:10-11:30am	M-104	Chavarria, C	8/11 - 12/15	
0728	TTH	12:10-1:30pm	PS-113	Blau, T	8/11 - 12/15	
<b>Online and Partially Online Sections</b>						
0735			ONLINE	Chavarria, C	8/28 - 12/15	
Section 0735 is offered in an online format. You will receive a college email prior to the class. For information contact <a href="mailto:cchavarria@contracosta.edu">cchavarria@contracosta.edu</a> .						

<b>DRAMA-103</b>					<b>Hist of Theatre: Pre-Greek-17th Century - (SC) - 3 Units</b>				
<b>Advisory:</b> Eligibility for ENGL-001A or equivalent									
<b>Online and Partially Online Sections</b>									
3103				ONLINE		Chavarria, C		8/11 - 12/15	
Section 3103 is offered in an online format. You will receive a college email prior to the class. For information contact <a href="mailto:cchavarria@contracosta.edu">cchavarria@contracosta.edu</a> .									

<b>DRAMA-106</b>	<b>Technical Theatre/Stagecraft - (SC) - 3 Units</b>				
0708		Hours by arr	PAC-100	Hiner, T	8/11 - 12/15
Students enrolled in section 0708 must complete a total of 162 hours. The class meets Tuesdays and Thursdays, 9:40-11am (54 hours) and 4:10-6pm (72 hours). Students will complete an additional 36 hours by arrangement during Drama Department production weeks. The first class meeting is on Tuesday, 8/15 at 9:40am. For more information, contact Travis Hiner at (510) 215-4952 or at thiner@contracosta.edu.					

<b>DRAMA-110</b>	<b>African American Theatre - (SC) - 3 Units</b>				
1062	MW	2:10-3:30pm	GE-312	Ivory, T	8/11 - 12/15
This class is a part of the AFRAM Studies program.					

<b>DRAMA-122</b>	<b>Acting I - (SC) - 3 Units</b>				
0734	TTH	12:40-2:00pm	PAC-100	McCarty, K	8/11 - 12/15
1065	MW	3:10-4:30pm	PAC-100	Jackson-Whitmore, L	8/11 - 12/15
Section 1065 requires Instructor permission to enroll.					

<b>DRAMA-123    Acting II - (SC) - 3 Units</b>					
<b>Advisory:</b> DRAMA 122 or equivalent					
1066	TTH	12:40-2:00pm	PAC-100	McCarty, K	8/11 - 12/15

sec	days	hrs	rm	instr	dates
<b>DRAMA-220</b>	<b>Theatre Practice - (SC) - 1 Unit</b>				
1730			PAC-100	Labarre, A	8/11 - 12/15
<b>Note:</b> Students may register for 1-4 units. It is recommended that students register for 1 unit. This course is open-entry/open-exit and will conclude in October with a main stage production. Students must audition to be in this course and it requires Instructor's permission to enroll. For audition information, please contact the director, Angelina Labarre at alabarre@contracosta.edu.					
1731			PAC-100	Blau, T	8/11 - 12/15
<b>Note:</b> Students may register for 1-4 units. It is recommended that students register for 1 unit. This course is open-entry/open-exit and will conclude in November with a main stage production. Students must audition to be in this course and it requires Instructor's permission to enroll. For audition information, please contact the director, Tara Blau, at tblau@contracosta.edu.					

## Early Childhood Education

<b>ECHD-095B</b>	<b>Foster Parent Skills Laboratory - (P/NP) - .04-3 Units</b>				
<b>Weekend</b>					
3236	S	9:10-5:00pm	GE-111	Shareef, I	11/18 - 11/18
Section 3236 requires instructor consent to enroll. This is a CPR and first aide workshop for adult & child. Must be registered through Glenda Roberts at groberts@contracosta.edu.					

<b>ECHD-095D</b>	<b>Foster Parent Skills Laboratory - (P/NP) - .04-3 Units</b>				
<b>Weekend</b>					
1148	S	9:10-4:00pm	GE-111	Shareef, I	10/21 - 11/11
Sections 1148 meets on 10/21, 10/28, 11/04, and 11/11.					

<b>ECHD-095E</b>	<b>Foster Parent Skills Laboratory - (P/NP) - .04-3 Units</b>				
<b>Weekend</b>					
3363	S	9:10-3:30pm	GE-111	Shareef, I	9/9 - 10/14
Section 3363 is offered for 1 unit. Class meets on 9/9, 9/16, 9/23, 9/30, 10/7, and 10/14. For more information please contact Intisar Shareef at lshareef@contracosta.edu.					

<b>ECHD-099</b>	<b>Occupational Work Experience - (LR) - 1-4 Units</b>				
<b>Corequisite:</b> Employment in career-related field.					
<b>Short Term/Late Start</b>					
3171	Staff, C	8/30 - 12/15			
Section 3171 has a mandatory orientation meeting Wednesday, 8/30 from 5-6pm in the Library Student Lab. Must complete documentation in Canvas before attending orientation.					

<b>ECHD-101E</b>	<b>Workshops in Early Childhood Education - E - (P/NP) - .17-1 unit</b>				
<b>Weekend</b>					
6350	S	9:10-12:00pm	GE-113	Thomas, O	8/26 - 12/2
Section 6350 is a workshop: Meeting dates 8/26, 9/9, 9/30, 10/14, 11/11 and 12/2. ECERS Training. ECHD 101E is strongly advised for students who anticipate enrolling in ECHD 290 in the Spring Term 2018.					

<b>ECHD-109</b>	<b>Observation, Assessment, and Child Guidance - (LR) - 3 Units</b>				
3214	M	6:10-9:00pm	ELC-103	Marshall-Thomas, D	8/11 - 12/15

sec	days	hrs	rm	instr	dates
<b>ECHD-120 Introduction to Principles &amp; Practices Of Early Childhood Education (LR) - 3 Units</b>					
1110	T	7:10-10:00pm	GE-112	Porter, T	8/11 - 12/15
<b>Online and Partially Online Sections</b>					
6999			PART-ONL	Moore, S	8/11 - 12/15
	W	1:10-4:00pm	GE-113		
Section 6999 is offered in a partially online format with mandatory meetings on Wednesdays: 8/30, 9/20, 10/18, 11/15, and 12/6 from 1:10-4:00pm in GE-113. Students will receive a college email prior to the first day regarding how the course works. Students may contact their instructor via email at smooore@contracosta.edu.					
<b>ECHD-121 Child Growth &amp; Development (DS1) - (LR) - 3 Units</b>					
3217	T	1:10-4:00pm	GE-111	Moore, S	8/11 - 12/15
1370	T	5:10-8:00pm	GE-311	Moore, S	8/11 - 12/15
<b>ECHD-123 Creative Activities (DS3) - (SC) - 3 Units</b>					
0069	T	1:10-4:00pm	GE-113	Shareef, I	8/11 - 12/15
<b>ECHD-124 Curriculum Development - (LR) - 3 Units</b>					
3027	TH	7:10-10:00pm	GE-104	Benson, G	8/11 - 12/15
<b>ECHD-144 Teaching in a Diverse Society - (LR) - 3 Units</b>					
3229	TH	6:10-9:00pm	GE-113	Moore, S	8/11 - 12/15
<b>ECHD-146 School Age Curriculum - (LR) - 3 Units</b>					
<b>Advisory:</b> ECHD 145					
2146	M	7:10-10:00pm	GE-111	Porter, T	8/11 - 12/15
<b>ECHD-152 Care &amp; Education for Infants &amp; Toddlers - (LR) - 3 Units</b>					
<b>Weekend</b>					
4152	S	9:10-12:00pm	GE-108	Burton, A	8/11 - 12/15
<b>ECHD-161 Violence and Its Impact on Children and Families: An Early Childhood Education Counseling Perspective - (LR) - 3 Units</b>					
3231	T	6:40-9:30pm	GE-312	Shareef, I	8/11 - 12/15
<b>ECHD-220 The Child, Family and Community (DS2) - (LR) - 3 Units</b>					
3232	TH	2:10-5:00pm	GE-212	Moore, S	8/11 - 12/15
3233	M	7:10-10:00pm	GE-108	Smith-Miller, B	8/11 - 12/15
<b>ECHD-223 Administration and Management of Early Childhood Programs (DS6) - (SC) - 3 Units</b>					
3358	W	7:10-10:00pm	ELC-103	Naidoo, M	8/11 - 12/15
<b>ECHD-291 Adult Supervision in Early Childhood Classrooms - (SC) - 2 Units</b>					
<b>Advisory:</b> Before becoming a Mentor Teacher you must have completed a course of study in Early Childhood Education that included a supervised student teaching component.					
2145	W	6:10-8:00pm	GE-113	Moore, S	8/11 - 12/15
Section 2145 Students are advised to concurrently enroll in ECHD 101E.					

sec	days	hrs	rm	instr	dates
<b>ECHD-840N Parent Education - (P/NP) - 0 Unit</b>					
<b>Online and Partially Online Sections</b>					
2898			PART-ONL	Benson, G	9/8 - 11/3
	F	6:10-8:00pm	ELC-103		
Section 2898 is a non-credit course offered in a partially online format with a mandatory orientation meeting on Friday, 9/8, 6:10-8:00pm in ELC-103. This course is mandatory for all parents with children attending the Early Learning Center but is also open to anyone interested in parent education. Please email Gail Benson if you have questions at gbenson@contracosta.edu.					

<b>ECHD-875N Supervised Tutoring - (P/NP) - 0 Unit</b>					
4651				Shareef, I	8/11 - 12/15
Supervised tutoring will be held in GE-304. For more information, please contact Intisar Shareef at ishareef@contracosta.edu. This section is open-entry/open-exit.					

<b>ECHD-895N Foster Parent Skills - (P/NP) - 0 Unit</b>					
2897	M	9:30-11:30am	OC	Shareef, I	8/21 - 12/4
Section 2897 is a non credit course. Meeting location: 84 Broadway, Richmond. Meeting dates: 8/21, 9/11, 9/25, 10/9, 10/23, 11/13, 11/27, 12/4.					
2895	F	6:10-8:00pm	GE-113	Shareef, I	12/1 - 12/1
<b>Short Term/Late Start</b>					
2896	TH	6:10-9:00pm	OC	Shareef, I	8/31 - 12/14
Section 2896 is is a non credit course. Meeting location: Bethlehem Missionary Baptist Church, 684 Juliga Woods St., Richmond. Meetings 1st and 3rd Thursdays: 8/31, 9/14, 10/5, 10/19, 11/2, 11/16, 11/30, and 12/14.					

## Economics

<b>ECON-220 Introduction to Macroeconomic Principles - (SC) - 3 Units</b>					
<b>Prerequisite:</b> MATH-120					
0787	TTH	9:40-11:00am	AA-143	Morris, G	8/11 - 12/15
1646	MW	11:10-12:30pm	GE-104	Morris, G	8/11 - 12/15
0790	M	6:40-9:30pm	GE-110	Brinkley, G	8/11 - 12/15
<b>ECON-221 Introduction to Microeconomic Principles - (SC) - 3 Units</b>					
<b>Prerequisite:</b> MATH-120 <b>Advisory:</b> ECON-221 may be taken before ECON-220					
0793	TTH	11:10-12:30pm	B-12	Morris, G	8/11 - 12/15



sec	days	hrs	rm	instr	dates
<b>Emergency Medical Technician</b>					

#### EMED-107 Emr & Related Allied Health Occupations - (LR) - 4 Units

2174 M 4:40-9:30pm B-7 Medel, G 8/11 - 12/15

There is a fee of \$11.00 for the EMR and CPR cards, which will be issued upon successful completion of the course.

#### EMED-110 Emergency Medical Technician I - (LR) - 6 Units

**Prerequisite:** EMED-107, EMED-130, an American Science and Health Institute Emergency Medical Responder course, EMR card, or C or better on the Challenge Exam; and Current American Heart Association CPR card.

5658 TW 6:10-8:00pm B-2 Staff, C 8/11 - 12/15  
TH 6:10-10:00pm

Section 5658: Requirements for this course include uniform, equipment, drug testing, criminal history background, and medical testing including immunization and chest x-ray before you may participate in a clinical internship with a pre-hospital care provider. Associated costs may run from \$750 to as much as \$1000-\$1500, if you do not have a health care provider that will cover the medical testing costs. Students are required to have a healthcare provider CPR card prior to enrolling in class. An orientation will be held on Friday 7/28 and Thursday 8/4 from 6:00 to 7:30pm in B-2. Contact [sweatherby@contracosta.edu](mailto:sweatherby@contracosta.edu) for further information.

#### Weekend

1952 SSU 9:10-1:00pm B-2 Staff, C 8/11 - 12/15

Section 1952: Requirements for this course include uniform, equipment, drug testing, criminal history background, and medical testing including immunization and chest x-ray before you may participate in a clinical internship with a pre-hospital care provider. Associated costs may run from \$750 to as much as \$1000-\$1500, if you do not have a health care provider that will cover the medical testing costs. Students are required to have a healthcare provider CPR card prior to enrolling in class. An orientation will be held on Friday 7/28 and Thursday 8/4 from 6:00 to 7:30pm in B-2. Contact [sweatherby@contracosta.edu](mailto:sweatherby@contracosta.edu) for further information.

### Engineering and Engineering Technology

#### ENGIN-112 Introduction to Engineering - (LR) - 2 Units

**Advisory:** Completion of ENGL-142B or ESL-192.

5420 F 1:10-3:00pm PS-19 Wong, M 8/11 - 12/15

#### ENGIN-200 Engineering Design Graphics - (SC) - 3 Units

**Prerequisite:** MATH-121 or MATH-171

0786 MW 3:40-6:00pm PS-107 Liu, C 8/11 - 12/15

#### ENGIN-240 Properties of Engineering Materials - (LR) - 4 Units

**Prerequisite:** PHYS-130 and CHEM-120

2400 MW 3:10-4:30pm PS-113 Wong, M 8/11 - 12/15  
F 8:10-11:00am PS-19

sec	days	hrs	rm	instr	dates
<b>English</b>					

#### ENGL-001A Composition and Reading - (LR) - 4 Units

**Prerequisite:** ENGL-142B or ESL-195 with a minimum grade of C or a passing COMPASS score.

**NOTE:** Students enrolled in ENGL-001A are strongly encouraged to sign up for ENGL-102-1429. This will provide access to instructors in the College Skills Center.

1205	MW	8:10-10:00am	GE-213	Del Bourgo, R	8/11 - 12/15
1262	TTH	8:10-10:00am	GE-212	Connolly, N	8/11 - 12/15
1202	MW	9:10-11:00am	GE-211	Hassett, M	8/11 - 12/15
1213	MW	9:10-11:00am	GE-311	Jahn, B	8/11 - 12/15
1218	TTH	9:10-11:00am	GE-211	Eubanks, R	8/11 - 12/15
1236	W	9:10-1:00pm	AA-143	EichnerLynch, J	8/11 - 12/15
4085	F	9:10-1:00pm	GE-211	EichnerLynch, J	8/11 - 12/15
1256	MW	11:10-1:00pm	GE-113	Jahn, B	8/11 - 12/15
1242	TTH	11:10-1:00pm	GE-113	Smith, J	8/11 - 12/15
1243	MW	12:10-2:00pm	GE-213	Ray, L	8/11 - 12/15
1239	TTH	12:10-2:00pm	AA-117	Saunders, J	8/11 - 12/15
1669	TTH	12:10-2:00pm	GE-212	Staff, C	8/11 - 12/15
1290	M	5:10-9:00pm	GE-211	Griffin, T	8/11 - 12/15
1286	TH	5:10-9:00pm	GE-211	Clark, W	8/11 - 12/15

#### Short Term/Late Start

1284 MW 11:10-1:15pm GE-112 Hassett, M 8/28 - 12/13  
Section 1284 is a late-start class. The first meeting is on 8/28.

1244 TTH 11:10-1:15pm GE-112 Marshall, B 8/29 - 12/14  
Section 1244 is a late-start class, beginning on 8/29. This is a special section for students continuing from ENGL-142A, but is open to all students. Instructor permission is required to enroll. For more information, please contact Brandon Marshall at [bmarshall@contracosta.edu](mailto:bmarshall@contracosta.edu).

#### Online and Partially Online Sections

1285 ONLINE Eubanks, R 8/11 - 12/15

Section 1285 is offered online with mandatory meeting on Friday, 8/18 from 10:10-12:00pm in CTC-112. Students enrolled in ENGL-001A are strongly encouraged to sign up for ENGL-102-1429. This will provide access to instructors in the College Skills Center. For information contact [reubanks@contracosta.edu](mailto:reubanks@contracosta.edu).

4086 ONLINE Nahas, L 8/11 - 12/15

Section 4086 is offered in an online format. All instruction will be online. Your instructor will send a college email to you prior to class. You may contact your instructor at [lnahas@contracosta.edu](mailto:lnahas@contracosta.edu).

4087 ONLINE Hansen, J 8/11 - 12/15

Section 4087 is offered in an online format. All instruction will be online.

1352 ONLINE Eubanks, R 10/6 - 12/15

Section 1352 is offered online with a mandatory orientation session on Friday 10/6 from 10:10-12:00pm in CTC-112. Students enrolled in ENGL-001A are strongly encouraged to sign up for ENGL-102-1429. This will provide access to instructors in the College Skills Center. For information contact [reubanks@contracosta.edu](mailto:reubanks@contracosta.edu).

sec	days	hrs	rm	instr	dates
<b>ENGL-001C Critical Thinking and Advanced Composition - (LR) - 3 Units</b>					
<b>Prerequisite:</b> English 001A with a "C" or better.					
<b>NOTE:</b> Students enrolled in ENGL 002B, ENGL 001C or other transfer-level English classes are strongly encouraged to sign up for ENGL 102-1955. This will provide access to instructors in the College Skills Center.					
5968	F	9:10-12:00pm	GE-213	Aengus, G	8/11 - 12/15
1297	MW	11:10-12:30pm	GE-311	Del Bourgo, R	8/11 - 12/15
1688	TTH	11:10-12:30pm	GE-111	Lorette, R	8/11 - 12/15
3431	TTH	11:10-12:30pm	AA-205	Shannon, M	8/11 - 12/15
2563	TTH	3:10-4:30pm	GE-211	Marshall, B	8/11 - 12/15
1274	T	6:10-9:00pm	GE-211	Hansen, J	8/11 - 12/15
<b>Short Term/Late Start</b>					
1281	TH	5:10-8:00pm	GE-310	Lorette, R	8/11 - 12/15

<b>ENGL-002B Critical Thinking Through Literature - (LR) - 4 Units</b>					
<b>Prerequisite:</b> ENGL-001A					
<b>NOTE:</b> Students enrolled in ENGL-001C, ENGL-002B, or other transfer-level English classes are strongly encouraged to sign up for ENGL-102-1955. This will provide access to instructors in the College Skills Center.					
1754	TTH	9:10-11:00am	AA-205	Smith, J	8/11 - 12/15
1088	MW	11:10-1:00pm	CTC-114	Lam, D	8/11 - 12/15
1724	TTH	11:10-1:00pm	HS-1	Aengus, G	8/11 - 12/15
1736	W	1:10-5:00pm	GE-111	Roberts, M	8/11 - 12/15

<b>ENGL-081 Strategies in Reading - (SC) - 3 Units</b>					
<b>Advisory:</b> Designed for students with learning disabilities.					
2155	TTH	9:40-11:00am	CTC-113	Scanlin, A	8/11 - 12/15

<b>ENGL-082 Learning Strategies - (SC) - 3 Units</b>					
<b>Advisory:</b> Designed for students with learning disabilities.					
2157	TTH	9:40-11:00am	CTC-112	Kusaba, C	8/11 - 12/15

<b>ENGL-084 Strategies in Writing - (SC) - 3 Units</b>					
<b>Advisory:</b> Designed for students with learning disabilities.					
2161	MW	11:10-12:30pm	CTC-112	Scanlin, A	8/11 - 12/15

<b>ENGL-102 Writing Skills Laboratory - (P/NP) - .2-3 Units</b>					
<b>NOTE:</b> This will provide access to instructors in the College Skills Center. This course is open-entry/open- exit.					
0286		Hours by arr	L-121	Staff, C	8/11 - 12/15
Section 0286 is 10-162 total hours by arrangement.					
1012			L-121	Staff, C	8/11 - 12/15
Section 1012 is 10-162 total hours by arrangement.					
1426		Hours by arr	L-121	Staff, C	8/11 - 12/15
Section 1426 is 10-162 hours by arrangement. Students enrolled in ENGL-142B are strongly encouraged to sign up for ENGL-102-1426.					
1427		Hours by arr	L-121	Staff, C	8/11 - 12/15
Section 1427 is 10-162 hours by arrangement. Students enrolled in ENGL-142B are strongly encouraged to sign up for ENGL-102-1427.					
1429		Hours by arr	L-121	Staff, C	8/11 - 12/15
Section 1429 is 10-162 hours by arrangement. Students enrolled in ENGL-001A are strongly encouraged to sign up for ENGL-102-1429.					
1959		Hours by arr	L-121	Staff, C	8/11 - 12/15
Section 1959 is 10-162 total hours by arrangement.					
0286		Hours by arr	L-121	Staff, C	8/11 - 12/15
Section 0286 is 10-162 total hours by arrangement.					

<b>ENGL-142B Writing: Expository - (SC) - 4 Units</b>					
<b>Prerequisite:</b> ENGL-139; or ENGL-142A and ENGL-110A; or ESL-192 with a "C" or better; or Compass/ESL placement test.					
<b>NOTE:</b> Students enrolled in ENGL-142B are strongly encouraged to sign up for ENGL-102-1426 or ENGL 102-1427. This will provide access to instructors in the College Skills Center.					
5103	TTH	8:10-10:00am	GE-213	Staff, C	8/11 - 12/15
5986	TTH	8:10-10:00am	HS-1	Ramirez, M	8/11 - 12/15
5980	TTH	8:40-10:30am	ELC-103	Shannon, M	8/11 - 12/15
0355	MW	9:10-11:00am	GE-112	Adesokan, B	8/11 - 12/15
5979	MW	9:10-11:00am	GE-212	Ornelas-Garcia, E	8/11 - 12/15
5981	MW	9:10-11:00am	PS-101	Ramirez, M	8/11 - 12/15
0356	TTH	9:10-11:00am	A-2	Sullivan, V	8/11 - 12/15
0788	TTH	9:10-11:00am	GE-112	Ornelas-Garcia, E	8/11 - 12/15
5990	TTH	9:10-11:00am	HS-3	Lam, D	8/11 - 12/15

Section 5990 is designed for Puente students, but is open to all students. Students must also enroll in COUNS-103A-1052, and attend orientation. For more information contact, Norma Valdez Jimenez or nvaldezjimenez@contracosta.edu or Dickson Lam at dlam@contracosta.edu.

4804	MW	10:10-12:00pm	GE-213	Ray, L	8/11 - 12/15
5983	MW	10:10-12:00pm	M-1 10	Bollman, J	8/11 - 12/15
5985	MW	10:10-12:00pm	AA-145	Allums, L	8/11 - 12/15
1094	MW	11:10-1:00pm	GE-313	Adesokan, B	8/11 - 12/15

Section 1094 is for students in the Per Ankh Academy, but is open to all students. Students must also enroll in HIST 110-1158 and attend orientation. For more information, contact Sherry Sharufa at ssharufa@contracosta.edu or 510-215-3810.

5098	MW	11:10-1:00pm	GE-211	Donlan, K	8/11 - 12/15
5988	MW	11:10-1:00pm	CTC-127	Staff, C	8/11 - 12/15
0360	TTH	11:10-1:00pm	GE-213	Donlan, K	8/11 - 12/15
5987	TTH	11:10-1:00pm	GE-211	Connolly, N	8/11 - 12/15
5982	MW	12:10-2:00pm	A-2	Freeman, D	8/11 - 12/15
5989	MW	12:10-2:00pm	AA-117	Gibson, B	8/11 - 12/15
0326	TTH	1:10-3:00pm	GE-211	Ornelas-Garcia, E	8/11 - 12/15
0336	TTH	1:10-3:00pm	B-7	Sullivan, V	8/11 - 12/15
2495	TH	5:10-9:00pm	GE-311	Heid, T	8/11 - 12/15

Students enrolled in ENGL-142B are strongly encourage to sign up for ENGL-102-1427. This will provide access to instructors in the College Skills Center.

5984	T	6:10-10:00pm	GE-104	Allums, L	8/11 - 12/15
0330	F	6:10-10:00pm	GE-211	Bollman, J	8/11 - 12/15
2127	MW	6:10-8:15pm	GE-213	Shaffer, M	8/28 - 12/15

Section 2127 is a late-start class. The first meeting is on 8/28.

<b>Weekend</b>					
5725	S	9:10-1:00pm	GE-211	Griffin, T	8/11 - 12/15

<b>ENGL-163 Film As Literature - (SC) - 3 Units</b>					
<b>Short Term/Late Start</b>					
1206	T	6:10-9:30pm	GE-225	Michels, J	8/29 - 12/12
Section 1206 is a late-start class. The first meeting is on 08/29.					

<b>ENGL-274 Women in Literature - (SC) - 3 Units</b>					
<b>Prerequisite:</b> ENGL 142B or eligibility for ENGL-001A.					
<b>Weekend</b>					
3274	S	8:10-5:00pm	GE-310	EichnerLynch, J	8/26 - 11/4
Section 3274 meets on Saturdays from 8:10-5:00pm in GE-310: 8/26, 9/9, 9/30, 10/14, 10/28, 11/4.					

<b>ENGL-293H Creative Writing - (SC) - 3 Units</b>					
<b>Prerequisite:</b> ENGL-142B or eligibility for ENGL-001A <b>Advisory:</b> Successful completion of ENGL-001A.					
<b>Short Term/Late Start</b>					
0733	TH	2:10-5:30pm	GE-110	Jahn, B	8/31 - 12/14
Section 0733 is a late-start class beginning on Thursday 8/31.					

sec	days	hrs	rm	instr	dates
<b>ENGL-875N Supervised Tutoring - (P/NP) - 0 Unit</b>					
2854			L-116	Gibson, B	8/11 - 12/15
Section 2854 is an open-entry/exit-class.					
<b>English As a Second Language</b>					
<b>ESL-050 Beginning ESL - (P/NP) - 2 Units</b>					
1132	MWF	9:10-11:00am	PS-113	Kalkstein, H	8/11 - 12/15
3286	TTH	6:10-9:00pm	GE-313	Lopez, D	8/11 - 12/15
<b>ESL-107 Drop-in ESL Tutoring - (P/NP) - .1-3 Units</b>					
3107			L-121	Staff, C	8/11 - 12/15
<b>ESL-108 Orientation to College/ESL - (P/NP) - .15 Unit</b>					
2622	M	1:10-4:00pm	GE-211	Ruby, S	8/7 - 8/7
2623	M	5:40-8:30pm	GE-211	Ruby, S	8/7 - 8/7
2624	T	9:10-12:00pm	GE-211	Ruby, S	8/8 - 8/8
2627	T	1:10-4:00pm	GE-213	Ruby, S	8/8 - 8/8
2635	W	9:10-12:00pm	GE-211	Ruby, S	8/9 - 8/9
<b>ESL-123 Listening/Speaking I - (SC) - 4 Units</b>					
<b>Advisory:</b> Appropriate score on ESL placement test.					
6024	MW	9:10-11:00am	CTC-113	Ruby, S	8/11 - 12/15
1951	MW	6:10-8:00pm	AA-143	DeGennaro, E	8/11 - 12/15
<b>ESL-126 Listening/Speaking II - (SC) - 4 Units</b>					
<b>Advisory:</b> Successful completion of ESL-123 or appropriate score on ESL placement test.					
6027	MW	9:10-11:00am	AA-117	Segade, G	8/11 - 12/15
1958	MW	6:10-8:00pm	GE-104	Goy, J	8/11 - 12/15
<b>ESL-129 Listening/Spkng III - (SC) - 4 Units</b>					
<b>Advisory:</b> Successful completion of ESL-126 or appropriate score on ESL placement test.					
3005	MW	9:10-11:00am	GE-108	Xiezopolski, E	8/11 - 12/15
1167	MW	6:10-8:00pm	GE-112	Nicol, L	8/11 - 12/15
<b>ESL-132 Oral Communication for Advanced ESL Students - (SC) - 4 Units</b>					
<b>Advisory:</b> Successful completion of ESL-129 or appropriate score on ESL placement test.					
6031	MW	9:10-11:00am	M-111	Borhan, A	8/11 - 12/15
0805	MW	6:10-8:00pm	GE-214	Flood, J	8/11 - 12/15
<b>ESL-143 English Fluency and Vocabulary I - (SC) - 4 Units</b>					
<b>Advisory:</b> Appropriate score on ESL placement test.					
1136	MW	12:40-2:30pm	GE-212	Goy, J	8/11 - 12/15
<b>ESL-146 English Fluency and Vocabulary II - (SC) - 4 Units</b>					
<b>Advisory:</b> Successful completion of ESL-143 or appropriate score on ESL placement test.					
6037	MW	12:40-2:30pm	GE-311	Xiezopolski, E	8/11 - 12/15
<b>ESL-149 Academic &amp; Professional ESL III - (SC) - 4 Units</b>					
<b>Advisory:</b> Successful completion of ESL-146 or appropriate score on ESL placement test.					
1542	MW	12:40-2:30pm	GE-310	Flood, J	8/11 - 12/15

sec	days	hrs	rm	instr	dates
<b>ESL-152 Academic &amp; Professional ESL IV - (SC) - 4 Units</b>					
<b>Advisory:</b> Successful completion of ESL 149 or appropriate score on ESL placement test.					
6039	MW	12:40-2:30pm	GE-214	Segade, G	8/11 - 12/15
<b>ESL-163 Grammar I - (SC) - 4 Units</b>					
<b>Advisory:</b> Appropriate score on ESL placement test.					
6040	TTH	9:10-11:00am	AA-142	Xiezopolski, E	8/11 - 12/15
<b>ESL-166 Grammar II - (SC) - 4 Units</b>					
<b>Advisory:</b> Successful completion of ESL-163 or appropriate score on ESL placement test.					
3347	TTH	9:10-11:00am	GE-113	Ruby, S	8/11 - 12/15
<b>ESL-169 Grammar III - (SC) - 4 Units</b>					
<b>Advisory:</b> Successful completion of ESL-166 or appropriate score on ESL placement test.					
6046	TTH	9:10-11:00am	GE-311	Borhan, A	8/11 - 12/15
<b>ESL-172 Grammar IV - (SC) - 4 Units</b>					
<b>Advisory:</b> Successful completion of ESL-169 or appropriate score on ESL placement test.					
2207	TTH	9:10-11:00am	AA-117	Segade, G	8/11 - 12/15
<b>ESL-178 Grammar V - (SC) - 4 Units</b>					
2538	TTH	9:10-11:00am	GE-214	Marvin, S	8/11 - 12/15
<b>ESL-183 Writing I - (SC) - 5 Units</b>					
<b>Advisory:</b> Appropriate score on ESL placement test.					
6052	TTH	12:40-3:00pm	GE-104	Borhan, A	8/11 - 12/15
0889	TTH	6:10-8:30pm	AA-142	Letellier, K	8/11 - 12/15
<b>ESL-186 Writing II - (SC) - 5 Units</b>					
<b>Advisory:</b> Successful completion of ESL-183 or appropriate score on ESL placement test.					
6053	TTH	12:40-3:00pm	CTC-113	McNabb, J	8/11 - 12/15
0891	TTH	6:10-8:30pm	HS-1	Khan Winter, L	8/11 - 12/15
<b>ESL-189 Writing III - (SC) - 5 Units</b>					
<b>Advisory:</b> Successful completion of ESL-186 or appropriate score on ESL placement test.					
1025	TTH	12:40-3:00pm	GE-108	Ruby, S	8/11 - 12/15
2801	TTH	6:10-8:30pm	GE-314	Allen, T	8/11 - 12/15
<b>ESL-192 Introduction to Essay Writing for ESL Students - (SC) - 5 Units</b>					
<b>Advisory:</b> Successful completion of ESL-189 or appropriate score on ESL placement test.					
6055	TTH	12:40-3:00pm	AA-133	Marvin, S	8/11 - 12/15
<b>ESL-195 Reading and Composition for Advanced ESL Students - (SC) - 5 Units</b>					
<b>Prerequisite:</b> ESL-192 or appropriate score on ESL placement test.					
1068	TTH	12:40-3:00pm	M-110	Jordan, B	8/11 - 12/15

sec	days	hrs	rm	instr	dates
<b>Geography</b>					

#### GEOG-120 Physical Geography - (SC) - 3 Units

1047	M	6:10-9:00pm	GE-314	Staff, C	8/11 - 12/15
------	---	-------------	--------	----------	--------------

#### Weekend

1044	S	8:10-11:00am	GE-314	Staff, C	8/11 - 12/15
------	---	--------------	--------	----------	--------------

#### GEOG-120L Physical Geography Laboratory - (LR) - 1 Unit

**Corequisite:** Concurrent enrollment in or prior completion of GEOG 120 with grade of 'C' or better.

#### Weekend

0174	S	11:40-5:30pm	GE-314	Staff, C	8/12 - 12/2
------	---	--------------	--------	----------	-------------

Section 0174 has the following required meetings: 8/12, 8/19, 9/09, 9/16, 10/07, 10/14, 11/4, 11/11, 12/2 in GE-314.

#### GEOG-130 Cultural Geography - (SC) - 3 Units

0895	TTH	8:10-9:30am	GE-314	Staff, C	8/11 - 12/15
------	-----	-------------	--------	----------	--------------

#### Online and Partially Online Sections

1703			ONLINE	Schillo, N	9/11 - 12/15
------	--	--	--------	------------	--------------

Section 1703 is offered online with a mandatory online orientation. All instruction will be online. You will receive an email from your instructor before the class begins giving you info about the course. For information contact nschillo@contracosta.edu.

#### GEOG-150 California Geography - (LR) - 3 Units

1550	MW	12:40-2:00pm	GE-314	Staff, C	8/11 - 12/15
------	----	--------------	--------	----------	--------------

#### GEOG-300 Field Studies - (LR) - .2 Unit

5303			Staff, C		9/21 - 10/7
------	--	--	----------	--	-------------

Section 5303 is offered for .2 units. On campus class meeting Thursday 9/21 from 11-1pm and class fieldtrip to Point Reyes National Park or other destination on Saturday 10/07 8:00am-4:00pm field studies focus to be arranged. For additional information, contact Prof. Manu Ampim at mampim@contracosta.edu.

### Health and Human Services

#### HHS-114 Intro to Health Professions - (P/NP) - 1 Unit

2399	T	3:10-4:00pm	HS-1	Ruderman, R	8/11 - 12/15
------	---	-------------	------	-------------	--------------

Section 2399 requires all first-semester medical assisting students to attend a mandatory orientation on August 12, 2016 from 12:30-1:30p or 3:30-4:30pm in AA-143. Please bring your educational plan.

#### HHS-115 Personal Development for Life and Work - (LR) - 3 Units

1393	T	3:10-6:00pm	GE-112	Mickles, A	8/11 - 12/15
------	---	-------------	--------	------------	--------------

#### HHS-219 Introduction to Human Services - (LR) - 3 Units

1430	W	4:10-7:00pm	GE-108	Hargan, K	8/11 - 12/15
------	---	-------------	--------	-----------	--------------

#### HHS-223 Introduction to Case Management - (SC) - 3 Units

1387	T	6:10-9:00pm	GE-214	Mickles, A	8/11 - 12/15
------	---	-------------	--------	------------	--------------

#### HHS-225 Ethics for Human Services Professionals - (SC) - 3 Units

1438	T	12:10-3:00pm	HS-101	Mickles, A	8/11 - 12/15
------	---	--------------	--------	------------	--------------

#### HHS-227 Introduction to Dual Diagnosis - (SC) - 3 Units

2227	TH	6:10-9:00pm	GE-212	Mickles, A	8/11 - 12/15
------	----	-------------	--------	------------	--------------

#### HHS-228 Introduction to Psychosocial Rehabilitation - (SC) - 3 Units

2857	TH	2:10-5:00pm	GE-112	Johnson, M	8/11 - 12/15
------	----	-------------	--------	------------	--------------

sec	days	hrs	rm	instr	dates
<b>Health Education</b>					

#### HED-115 Applied Nutrition - (LR) - 3 Units

##### Online and Partially Online Sections

1440			ONLINE	Goehring, B	9/25 - 12/15
------	--	--	--------	-------------	--------------

Section 1440 is offered online. All instruction will be online. Students must check college email prior to online orientation for course instructions and materials. Students must email instructor at bgoehring@contracosta.edu after registering.

#### HED-120 Education for Healthful Living - (LR) - 3 Units

0838	MW	8:10-9:30am	AA-135	Ferguson, N	8/11 - 12/15
------	----	-------------	--------	-------------	--------------

0854	TTH	9:40-11:00am	CTC-114	Johnson, M	8/11 - 12/15
------	-----	--------------	---------	------------	--------------

0845	MW	12:40-2:00pm	GA-50	Johnson, M	8/11 - 12/15
------	----	--------------	-------	------------	--------------

##### Online and Partially Online Sections

0857			ONLINE	Johnson, M	8/11 - 12/15
------	--	--	--------	------------	--------------

Section 0857 is offered in a fully online format. Course information will be sent to your college email address prior to the class start date. For more information contact Miguel Johnson at mjohnson@contracosta.edu.

5713			ONLINE	Ferguson, N	8/11 - 12/15
------	--	--	--------	-------------	--------------

Section 5713 is offered online. Students must email instructor at nferguson@contracosta.edu prior to online orientation for course information and materials.

3721			ONLINE	Ferguson, N	9/25 - 12/15
------	--	--	--------	-------------	--------------

Section 3721 is offered online. Students must email instructor at nferguson@contracosta.edu prior to online orientation for course information and materials.

### History

#### HIST-110 History of African Civilization - (SC) - 3 Units

1158	TTH	12:40-2:00pm	GE-313	Ampim, M	8/11 - 12/15
------	-----	--------------	--------	----------	--------------

Section 1158 is required for all students in the Per Ankh program, but is open to all students. This class is part of the AFRAM Studies program.

#### HIST-120 History of the U.S. (Colonial - 1865) - (SC) - 3 Units

0801	MW	9:40-11:00am	GE-313	Ampim, M	8/11 - 12/15
------	----	--------------	--------	----------	--------------

0804	TTH	9:40-11:00am	GE-313	Ampim, M	8/11 - 12/15
------	-----	--------------	--------	----------	--------------

0806	MW	11:10-12:30pm	GE-225	Ampim, M	8/11 - 12/15
------	----	---------------	--------	----------	--------------

0811	TTH	11:10-12:30pm	GE-313	Tirado, P	8/11 - 12/15
------	-----	---------------	--------	-----------	--------------

2585	TTH	2:10-3:30pm	GE-313	Tirado, P	8/11 - 12/15
------	-----	-------------	--------	-----------	--------------

5593	M	6:10-9:00pm	GE-312	Aaron, A	8/11 - 12/15
------	---	-------------	--------	----------	--------------

##### Online and Partially Online Sections

1168			PART-ONL	Tirado, P	8/11 - 12/15
------	--	--	----------	-----------	--------------

	M	6:10-9:00pm	GE-310		
--	---	-------------	--------	--	--

Section 1168 is offered in a partially online format with mandatory meetings on Mondays 8/14 and 10/16, from 6:10-9:00 p.m., in GE-310. For more information, contact ptirado@contracosta.edu.

#### HIST-121 History of U.S. (1865 - Present) - (SC) - 3 Units

0822	TTH	8:10-9:30am	GE-313	Ampim, M	8/11 - 12/15
------	-----	-------------	--------	----------	--------------

0831	W	6:10-9:00pm	GE-313	Scott, A	8/11 - 12/15
------	---	-------------	--------	----------	--------------

#### HIST-122 History of African Americans in the U.S. - (SC) - 3 Units

3573	TTH	9:40-11:00am	GE-312	Hodge, C	8/11 - 12/15
------	-----	--------------	--------	----------	--------------

This class is a part of the AFRAM Studies program.

2244	MW	11:10-12:30pm	GE-312	Hodge, C	8/11 - 12/15
------	----	---------------	--------	----------	--------------

This class is a part of the AFRAM Studies program.

1331	MW	4:10-5:30pm	GE-312	Hodge, C	8/11 - 12/15
------	----	-------------	--------	----------	--------------

This class is a part of the AFRAM Studies program.



sec	days	hrs	rm	instr	dates
<b>HIST-127 History of Latinos in the United States (1846 - Present) - (SC) - 3 Units</b>					
1640	MW	11:10-12:30pm	GE-310	Palacios, A	8/11 - 12/15
Section 1640 meets at the same time as LARAZ-127-1639.					
1272	TTH	11:10-12:30pm	GE-311	Palacios, A	8/11 - 12/15
Section 1272 meets at the same time as LARAZ-127-1127.					
<b>Online and Partially Online Sections</b>					
1990			PART-ONL	Palacios, A	8/24 - 12/14
	TH	6:10-9:00pm	GE-112		
Section 1990 is offered in a partially online format with mandatory meetings on Thursdays 8/31, 9/28, 10/12, 11/16, and 12/14 6:10-9:00pm in GE-112. This section meets at the same time as LARAZ-127-1991.					

<b>HIST-140 History of Western Civilization to the Renaissance - (SC) - 3 Units</b>					
<b>Online and Partially Online Sections</b>					
1333			PART-ONL	Story, M	10/14 - 12/2
	S	9:10-12:30pm	GE-312		
Section 1333 is a partially online class with a combination of class meetings and online instruction. mandatory class meetings on Saturdays: 10/14, 10/21, 10/28, 11/11, 11/18, and the final exam is 12/2 from 9:10-12:30pm in GE 312. For information contact mstory@contracosta.edu.					

## Humanities

<b>HUMAN-113 African American Humanities - (SC) - 3 Units</b>					
1099	MW	9:40-11:00am	GE-113	Artry Diouf, E	8/11 - 12/15
This class is a part of the AFRAM Studies program.					
1097	TTH	12:40-2:00pm	GE-312	Martinez, D	8/11 - 12/15
This class is a part of the AFRAM Studies program.					

<b>HUMAN-120 Introduction to Humanities: Imagination, Invention and Creativity - (SC) - 3 Units</b>					
0188	MW	9:40-11:00am	B-2	Sharoki, S	8/11 - 12/15
0195	F	9:40-12:30pm	B-2	Gill, K	8/11 - 12/15
2149	TTH	11:10-12:30pm	GE-214	Gill, K	8/11 - 12/15
0187	MW	12:40-2:00pm	B-2	Kabir, A	8/11 - 12/15
5627	T	2:10-5:00pm	GE-311	Gill, K	8/11 - 12/15
<b>Short Term/Late Start</b>					
5626	TTH	2:10-5:00pm	B-2	Wulferdingen, J	10/12 - 12/14
Section 5626 is a late start class. The first meeting is 10/12.					

<b>HUMAN-180 Understanding Love - (SC) - 3 Units</b>					
0189	TTH	9:40-11:00am	B-2	Houston, D	8/11 - 12/15

## Japanese

<b>JAPAN-120 First-Semester Japanese - (SC) - 5 Units</b>					
5709	TTH	8:40-11:00am	GA-50	Uchima-Decena, A	8/11 - 12/15

## Journalism

<b>JRNAL-110A News Practice Laboratory: Beginning I - (SC) - 1-2 Units</b>					
<b>Corequisite:</b> JRNAL-122					
4073				DeBolt, P	8/11 - 12/15
Section 4073 is open-entry/open-exit.					

<b>JRNAL-110B News Practice Laboratory: Beginning II - (SC) - 1-2 Units</b>					
<b>Corequisite:</b> JRNAL-123					
4077				DeBolt, P	8/11 - 12/15
Section 4077 is open-entry/open-exit.					

sec	days	hrs	rm	instr	dates
<b>JRNAL-110C News Practice Laboratory: Intermediate I - (SC) - 1-2 Units</b>					
<b>Corequisite:</b> JRNAL-222					
4079				DeBolt, P	8/11 - 12/15
Section 4079 is open-entry/open-exit.					

<b>JRNAL-110D News Practice Laboratory:intermediate II - (SC) - 1-2 Units</b>					
<b>Corequisite:</b> JRNAL-223					
4082				DeBolt, P	8/11 - 12/15
Section 4082 is open-entry/open-exit.					

<b>JRNAL-120 Newswriting and Reporting - (SC) - 3 Units</b>					
0457	MW	11:10-12:30pm	AA-215	DeBolt, P	8/11 - 12/15

<b>JRNAL-122 News Production: Beginning I - (SC) - 3 Units</b>					
<b>Corequisite:</b> JRNAL-110A					
0458	MW	9:40-11:00am	AA-215	DeBolt, P	8/11 - 12/15

<b>JRNAL-123 News Production: Beginning II - (SC) - 3 Units</b>					
<b>Prerequisite:</b> JRNAL-122 <b>Corequisite:</b> JRNAL 110					
0459	MW	9:40-11:00am	AA-215	DeBolt, P	8/11 - 12/15

<b>JRNAL-130 Mass Communication - (SC) - 3 Units</b>					
6475	F	9:40-12:30pm	AA-215	DeBolt, P	8/11 - 12/15

<b>JRNAL-222 News Production: Intermediate I - (SC) - 3 Units</b>					
<b>Prerequisite:</b> JRNAL-123 <b>Corequisite:</b> JRNAL 110C					
0460	MW	9:40-11:00am	AA-215	DeBolt, P	8/11 - 12/15

<b>JRNAL-223 News Production: Intermediate II - (SC) - 3 Units</b>					
<b>Prequisite:</b> JRNAL-222 <b>Corequisite:</b> JRNAL 110D					
0462	MW	9:40-11:00am	AA-215	DeBolt, P	8/11 - 12/15

## Kinesiology

<b>KINES-190 Introduction to Kinesiology - (LR) - 3 Units</b>					
<b>Online and Partially Online Sections</b>					
3190			ONLINE	Ferguson, N	10/16 - 12/15
Section 1323 is offered online. Students must check college email for course instructions and materials. An online orientation will be presented in Canvas. Students must email instructor after registering at nferguson@contracosta.edu.					

<b>KINES-191 Elementary Physical Education - (SC) - 3 Units</b>					
<b>Online and Partially Online Sections</b>					
2191			PART-ONL	Valdehuesa, T	10/16 - 12/11
	M	6:10-9:00pm	PINOLEHS		
Section 2191 is offered in a partially online format with mandatory meetings on: Mondays, 10/16, 10/30, 11/13, 11/27, and 12/11 from 6:10-9:00pm at Pinole Valley High School. Students must email the instructor after registering at tvaldehuesa@contracosta.edu.					

<b>KINES-197 Human Development Throughout the Lifespan - (SC) - 3 Units</b>					
<b>Online and Partially Online Sections</b>					
1323			ONLINE	Greenberg, M	9/25 - 12/15
Section 1323 is offered online. Students must check college email for course instructions and materials. An online orientation will be presented in Canvas. Students must email instructor after registering at mgreenberg@dvc.edu.					

sec	days	hrs	rm	instr	dates
<b>KINES-199 Personal Fitness Training - (SC) - 3 Units</b>					
<b>Online and Partially Online Sections</b>					
1672			PART-ONL Barber, J		10 - 12/12
	T	6:10-9:00pm	GA-50		

Section 1672 is offered in a partially online format with mandatory meetings on Tuesdays 10, 10/31, 11/14, 11/28, and 12/12 from 6:10-9:00pm in GA-50. Students must email the instructor after registering at jbarber@contracosta.edu.

## La Raza Studies

<b>HIST-127 History of Latinos in the United States (1846 - Present) - (SC) - 3 Units</b>					
1640	MW	11:10-12:30pm	GE-310	Palacios, A	8/11 - 12/15
Section 1640 meets at the same time as LARAZ 127-1639.					
1272	TTH	11:10-12:30pm	GE-311	Palacios, A	8/11 - 12/15
Section 1272 meets at the same time as LARAZ-127-1127.					

### Online and Partially Online Sections

1990			PART-ONL Palacios, A		8/24 - 12/14
	TH	6:10-9:00pm	GE-112		
Section 1990 is offered in a partially online format with mandatory meetings on Thursdays 8/31, 9/28, 10/12, 11/16, and 12/14 6:10-9:00pm in GE-112. This section meets at the same time as LARAZ-127-1991.					

### LARAZ-110 Introduction to La Raza Studies - (LR) - 3 Units

1155	MW	12:40-2:00pm	GE-104	Mojica-Villegas, E	8/11 - 12/15
------	----	--------------	--------	--------------------	--------------

### LARAZ-113 Introduction to Analysis of American Political Institutions - (SC) - 3 Units

1134	MW	9:40-11:00am	GE-310	Palacios, A	8/11 - 12/15
------	----	--------------	--------	-------------	--------------

### Online and Partially Online Sections

1133			PART-ONL Palacios, A		8/25 - 12/15
	F	9:10-12:30pm	GE-310		
Section 1133 is offered in a partially online format with mandatory meetings on Fridays 8/25, 9/8, 10/6, 12/1 from 9:10-12:30pm in GE-310.					

### LARAZ-125 Latin American History - (SC) - 3 Units

1982	TTH	12:40-2:00pm	AA-145	Villafane, A	8/11 - 12/15
------	-----	--------------	--------	--------------	--------------

### LARAZ-127 History of Latinos in the United States (1846 - Present) - (SC) - 3 Units

1639	MW	11:10-12:30pm	GE-310	Palacios, A	8/11 - 12/15
Section 1639 meets at the same time as HIST-127-1640.					
1127	TTH	11:10-12:30pm	GE-311	Palacios, A	8/11 - 12/15
Section 1127 meets at the same time as HIST-127-1272.					

### Online and Partially Online Sections

1991			PART-ONL Palacios, A		8/24 - 12/14
	TH	6:10-9:00pm	GE-112		
Section 1991 is offered in a partially online format with mandatory meetings on Thursdays 8/31, 9/28, 10/12, 11/16, and 12/14 6:10-9:00pm in GE-112. This section meets at the same time as HIST-127-1990.					

### LARAZ-130 Contemporary Chicano/Latino Literature - (SC) - 3 Units

3932	TTH	9:40-11:00am	PS-106	Villafane, A	8/11 - 12/15
------	-----	--------------	--------	--------------	--------------

### LARAZ-141 Introduction to Psychology of La Raza - (SC) - 3 Units

1157	W	6:10-9:20pm	GE-310	Staff, C	8/23 - 12/6
------	---	-------------	--------	----------	-------------

sec	days	hrs	rm	instr	dates
<b>Library Studies</b>					

### LIBST-110A Library and Information Research Skills - (SC) - 1 Unit

#### Online and Partially Online Sections

2916			PART-ONL Choi, A		8/11 - 12/15
Section 2916 is offered in a partially online format for 1 unit. Students will receive a college email with choices of a mandatory orientation date and how to sign up. For more information email instructor achoi@contracosta.edu.					
2906			PART-ONL Jan, D		8/16 - 10/10

	W	6:10-9:00pm	L-107		
Section 2906 is offered in a partially online format with mandatory meetings on Wednesdays 8/16 and 8/23 from 6:10-9:00pm in Room L-107. For more information contact djan@contracosta.edu.					

2907			PART-ONL Williams, A		9/9 - 11/3
	S	10:10-1:00pm	L-107		

Section 2907 is offered in a partially online format with mandatory meetings on Saturdays 9/9 and 9/16 from 10:10-1:00pm in room L-107. For more information contact awilliams@contracosta.edu.

2908			PART-ONL Becvar, K		9/21 - 11/15
	TH	6:10-9:00pm	L-107		

Section 2908 is offered in a partially online format with mandatory meetings on Thursdays 9/21 and 9/28 from 6:10 to 9:00pm in room L-107. For more information contact kbecvar@contracosta.edu.

## Mathematics

### MATH-080 Strategies in Math - (P/NP) - 3 Units

**Advisory:** Designed for students with learning disabilities

5120	TTH	12:40-2:00pm	CTC-112	Scanlin, A	8/11 - 12/15
------	-----	--------------	---------	------------	--------------

### MATH-101 Basic Skills of Arithmetic - (LR) - 3 Units

1080	MW	11:10-12:30pm	AA-135	Zin, R	8/11 - 12/15
1237	MW	12:40-2:00pm	CTC-112	Watabayashi, D	8/11 - 12/15

### MATH-115 Pre-Algebra - (LR) - 3 Units

1101	TTH	8:10-9:30am	GE-111	Wu, C	8/11 - 12/15
1103	MW	9:40-11:00am	AA-205	Sharufa, S	8/11 - 12/15
1107	TTH	11:10-12:30pm	AA-145	Wu, C	8/11 - 12/15
1112	TTH	5:40-7:00pm	CTC-114	Gopinath, L	8/11 - 12/15

sec	days	hrs	rm	instr	dates
<b>MATH-118 Elementary Algebra - (LR) - 5 Units</b>					
1122	MW	8:10-9:00am	AA-143	Sharufa, S	8/11 - 12/15
	TTH	8:10-9:30am			
1185	MW	9:10-10:30am	AA-142	Zin, R	8/11 - 12/15
	F	9:10-11:00am			
1154	MW	10:10-11:00am	AA-211	VanHattum, S	8/11 - 12/15
	TTH	9:40-11:00am			
1156	MW	11:10-12:00pm	AA-211	Lassonde, K	8/11 - 12/15
	TTH	11:10-12:30pm			
1151	TTH	12:40-3:00pm	CTC-114	Sharufa, S	8/11 - 12/15
2430	MW	1:10-2:00pm	AA-143	Nguyen, T	8/11 - 12/15
	TTH	12:40-2:00pm			
1522	MW	2:40-5:00pm	AA-211	Hsu, J	8/11 - 12/15
1191	TTH	2:40-5:00pm	AA-145	Gopinath, L	8/11 - 12/15
1369	TTH	2:40-5:00pm	AA-143	Voiculescu, I	8/11 - 12/15
1140	MW	7:10-9:30pm	AA-137	Stewart, C	8/11 - 12/15
3365	TTH	7:10-9:30pm	AA-211	Hardak-Inberg, M	8/11 - 12/15
<b>Online and Partially Online Sections</b>					
5348			PART-ONL	Bersano, E	8/11 - 12/15
	M	5:10-7:00pm	CTC-127		
Section 5348 is offered in a partially online format with mandatory meetings: orientation, Mon., 8/14; mid-term exam, Mon., 10/9; & final xam, Mon., 12/11 5:10-7:00pm in CTC-127. Students will receive textbook information for the online test. For information contact ebersano@contracosta.edu.					

<b>MATH-120 Intermediate Algebra - (LR) - 5 Units</b>					
<b>Prerequisite:</b> MATH-118					
1178	MW	8:10-9:00am	AA-133	Bersano, E	8/11 - 12/15
	TTH	8:10-9:30am			
1188	MW	10:10-11:00am	AA-133	Bersano, E	8/11 - 12/15
	TTH	9:40-11:00am			
1190	MW	11:10-12:00pm	AA-207	Sran, S	8/11 - 12/15
	TTH	11:10-12:30pm			
2429	MW	12:10-2:30pm	CTC-113	Simon, B	8/11 - 12/15
1182	MW	2:40-5:00pm	AA-143	Lee, M	8/11 - 12/15
1505	TTH	2:40-5:00pm	AA-211	Hardak-Inberg, M	8/11 - 12/15
1201	MW	7:10-9:30pm	AA-211	Luu, T	8/11 - 12/15
2175	TTH	7:10-9:30pm	AA-137	Nyantika, T	8/11 - 12/15
<b>Online and Partially Online Sections</b>					
5349			PART-ONL	Lassonde, K	8/11 - 12/15
	M	5:10-7:00pm	CTC-128		
Section 5349 is offered in a partially online format with mandatory: orientation, Monday, 8/14, mid-term exams, Monday 9/18 and 10/23, & final exam, Monday, 12/11 in CTC-128 from 5:10 to 7:00pm. For more information please contact instructor at klassonde@contracosta.edu.					
1183			PART-ONL	Bersano, E	8/11 - 12/15
	T	5:10-7:00pm	CTC-128		
Section 1183 is offered in a partially online- hybrid format with mandatory meetings: orientation, Tues., 8/15; mid-term exam, Tues., 10/10; & final exam, Tues., 12/12 5:10-7:00pm in CTC-128. Students will receive textbook information for the online test. For information contact ebersano@contracosta.edu.					

<b>MATH-121 Trigonometry - (LR) - 3 Units</b>					
<b>Prerequisite:</b> MATH-120 & <b>Advisory:</b> MATH-119					
2212	TTH	9:40-11:00am	GE-310	Hassanabadi, A	8/11 - 12/15
3468	TTH	11:10-12:30pm	GE-104	Watabayashi, D	8/11 - 12/15

sec	days	hrs	rm	instr	dates
<b>MATH-125 Algebra for Statistics - (SC) - 6 Units</b>					
1164	MTWTH	8:10-10:00am	AA-103	Cruz, E	8/11 - 12/15
1165	MTWTH	10:10-12:00pm	AA-103	Nguyen, T	8/11 - 12/15
1150	MTWTH	12:10-2:00pm	AA-103	Lee, H	8/11 - 12/15

<b>MATH-135 College Algebra - (LR) - 3 Units</b>					
<b>Prerequisite:</b> MATH-120					
2106	MWF	8:10-9:00am	AA-145	Watabayashi, D	8/11 - 12/15

<b>MATH-164 Introduction to Probability and Statistics - (LR) - 4 Units</b>					
<b>Prerequisite:</b> MATH-120					
1211	MTWTH	8:10-9:00am	B-2	Azgui, N	8/11 - 12/15
1220	MTWTH	9:10-10:00am	AA-131	Mead, T	8/11 - 12/15
1215	MTWTH	10:10-11:00am	AA-131	Scott, G	8/11 - 12/15
2172	MTWTH	11:10-12:00pm	AA-137	VanHattum, S	8/11 - 12/15
2170	MW	12:10-2:00pm	AA-131	Sharufa, S	8/11 - 12/15
1217	TTH	12:40-2:30pm	AA-131	Fish, T	8/11 - 12/15
1143	MW	2:10-4:00pm	AA-103	Nguyen, T	8/11 - 12/15
1645	TTH	3:10-5:00pm	AA-131	Stewart, C	8/11 - 12/15
1641	MW	5:10-7:00pm	AA-131	Nagel, C	8/11 - 12/15
1219	TTH	5:10-7:00pm	AA-131	Fish, T	8/11 - 12/15
1199	MW	7:10-9:00pm	AA-131	Lee, M	8/11 - 12/15

<b>Online and Partially Online Sections</b>					
1130			ONLINE	Nguyen, T	8/11 - 12/15
Section 1130 is offered in a fully online format. Students must complete a mandatory online orientation in Canvas. You will receive a college email prior to the start date from your instructor. For more information contact tnguyen@contracosta.edu.					
1582			ONLINE	Nguyen, T	12/12 - 1/11
Section 1582 is offered in a fully online format. Students must complete a mandatory online orientation in Canvas. You will receive a college email prior to the start date from your instructor. For more information contact tnguyen@contracosta.edu.					

<b>MATH-170 Finite Mathematics - (LR) - 5 Units</b>					
<b>Prerequisite:</b> MATH-120					
2163	MW	2:40-5:00pm	GE-110	Cruz, E	8/11 - 12/15

<b>MATH-171 Elementary Functions and Coordinate Geometry - (LR) - 5 Units</b>					
<b>Prerequisite:</b> MATH-120 or two years of high school algebra.					
1224	MW	8:10-9:00am	AA-207	Hassanabadi, A	8/11 - 12/15
	TTH	8:10-9:30am			
1225	MW	10:10-11:00am	AA-137	Stanton, C	8/11 - 12/15
	TTH	9:40-11:00am			
1231	MW	1:10-2:00pm	AA-207	Lassonde, K	8/11 - 12/15
	TTH	12:40-2:00pm			
5347	TTH	2:40-5:00pm	AA-142	Stanton, C	8/11 - 12/15
1230	TTH	7:10-9:30pm	AA-143	O'Rourke, D	8/11 - 12/15

<b>MATH-180 Applied Calculus - (LR) - 4 Units</b>					
<b>Prerequisite:</b> MATH-120					
1983	MW	12:40-2:30pm	GE-108	Jones, L	8/11 - 12/15

<b>MATH-190 Analytic Geometry and Calculus - (LR) - 5 Units</b>					
<b>Prerequisite:</b> MATH-171 or both MATH-121 and MATH-135.					
4064	MW	8:10-9:00am	AA-137	Scott, G	8/11 - 12/15
	TTH	8:10-9:30am			
4065	MW	1:10-2:00pm	AA-211	VanHattum, S	8/11 - 12/15
	TTH	12:40-2:00pm			
4067	MW	2:40-5:00pm	AA-142	Lassonde, K	8/11 - 12/15
4066	TTH	7:10-9:30pm	AA-207	Jones, L	8/11 - 12/15

sec	days	hrs	rm	instr	dates
<b>MATH-191 Analytic Geometry and Calculus - (LR) - 4 Units</b>					
<b>Prerequisite:</b> MATH-190					
1253	MTWTH	11:10-12:00pm	AA-131	Cruz, E	8/11 - 12/15
3545	MTWTH	1:10-2:00pm	B-8	Cruz, E	8/11 - 12/15
3646	MW	7:10-9:00pm	AA-207	Nagel, C	8/11 - 12/15

<b>MATH-200 Introduction to Linear Algebra - (LR) - 4 Units</b>					
<b>Prerequisite:</b> MATH-191 may be taken concurrently.					
1261	MTWTH	10:10-11:00am	AA-207	Mead, T	8/11 - 12/15

<b>MATH-290 Analytic Geometry and Calculus III - (LR) - 5 Units</b>					
<b>Prerequisite:</b> MATH-191					
1263	MW	8:10-9:00am	AA-211	Stanton, C	8/11 - 12/15
	TTH	8:10-9:30am			
1264	MW	1:10-2:00pm	AA-205	Mead, T	8/11 - 12/15
	TTH	12:40-2:00pm			

<b>MATH-292 Introduction to Differential Equations - (LR) - 4 Units</b>					
<b>Prerequisite:</b> MATH-191.					
1265	MTWTH	1:10-2:00pm	AA-137	Stanton, C	8/11 - 12/15

<b>MATH-875N Supervised Mathematics Tutoring - (P/NP) - 0 Unit</b>					
1279			AA-210	Mead, T	8/11 - 12/15
For more information, please contact Terrill Mead (510) 215-3816					

## Media

<b>MEDIA-152 Introduction to Digital Film Production - (SC) - 3 Units</b>					
4626	T	9:40-12:30pm	A-1	Siler, M	8/11 - 12/15

<b>MEDIA-153 Intermediate to Digital Film Production - (SC) - 3 Units</b>					
<b>Prerequisite:</b> MEDIA 152					
4627	T	9:40-12:30pm	A-1	Siler, M	8/11 - 12/15

<b>MEDIA-165 Motion Graphic Design and Animation - (SC) - 3 Units</b>					
1228	TTH	12:40-3:00pm	A-1	Reece, R	8/11 - 12/15

sec	days	hrs	rm	instr	dates
-----	------	-----	----	-------	-------

## Medical Assisting and Office Technician

<b>MEDIC-150 Medical Terminology - (LR) - 3 Units</b>					
2228	M	9:40-12:30pm	AA-143	Staff, C	8/11 - 12/15
Section 2228 requires all first semester medical assisting students to attend a mandatory orientation on August 11 2:30-3:30pm in GE-112. Please bring your educational plan.					
4506	F	9:40-12:30pm	GE-113	Staff, C	8/11 - 12/15
Section 4506 requires all first semester medical assisting students to attend a mandatory orientation on August 11 2:30-3:30pm in GE-112. Please bring your educational plan.					

<b>Weekend</b>					
4610	S	9:40-12:30pm	GE-212	Staff, C	8/11 - 12/15
Section 4610 requires all first semester medical assisting students to attend a mandatory orientation on August 11 2:30-3:30pm in GE-112. Please bring your educational plan.					

<b>Online and Partially Online Sections</b>					
4611			PART-ONL	Reno, S	8/11 - 12/15
	S	12:40-3:30pm	GE-113		
Section 4611 requires all first semester medical assisting students to attend a mandatory orientation on August 11, 2016 from 2:30-3:30pm in GE-112. Please bring your educational plan. Section 4611 is offered in a partially online format with mandatory meetings on Saturdays 8/12, 8/19, 9/9, 10/7, 11/4, 12/2, and 12/9 from 12:40-3:30pm. Students will receive a college email prior to start of class regarding how the course works. For information contact sreno@contracosta.edu.					

<b>MEDIC-210 Medical Law, Ethics and Economics - (LR) - 3 Units</b>					
4492	F	9:40-12:30pm	GE-112	Staff, C	8/11 - 12/15

<b>MEDIC-223 Life Skills for the Healthcare Student - (LR) - 3 Units</b>					
4507	TH	8:40-11:30am	B-7	Staff, C	8/11 - 12/15
Section 4507 requires all first semester medical assisting students to attend a mandatory orientation on August 11 2:30-3:30pm in GE-112. Please bring your educational plan.					
3058	MTTHF	9:19-10:13am	DEANZAH	Riordan, F	8/11 - 12/15
Section 3058 is a dual enrollment course for students at DeAnza High School.					
4083	MTTHF	10:18-11:12am	DEANZAH	Riordan, F	8/11 - 12/15
Section 4083 is a dual enrollment course for students at DeAnza High School.					

<b>Short Term/Late Start</b>					
1694	MTTHF	11:17-12:11pm	DEANZAH	Riordan, F	8/11 - 12/15
Section 1694 is a dual enrollment course for students at DeAnza High School.					

<b>MEDIC-225 Medical Practice Management &amp; EHRs - (LR) - 4 Units</b>					
4510	TTH	1:40-3:00pm	HS-1	Staff, C	8/11 - 12/15
	M	1:10-4:00pm	GE-211		
Section 4510 requires all first semester medical assisting students to attend a mandatory orientation on August 11 2:30-3:30pm in GE-112. Please bring your educational plan.					

<b>MEDIC-226 Clinical Experience I - (LR) - 4 Units</b>					
<b>Prerequisite:</b> HHS-114, MEDIC-218,222,223,224 and BOT-200.					
4511	F	1:10-2:30pm	GE-112	Staff, C	8/11 - 12/15
Section 4511 Students enrolled in this class are required to complete an additional 16 hours by arrangement each week (lab portion) at an assigned health care facility, either Mondays and Wednesdays 8:30-5:30pm, or Tuesdays and Thursdays 8:30-5:30pm. The first mandatory campus meeting is on August 11 from 1:10-2:30pm in GE-112. Other on-campus mandatory meetings will be held on 8/18, 8/25, 9/15, 10/13, and 12/1 from 1:10-2:30pm in GE-112.					



sec	days	hrs	rm	instr	dates
Music					
<hr/>					
MUSIC-108	History and Appreciation of Western Music - (SC) - 3 Units				
3108	MW	9:40-11:00am	M-116	Day, C	8/11 - 12/15
<hr/>					
MUSIC-109	Applied Music: Individual Instruction - (SC) - .5-7.5 Units				
Prerequisite: Music-270, 250, or 258					
2213		Hours by arr		Austin, S	8/11 - 12/15
Section 2213 requires instructor consent. Audition on major instrument for faculty. Applied lesson arrangements and approval must be made during preceding semester in order to schedule appropriate faculty. (TBA, T 11-3:00). This course is 9-378 hours by arrangement (54 hours per 1 unit). For more information contact Stephanie Austin at (510)215-4824 or saustin@contracosta.edu.					
<hr/>					
MUSIC-119	Basic Music - (SC) - 3 Units				
4657	TTH	9:40-11:00am	M-104	Day, C	8/11 - 12/15
<hr/>					
MUSIC-120	Music Theory & Musicianship I - (SC) - 4 Units				
Advisory: Music-150					
1207	TTHF	3:10-4:00pm	M-112	Organ, W	8/11 - 12/15
			4:00-5:00pm		A-1A
<hr/>					
MUSIC-121	Music Theory and Musicianship II - (SC) - 4 Units				
prerequisite: MUSIC-120					
1208	TTHF	3:10-4:00pm	M-112	Organ, W	8/11 - 12/15
			4:00-5:00pm		A-1A
<hr/>					
MUSIC-130	Home Studio Recording - (SC) - 3 Units				
1040	TH	7:10-10:00pm	M-104	Walker, T	8/11 - 12/15
<hr/>					
MUSIC-150A	Beginning Piano: Fundamentals - (SC) - 2.5 Units				
1849	MW	9:40-11:00am	M-112	Griest, J	8/11 - 12/15
Section 1849 requires an additional hour by arrangement each week.					
3035	T	7:10-10:00pm	M-112	Randolph, A	8/11 - 12/15
Section 3035 requires an additional hour by arrangement each week.					
<hr/>					
MUSIC-150B	Beginning Piano: Technique - (SC) - 2.5 Units				
2218	T	7:10-10:00pm	M-112	Randolph, A	8/11 - 12/15
Section 2218 requires an additional hour by arrangement each week.					
<hr/>					
MUSIC-151A	Continuing Piano: Sight Reading - (SC) - 2.5 Units				
Prerequisite: MUSIC-150A or MUSIC-150B.					
4689	TTH	9:40-11:00am	M-112	Griest, J	8/11 - 12/15
Section 4689 requires an additional hour by arrangement each week.					
<hr/>					
MUSIC-151B	Continuing Piano: Technical Studies - (SC) - 2.5 Units				
Prerequisite: MUSIC-151A					
4690	TTH	9:40-11:00am	M-112	Griest, J	8/11 - 12/15
Section 4690 requires an additional hour by arrangement each week.					
<hr/>					
MUSIC-155A	Jazz Piano: Basic Grooves - (SC) - 2.5 Units				
1210	T	7:10-10:00pm	M-112	Randolph, A	8/11 - 12/15
Section 1210 requires an additional hour by arrangement each week.					
<hr/>					
MUSIC-155B	Jazz Piano: Basic Harmony - (SC) - 2.5 Units				
Prerequisite: Music 155A					
4155	T	7:10-10:00pm	M-112	Randolph, A	8/11 - 12/15
Section 4155 requires an additional hour by arrangement each week.					

sec	days	hrs	rm	instr	dates
<b>MUSIC-155C Jazz Piano: Beginning Improvisation - (SC) - 2.5 Units</b>					
Prerequisite: MUSIC-155B					
5083	T	7:10-10:00pm	M-112	Randolph, A	8/11 - 12/15
Section 5083 requires an additional hour by arrangement each week.					
<b>MUSIC-155D Jazz Piano: Beginning Accompaniment - (SC) - 2.5 Units</b>					
Prerequisite: MUSIC-155C					
5155	T	7:10-10:00pm	M-112	Randolph, A	8/11 - 12/15
Section 5155 requires an additional hour by arrangement each week.					
<b>MUSIC-163 Beginning Choir - (SC) - 1-5 Units</b>					
1104		M-116	Austin, S	8/11 - 12/15	
Section 1104 is 18-162 hours depending on the number of units (MW 12:40-1:30pm, MW 1:00-3:30pm, MTWTH 8:00-9:00am, MT 4:00-6:45pm enrolled. (18 hours lecture and/or 54 hours lab per 1 unit) See instructor for exact rehearsal times.					
<b>MUSIC-167 Vocal Chamber Music: CC Singers - (SC) - 1-5 Units</b>					
Prerequisite: MUSIC 163					
1114		M-116	Austin, S	8/11 - 12/15	
Section 1114 is 18-162 hours depending on the number of units (MW 12:40-1:30, MW 1:00-3:30, MTWTH 8:00-9:00, MT 4:00-6:45 enrolled. (18 hours lecture and/or 54 hours lab per 1 unit) See instructor for exact rehearsal times.					
<b>MUSIC-170 Beginning Group Voice - (SC) - 1-3 Units</b>					
1871	MW	11:10-12:30pm	M-116	Austin, S	8/11 - 12/15
Section 1871 is 18-108 hours depending on the number of units enrolled. (18 hours lecture and/or 54 hours lab per 1 unit).					
<b>MUSIC-171A Continuing Voice: Diction - (SC) - 1-3 Units</b>					
Prerequisite: MUSIC-170					
4820	MW	11:10-12:30pm	M-116	Austin, S	8/11 - 12/15
Section 4820 is 18-108 hours depending on the number of units enrolled. (18 hours lecture and/or 54 hours lab per unit).					
<b>MUSIC-171B Continuing Voice: Phonation - (SC) - 1-3 Units</b>					
Prerequisite: MUSIC-171A					
4821	MW	11:10-12:30pm	M-116	Austin, S	8/11 - 12/15
Section 4821 is 18-108 hours depending on the number of units enrolled. (18 hours lecture and/or 54 hours lab per 1 unit).					
<b>MUSIC-175A Jazz Voice: Interpretation - (SC) - 2.5 Units</b>					
1214	M	7:10-10:00pm	M-116	Letson, R	8/11 - 12/15
Section 1214 requires an additional hour by arrangement each week.					
<b>MUSIC-175B Jazz Voice: Rhythm Concepts - (SC) - 2.5 Units</b>					
Prerequisite: Music-175A					
1091	M	7:10-10:00pm	M-116	Letson, R	8/11 - 12/15
Section 1091 requires an additional hour by arrangement each week.					
<b>MUSIC-175C Jazz Voice: Tonal &amp; Texture Concepts - (SC) - 2.5 Units</b>					
Prerequisite: Music-175B					
4930	M	7:10-10:00pm	M-116	Letson, R	8/11 - 12/15
Section 4930 requires an additional hour by arrangement each week.					
<b>MUSIC-175D Jazz Voice: Bebop &amp; Improvisation - (SC) - 2.5 Units</b>					
Prerequisite: Music-175C					
4931	M	7:10-10:00pm	M-116	Letson, R	8/11 - 12/15
Section 4931 requires an additional hour by arrangement each week.					

sec	days	hrs	rm	instr	dates
<b>MUSIC-176 Vocal Jazz Music: Jazz Singers/Jazznova - (SC) - 1-5 Units</b>					
<b>Prerequisite:</b> Music-167					
1120			M-116	Austin, S	8/11 - 12/15
Section 1120 is 18-162 hours depending on the number of units (MW 12:40-1:30, MW 1:00-3:30, MTWTH 8:00-9:00, MT 4:00-6:45 enrolled. (18 hours lecture and/or 54 hours lab per 1 unit) See instructor for exact rehearsal times.					
<b>MUSIC-177 Commercial Vocal Ensemble: Jazz-Ology - (SC) - 1-5 Units</b>					
<b>Prerequisite:</b> MUSIC-176					
1126			M-116	Austin, S	8/11 - 12/15
Section 1126 is 18-162 hours depending on the number of units (MW 12:40-1:30, MW 1:00-3:30, MTWTH 8:00-9:00, MT 4:00-6:45 enrolled. (18 hours lecture and/or 54 hours lab per 1 unit) See instructor for exact rehearsal times.					
<b>MUSIC-190A Music Production: Fundamentals (Performance) - (SC) - .5-5.5 Units</b>					
4780		Hours by arr		Austin, S	8/11 - 12/15
Section 4780 is 9-189 hours by arrangement depending on the number of units enrolled. (18 hours lecture and/or 54 hours lab per 1 unit).					
<b>MUSIC-190B Music Production: Programming (Performance) - (SC) - .5-5.5 Units</b>					
4781		Hours by arr		Austin, S	8/11 - 12/15
Section 4781 is 9-189 hours by arrangement depending on the number of units enrolled. (18 hours lecture and/or 54 hours lab per 1 unit).					
<b>MUSIC-191A Perf. Projects: Classical Repertoire (Performance) - (SC) - .5-5.5 Units</b>					
4782		Hours by arr		Austin, S	8/11 - 12/15
Section 4782 is 9-189 hours by arrangement depending on the number of units enrolled. (18 hours lecture and/or 54 hours lab per 1 unit).					
<b>MUSIC-191B Perf. Projects: Jazz-Rock Repertoire (Performance) - (SC) - .5-5.5 Units</b>					
4783		Hours by arr		Austin, S	8/11 - 12/15
Section 4783 is 9-189 hours by arrangement depending on the number of units enrolled. (18 hours lecture and/or 54 hours lab per 1 unit).					
<b>MUSIC-222 Music Theory &amp; Musicianship III - (SC) - 4 Units</b>					
<b>Prerequisite:</b> Music-121 or the equivalent					
2216	TTHF	3:10-4:00pm	M-112	Organ, W 4:00-5:00pm	8/11 - 12/15 A-1A
<b>MUSIC-223 Music Theory &amp; Musicianship IV - (SC) - 4 Units</b>					
<b>Prerequisite:</b> Music-222 or the equivalent					
2217	TTHF	3:10-4:00pm	M-112	Organ, W 4:00-5:00pm	8/11 - 12/15 A-1A
<b>MUSIC-250A Intermediate Piano: Classical Repertoire - (SC) - 2.5 Units</b>					
<b>Prerequisite:</b> MUSIC-151B					
4691	TTH	9:40-11:00am	M-112	Griest, J	8/11 - 12/15
Section 4691 requires an additional hour by arrangement each week.					
<b>MUSIC-250B Inter. Piano: Baroque Repertoire - (SC) - 2.5 Units</b>					
<b>Prerequisite:</b> MUSIC-250A					
2250	TTH	9:40-11:00am	M-112	Griest, J	8/11 - 12/15
Section 2250 requires an additional hour by arrangement each week.					
<b>MUSIC-251 Advanced Piano Ensemble - (SC) - 2.5 Units</b>					
2512	TTH	9:40-11:00am	M-112	Griest, J	8/11 - 12/15
Section 2512 requires an additional hour by arrangement each week.					

sec	days	hrs	rm	instr	dates
<b>MUSIC-270A Inter. Voice: Italian Pronunciation - (SC) - 1-3 Units</b>					
<b>Prerequisite:</b> MUSIC-171B					
4822	MW	11:10-12:30pm	M-116	Austin, S	8/11 - 12/15
Section 4822 is 18-108 hours depending on the number of units enrolled. (18 hours lecture and/or 54 hours lab per 1 unit).					
<b>MUSIC-270B Inter. Voice: Bel Canto Singing - (SC) - 1-3 Units</b>					
<b>Prerequisite:</b> MUSIC-270A					
4824	MW	11:10-12:30pm	M-116	Austin, S	8/11 - 12/15
Section 4824 is 18-108 hours depending on the number of units enrolled. (18 hours lecture and/or 54 hours lab per 1 unit).					
<b>MUSIC-853N Chorale - (P/NP) - 0 Unit</b>					
3884	W	7:10-10:00pm	M-116	Montanero, J	8/11 - 12/15
Section 3884 requires an additional 18 hours by arrangement per semester.					
<b>MUSIC-854N Community Symphonic Wind Ensemble - (P/NP) - 0 Unit</b>					
3883	M	7:10-10:00pm	M-104	Gallegos, G	8/11 - 12/15
<b>Nursing</b>					
<b>NURS-198 Certified Nursing Assistant - (LR) - 7 Units</b>					
<b>Prerequisite:</b> ENGL-082, ENGL-084, or ESL-146 with a grade of "C" or better. or minimum score of 34 on college reading assessment test and minimum score 25 on college writing assessment test. Cardio Pulmonary Resuscitation (CPR): American Heart Association BLS course for the Healthcare Provider current card required.					
1634	TW	1:10-3:30pm	HS-3	Walters, J	8/15 - 11/17
	TW	4:10-7:00pm	HS-107		
	THF	1:10-7:30pm	OC		
First day of class, Tuesday, 8/15.					
<b>NURS-199 Home Health Aide - (SC) - 2 Units</b>					
<b>Prerequisite:</b> NURS-198					
<b>Short Term/Late Start</b>					
1159	MTW	1:10-4:00pm	HS-3	Walters, J	11/20 - 12/8
	THF	1:10-8:30pm	OC		
First day of class, Monday, 11/20.					
<b>NURS-205 Drug Dosage Calculations for Nursing Students - (LR) - 2 Units</b>					
2214	M	1:10-3:00pm	HS-101	Schaller, T	8/11 - 12/15
1212	M	6:10-8:00pm	HS-101	Schaller, T	8/11 - 12/15
<b>NURS-210 Fundamentals of Nursing - (LR) - 12 Units</b>					
<b>Prerequisite:</b> Admission to nursing program.					
<b>Corequisite:</b> NURS-211					
1221	MF	8:10-11:00am	HS-101	King-Jones, A	8/11 - 12/15
	TW	7:10-4:00pm	OC		
324 required laboratory hours; days and times vary according to clinical placement off-campus.					
<b>NURS-211 Developing Competency in Nursing Practice - (P/NP) - .6 Unit</b>					
<b>Prerequisite:</b> Admission to the nursing program.					
<b>Corequisite:</b> NURS-210					
<b>Short Term/Late Start</b>					
1245	TH	8:10-10:30am	HS-107A	Hernandez, M	9/14 - 12/14
Required: Skills lab kit. Students will be assigned to cohorts for the skills lab.					

sec	days	hrs	rm	instr	dates
-----	------	-----	----	-------	-------

### NURS-212 Pharmacology for Nurses - (LR) - 2 Units

**Advisory:** Recommend prior completion of BIOSC-134, BIOSC-132 and either BIOSC-119 or BIOSC-148

2114	W	5:40-7:30pm	HS-101	Salse, S	8/11 - 12/15
------	---	-------------	--------	----------	--------------

#### Online and Partially Online Sections

2115			PART-ONL	Salse, S	8/11 - 12/15
------	--	--	----------	----------	--------------

MTH	6:10-8:00pm	HS-3
-----	-------------	------

Section 2115 is offered in a partially online format with a mandatory meeting on Monday 8/14 from 6:10-8:00pm in HS-3. mandatory exams will be given on campus on the following dates: test #1 Thursday 9/7, test #2 Monday 10/16, test #3 Monday 11/13, test #4 Monday 12/11.

### NURS-230 Nursing Care of Women and Newborns - (LR) - 5.5 Units

**Prerequisite:** Admission to nursing program.

**Corequisite:** NURS-231

4254	M	10:40-1:00pm	HS-1	Wright, J	8/11 - 12/15
	T	7:10-4:00pm	OC		

Section 4254 is restricted to students with prior approval from nursing department. For more information, please contact the nursing department at (510) 215-4103.

### NURS-231 Competency in Nursing Practice - (P/NP) - .5 Unit

**Prerequisite:** Admission to the nursing program.

**Corequisite:** Nurs 230

6260	M	2:10-3:30pm	HS-107A	Wright, J	8/11 - 12/15
------	---	-------------	---------	-----------	--------------

Section 6260 is restricted to students with prior approval from the nursing department. For more information, please contact the nursing department at (510) 215-4103.

### NURS-235 Maternal-Child Health Nursing - (LR) - 11 unit

**Prerequisite:** PSYCH-126 or PSYCH-128; and NURS-205, NURS-210, NURS-211, NURS-212; and admission to the nursing program. **Corequisite:** NURS-236

3056	MF	10:40-1:00pm	HS-1	Wright, J	8/11 - 12/15
	THF	1:00-10:00pm	OC		

### NURS-236 Developing Competency in Nursing Practice - (P/NP) - 1 Unit

**Prerequisite:** Second semester students -NURS-205, 210, 211, and 212 or advanced placement standing in the nursing program. Third semester students - NURS-205, 210, 211, 212, 255, 256 or advanced placement standing in the nursing program.

1260	M	2:10-5:00pm	HS-107A	Wright, J	8/11 - 12/15
------	---	-------------	---------	-----------	--------------

Required: Skills lab kit.

### NURS-255 Intermediate Medical-Surgical and Psychiatric Nursing - (LR) - 11 unit

**Prerequisite:** NURS-205, 210, 211, 212, and admission to the nursing program.

**Corequisite:** NURS-256

1273	MF	8:10-10:30am	HS-1	Jacobs-Buster, F	8/11 - 12/15
	SSU	7:10-4:00pm	OC		

324 required laboratory hours; days and times vary according to clinical placement off-campus.

### NURS-256 Developing Competency in Nursing Practice - (P/NP) - 1 Unit

**Prerequisite:** Second semester students -NURS 205, 210, 211, and 212 or advanced placement standing in the nursing program. Third semester students - NURS 205, 210, 211, 212, 235, 236 or advanced placement standing in the nursing program.

1278	M	11:10-2:00pm	HS-107A	Hernandez, M	8/11 - 12/15
------	---	--------------	---------	--------------	--------------

Required: Skills lab kit.

sec	days	hrs	rm	instr	dates
-----	------	-----	----	-------	-------

## PE Intercollegiate

### PEIC-160 Intercollegiate Football - (LR) - 3 Units

1612	MTWTHF	4:40-6:30pm	GYM-ASTRO	Henderson, P	8/11 - 12/15
------	--------	-------------	-----------	--------------	--------------

### PEIC-162 Intercollegiate Men's Basketball - (LR) - 1.5 Units

Note: Played by men's intercollegiate rules.

#### Short Term/Late Start

6941	MTWTHF	3:10-5:00pm	GYM-GYM	Johnson, M	10/9 - 3/16
------	--------	-------------	---------	------------	-------------

### PEIC-180 Intercollegiate Men's Soccer - (LR) - 3 Units

1585	MTWTHF	5:10-7:00pm	GYM-SCFIELD	Ferguson, N	8/11 - 12/15
------	--------	-------------	-------------	-------------	--------------

### PEIC-181 Intercollegiate Women's Soccer - (LR) - 3 Units

1617	MTWTHF	7:10-9:00am	GYM-SCFIELD	Doshi, M	8/11 - 12/15
------	--------	-------------	-------------	----------	--------------

### PEIC-182 Intercollegiate Women's Basketball - (LR) - 1.5 Units

6900	MTWTHF	1:10-3:00pm	GYM-GYM	Shaw, V	10/9 - 3/16
------	--------	-------------	---------	---------	-------------

### PEIC-203 Intercollegiate Women's Volleyball - (LR) - 3 Units

1620	MTWTHF	5:10-7:00pm	GYM-GYM	Tianero, C	8/11 - 12/15
------	--------	-------------	---------	------------	--------------

### PEIC-290 Sport-Specific Training - (LR) - 1-2 Units

4041	MTWTH	1:10-2:30pm	GYM-BBFIELD	Guinn, B	8/11 - 12/15
------	-------	-------------	-------------	----------	--------------

Section 4041 is offered for 2 units.

4240	TWTH	3:40-5:00pm	GYM-BBFIELD	Gubbine, K	8/11 - 12/15
------	------	-------------	-------------	------------	--------------

Section 4240 is offered for 1.5 units.

#### Short Term/Late Start

4042	MTWTHF	1:10-2:25pm	GYM-GYM	Shaw, V	8/14 - 10/6
------	--------	-------------	---------	---------	-------------

Section 4042 is offered for 1 unit.

4043	MTWTHF	3:10-4:25pm	GYM-GYM	Johnson, M	8/14 - 10/6
------	--------	-------------	---------	------------	-------------

Section 4043 is offered for 1 unit.

1738	MTWTH	3:10-4:15pm	GYM-FIELD	Henderson, P	8/28 - 12/15
------	-------	-------------	-----------	--------------	--------------

Section 1738 is offered for 1.5 units.

## Philosophy

### PHILO-101 Introduction to Philosophy - (LR) - 3 Units

**Advisory:** ENGL-142B

5101	MW	11:10-12:30pm	B-8	Kilivris, M	8/11 - 12/15
------	----	---------------	-----	-------------	--------------

#### Online and Partially Online Sections

5102			ONLINE	Kilivris, M	8/11 - 12/15
------	--	--	--------	-------------	--------------

Section 5102 is an online course, all instruction will be online. You will receive a college email from your instructor prior to the class. For information email [mkilivris@contracosta.edu](mailto:mkilivris@contracosta.edu).

### PHILO-120 Introduction to Ethics - (SC) - 3 Units

**Advisory:** ENGL-142B

2131	MW	9:10-10:30am	ELC-103	Boyle, C	8/11 - 12/15
------	----	--------------	---------	----------	--------------

0207	TTH	11:10-12:30pm	M-111	Houston, D	8/11 - 12/15
------	-----	---------------	-------	------------	--------------

2586	TTH	12:40-2:00pm	M-104	Kilivris, M	8/11 - 12/15
------	-----	--------------	-------	-------------	--------------

1621	W	6:10-9:00pm	AA-103	Kabir, A	8/11 - 12/15
------	---	-------------	--------	----------	--------------

#### Online and Partially Online Sections

1131			ONLINE	Kilivris, M	8/11 - 12/15
------	--	--	--------	-------------	--------------

Section 1131 is an online course. All instruction will be online. Your instructor will send a college email to you prior to class. You may contact your instructor at [mkilivris@contracosta.edu](mailto:mkilivris@contracosta.edu).

sec	days	hrs	rm	instr	dates
<b>PHILO-130 Introduction to Critical Thinking - (SC) - 3 Units</b>					
0494	TTH	11:10-12:30pm	AA-135	Sharoki, S	8/11 - 12/15
0224	MW	12:40-2:00pm	AA-142	Sharoki, S	8/11 - 12/15
<b>Online and Partially Online Sections</b>					
4130			ONLINE	Kabir, A	8/11 - 12/15
Section 4130 is an online course. All instruction will be online. Your instructor will send a college email to you prior to class. You may contact your instructor at akabir@contracosta.edu.					

<b>PHILO-220 Comparative Religion - (SC) - 3 Units</b>					
1087	TTH	11:10-12:30pm	CTC-113	Wulferdingen, J	8/11 - 12/15

## Physical Education

<b>PE-098A Beginning Personal Growth in Fitness - (P/NP) - .5-2 Units</b>					
Please enroll into PE-0102A if you are being blocked from PE-098A. PE-0102A is the next level after completion of 098A.					
3621		Hours by arr	GA-30	Cumbo, S	8/11 - 12/15
Section 3621 is offered for 2 units and requires students to complete an online orientation at <a href="https://contracosta.instructure.com">https://contracosta.instructure.com</a> . Log on using your Insite username and password. Watch the fitness center instructional videos and complete four quizzes about proper usage of equipment. For more information, contact Sue Cumbo at <a href="mailto:scumbo@losmedanos.edu">scumbo@losmedanos.edu</a> . The fitness center is open MTWTH 9:00-11:00am and 1:00-4:00pm; F 9:00-11:00am. This course is open-entry/open-exit.					
4621		Hours by arr	GA-30	Cumbo, S	8/11 - 12/15
Section 4621 is offered for .5 unit and requires students to complete an online orientation at <a href="https://contracosta.instructure.com">https://contracosta.instructure.com</a> . Log on using your Insite username and password. Watch the fitness center instructional videos and complete four quizzes about proper usage of equipment. For more information, contact Sue Cumbo at <a href="mailto:scumbo@losmedanos.edu">scumbo@losmedanos.edu</a> . The fitness center is open MTWTH 9:00-11:00am and 1:00-4:00pm; F 9:00-11:00am. This course is open-entry/open-exit.					
6621		Hours by arr	GA-30	Cumbo, S	8/11 - 12/15
Section 6621 is offered for 1 unit and requires students to complete an online orientation at <a href="https://contracosta.instructure.com">https://contracosta.instructure.com</a> . Log on using your CCC Insite username and password. Watch the fitness center instructional videos and complete four quizzes about proper usage of equipment. For more information, contact Sue Cumbo at <a href="mailto:scumbo@losmedanos.edu">scumbo@losmedanos.edu</a> . The fitness center is open MTWTH 9:00-11:00am and 1:00-4:00pm; F 9:00-11:00am. This course is open-entry/open-exit.					

sec	days	hrs	rm	instr	dates
<b>PE-102A Beginning Fitness Training - (LR) - .5-2 Units</b>					
<b>NOTE:</b> Please enroll into PE-102B if you are being blocked from PE-102A. PE-102B is the next level after completion of PE-102 or 102A.					
1326		Hours by arr	GA-30	Cumbo, S	8/11 - 12/15
Section 1326 is offered for 2 units and requires students to complete an online orientation at <a href="https://contracosta.instructure.com">https://contracosta.instructure.com</a> . Log on using your CCC Insite username and password. Watch the fitness center instructional videos and complete four quizzes about proper usage of equipment. For more information, contact Sue Cumbo at <a href="mailto:scumbo@losmedanos.edu">scumbo@losmedanos.edu</a> . The fitness center is open MTWTH 9:00-11:00am and 1:00-4:00pm; F 9:00-11:00am. This course is open-entry/open-exit.					
4326		Hours by arr	GA-30	Cumbo, S	8/11 - 12/15
Section 4326 is offered for 0.5 unit and requires students to complete an online orientation at <a href="https://contracosta.instructure.com">https://contracosta.instructure.com</a> . Log on using your CCC Insite username and password. Watch the fitness center instructional videos and complete four quizzes about proper usage of equipment. For more information, contact Sue Cumbo at <a href="mailto:scumbo@losmedanos.edu">scumbo@losmedanos.edu</a> . The fitness center is open MTWTH 9:00-11:00am and 1:00-4:00pm; F 9:00-11:00am. This course is open-entry/open-exit.					
6326		Hours by arr	GA-30	Cumbo, S	8/11 - 12/15
Section 6326 is offered for 2 units and requires students to complete an online orientation at <a href="https://contracosta.instructure.com">https://contracosta.instructure.com</a> . Log on using your CCC Insite username and password. Watch the fitness center instructional videos and complete four quizzes about proper usage of equipment. For more information, contact Sue Cumbo at <a href="mailto:scumbo@losmedanos.edu">scumbo@losmedanos.edu</a> . The fitness center is open MTWTH 9:00-11:00am and 1:00-4:00pm; F 9:00-11:00am. This course is open-entry/open-exit.					
3102	TTH	6:40-8:00pm	GA-20	Creer, R	8/11 - 12/15
<b>Weekend</b>					
1020	S	6:40-8:00pm	GA-20	Creer, R	8/11 - 12/15

<b>PE-102B Intermediate Fitness Training - (LR) - .5-2 Units</b>					
<b>Prerequisite:</b> PE-102 or PE-102A					
0228		Hours by arr	GA-30	Cumbo, S	8/11 - 12/15
Section 0228 is offered for .5 unit and requires students to complete an online orientation at <a href="https://contracosta.instructure.com">https://contracosta.instructure.com</a> . Log on using your CCC Insite username and password. Watch the fitness center instructional videos and complete four quizzes about proper usage of equipment. For more information, contact Sue Cumbo at <a href="mailto:scumbo@losmedanos.edu">scumbo@losmedanos.edu</a> . The fitness center is open MTWTH 9:00-11:00am and 1:00-4:00pm; F 9:00-11:00am. This course is open-entry/open-exit.					
0229		Hours by arr	GA-30	Cumbo, S	8/11 - 12/15
Section 0229 is offered for 1 unit and requires students to complete an online orientation at <a href="https://contracosta.instructure.com">https://contracosta.instructure.com</a> . Log on using your CCC Insite username and password. Watch the fitness center instructional videos and complete four quizzes about proper usage of equipment. For more information, contact Sue Cumbo at <a href="mailto:scumbo@losmedanos.edu">scumbo@losmedanos.edu</a> . The fitness center is open MTWTH 9:00-11:00am and 1:00-4:00pm; F 9:00-11:00am. This course is open-entry/open-exit.					
3128	TTH	6:40-8:00pm	GA-20	Creer, R	8/11 - 12/15
<b>Weekend</b>					
1028	S	6:40-8:00pm	GA-20	Creer, R	8/11 - 12/15

<b>PE-102C Advanced Fitness Training - (LR) - .5-2 Units</b>					
<b>Prerequisite:</b> PE-102B					
0287		Hours by arr	GA-30	Cumbo, S	8/11 - 12/15
Section 0287 is offered for 1 unit and requires students to complete an online orientation at <a href="https://contracosta.instructure.com">https://contracosta.instructure.com</a> . Log on using your CCC Insite username and password. Watch the fitness center instructional videos and complete four quizzes about proper usage of equipment. For more information, contact Sue Cumbo at <a href="mailto:scumbo@losmedanos.edu">scumbo@losmedanos.edu</a> . The fitness center is open MTWTH 9am-11am and 1-4pm; F 9am-11am. This course is open-entry/open-exit.					
<b>Weekend</b>					
1029	S	6:40-8:00pm	GA-20	Creer, R	8/11 - 12/15



sec	days	hrs	rm	instr	dates
<b>PE-102D Master Level Fitness Training - (LR) - .5-2 Units</b>					
<b>Prerequisite:</b> PE-102C					
0348		Hours by arr	GA-30	Cumbo, S	8/11 - 12/15
Section 0348 is offered for 1 unit and requires students to complete an online orientation at <a href="https://contracosta.instructure.com">https://contracosta.instructure.com</a> . Log on using your CCC Insite username and password. Watch the fitness center instructional videos and complete four quizzes about proper usage of equipment. For more information, contact Sue Cumbo at <a href="mailto:scumbo@losmedanos.edu">scumbo@losmedanos.edu</a> . The fitness center is open MTWTH 9am-11am and 1-4pm; F 9am-11am. This course is open-entry/open-exit.					
<b>Weekend</b>					
1042	S	6:40-8:00pm	GA-20	Creer, R	8/11 - 12/15
<b>PE-105A Beginning Badminton - (LR) - 1 Unit</b>					
Please enroll into PE-105B if you are being blocked from PE-105A. PE-105B is the next level after completion of PE-105 or 105A.					
1658	TTH	9:40-11:00am	GYM-BADCRT	Johnson, M	8/11 - 12/15
<b>PE-105B Intermediate Badminton - (LR) - 1 Unit</b>					
<b>Prerequisite:</b> PE-105 or PE-105A					
1660	TTH	9:40-11:00am	GYM-BADCRT	Johnson, M	8/11 - 12/15
<b>PE-105C Advanced Badminton - (LR) - 1 Unit</b>					
<b>Prerequisite:</b> PE-105B or challenge skill demonstration.					
0513	TTH	9:40-11:00am	GYM-BADCRT	Johnson, M	8/11 - 12/15
<b>PE-105D Master Level Badminton - (LR) - 1 Unit</b>					
<b>Prerequisite:</b> PE-105C or challenge skill demonstration.					
0521	TTH	9:40-11:00am	GYM-BADCRT	Johnson, M	8/11 - 12/15
<b>PE-121A Beginning Aqua Calisthenics - (LR) - 1 Unit</b>					
1679	TTH	9:40-11:00am	GYM-POOL	Ulversoy, J	8/11 - 12/15
<b>PE-124A Beginning Aquatic Physical Conditioning - (LR) - 1 Unit</b>					
0068	TTH	9:40-11:00am	GYM-POOL	Ulversoy, J	8/11 - 12/15
<b>PE-126A Beginning Swimming - (LR) - .5-1 Unit</b>					
1744	TTH	12:40-2:00pm	GYM-POOL	Ulversoy, J	8/11 - 12/15
Section 1744 is offered for 1 unit.					
5045	MW	6:10-7:00pm	GYM-POOL	Ulversoy, J	8/28 - 11/29
Section 5045 is offered for .5 unit.					
<b>PE-126B Intermediate Swimming - (LR) - .5-1 Unit</b>					
<b>Prerequisite:</b> PE-126 or PE-126A					
1751	TTH	12:40-2:00pm	GYM-POOL	Ulversoy, J	8/11 - 12/15
Section 1751 is offered for 1 unit.					
5046	MW	6:10-7:00pm	GYM-POOL	Ulversoy, J	8/28 - 11/29
Section 5046 is offered for .5 unit.					
<b>PE-126C Advanced Swimming - (LR) - .5-1 Unit</b>					
<b>Prerequisite:</b> PE-127 or PE-126B					
1761	TTH	12:40-2:00pm	GYM-POOL	Ulversoy, J	8/11 - 12/15
Section 1761 is offered for 1 unit.					
5047	MW	6:10-7:00pm	GYM-POOL	Ulversoy, J	8/28 - 11/29
Section 5047 is offered for .5 unit.					
<b>PE-135A Beginning Tennis - (LR) - 1 Unit</b>					
Please enroll into PE-135B if you are being blocked from PE-135A. PE-135B is the next level after completion of PE-135 or 135A.					
2198	MW	9:40-11:00am	GYM-TENNCRT	Ferguson, N	8/11 - 12/15

sec	days	hrs	rm	instr	dates
<b>PE-135B Intermediate Tennis - (LR) - 1 Unit</b>					
<b>Prerequisite:</b> PE-135, PE-135A, or challenge skill demonstration.					
1745	MW	9:40-11:00am	GYM-TENNCRT	Ferguson, N	8/11 - 12/15
<b>PE-135C Advanced Tennis - (LR) - 1 Unit</b>					
<b>Prerequisite:</b> PE-135B or challenge skill demonstration.					
1749	MW	9:40-11:00am	GYM-TENNCRT	Ferguson, N	8/11 - 12/15
<b>PE-135D Master Level Tennis - (LR) - 1 Unit</b>					
<b>Prerequisite:</b> PE-135C or challenge skill demonstration.					
1850	MW	9:40-11:00am	GYM-TENNCRT	Ferguson, N	8/11 - 12/15
<b>PE-136A Beginning Competitive Swimming - (SC) - 1 Unit</b>					
Please enroll in PE-136B if you are being blocked from PE-136A. PE-136B is the next level after completion of PE-136 or 136A.					
1424	TTH	12:40-2:00pm	GYM-POOL	Ulversoy, J	8/11 - 12/15
<b>PE-156A Beginning Physical Conditioning - (LR) - 1 Unit</b>					
Please enroll in PE-156B if you are being blocked from PE-156A. PE-156B is the next level after completion of PE-156 or 156A.					
2153	TTH	4:10-5:30pm	GA-10	Sumner, A	8/11 - 12/15
<b>PE-156B Intermediate Physical Conditioning - (LR) - 1 Unit</b>					
<b>Prerequisite:</b> PE-156, PE-156A, or challenge skill demonstration.					
2154	TTH	4:10-5:30pm	GA-10	Sumner, A	8/11 - 12/15
<b>PE-156C Advanced Physical Conditioning - (LR) - 1 Unit</b>					
<b>Prerequisite:</b> PE-156B or skill demonstration.					
2156	TTH	4:10-5:30pm	GA-10	Sumner, A	8/11 - 12/15
<b>PE-165A Beginning Pilates - (LR) - 1 Unit</b>					
Please enroll in PE-165B if you are being blocked from PE-165A. PE-165B is the next level after completion of PE-165 or 165A.					
2921	TTH	11:10-12:30pm	GA-20	Sumner, A	8/11 - 12/15
Section 2921 is offered for 1 unit.					
<b>Weekend</b>					
1848	MWF	9:10-10:00am	GA-20	Ulversoy, J	8/11 - 12/15
Section 1848 is offered to Middle College High School students.					
<b>PE-165B Intermediate Pilates - (LR) - 1 Unit</b>					
<b>Prerequisite:</b> PE-165 PE-165A, or challenge skill demonstration.					
4925	TTH	11:10-12:30pm	GA-20	Sumner, A	8/11 - 12/15
<b>PE-165C Advanced Pilates - (LR) - 1 Unit</b>					
<b>Prerequisite:</b> PE-165B skill demonstration					
1376	TTH	11:10-12:30pm	GA-20	Sumner, A	8/11 - 12/15
<b>PE-165D Master Level Pilates - (LR) - 1 Unit</b>					
<b>Prerequisite:</b> PE-165C or challenge skill demonstration.					
1382	TTH	11:10-12:30pm	GA-20	Sumner, A	8/11 - 12/15
<b>PE-173A Beginning Zumba - (LR) - 1 Unit</b>					
Please enroll in PE-173B if you are being blocked from PE-173A. PE-173B is the next level after completion of PE-173A.					
0789	MWF	10:10-11:00am	GA-10	Solano, O	8/11 - 12/15
Section 0789 is offered to Middle College High School students.					

sec	days	hrs	rm	instr	dates
<b>PE-218A Beginning Slim, Trim and Swim - (LR) - .5-1 Unit</b>					
1093	TTH	9:40-11:00am	GYM-POOL	Ulversoy, J	8/11 - 12/15
6200	MW	6:10-7:00pm	GYM-POOL	Ulversoy, J	8/28 - 11/29
<b>PE-267A Beginning Cardio-Kickboxing - (LR) - 1 Unit</b>					
2194	TTH	4:10-5:30pm	GA-10	Sumner, A	8/11 - 12/15
<b>PE-270A Beginning Yoga - (LR) - 1 Unit</b>					
4270	MWF	8:10-9:00am	GA-20	Staff, C	8/11 - 12/15
Section 4270 is offered to Middle College High School students.					
5080	MW	11:10-12:30pm	GA-20	Flores, S	8/11 - 12/15
2195	TTH	12:40-2:00pm	GA-20	Frizzell, G	8/11 - 12/15
<b>PE-270B Intermediate Yoga - (LR) - 1 Unit</b>					
<b>Prerequisite:</b> PE-270A					
1032	MW	11:10-12:30pm	GA-20	Flores, S	8/11 - 12/15
1037	TTH	12:40-2:00pm	GA-20	Frizzell, G	8/11 - 12/15
<b>PE-273A Beginning Yoga for Strength - (LR) - 1 Unit</b>					
1074	MW	11:10-12:30pm	GA-20	Flores, S	8/11 - 12/15
Section 1074 is offered for 1 unit.					
1069	TTH	12:40-2:00pm	GA-20	Frizzell, G	8/11 - 12/15
Section 1069 is offered for .5 units.					

## Physics

<b>PHYS-110 Descriptive Physics - (SC) - 3 Units</b>					
2016	MWF	8:10-9:00am	PS-132	Staff, C	8/11 - 12/15
5674	MWF	11:10-12:00pm	PS-132	Liu, C	8/11 - 12/15
<b>PHYS-110L Descriptive Physics Laboratory - (SC) - 1.5 Units</b>					
<b>Corequisite/Prerequisite:</b> PHYS-10 <b>Advisory:</b> MATH-118					
5091	T	2:10-5:00pm	PS-19	Celesia, J	8/11 - 12/15
4998	W	2:10-5:00pm	PS-19	Liu, C	8/11 - 12/15
<b>PHYS-120 General College Physics I - (LR) - 4 Units</b>					
<b>Prerequisite:</b> MATH-171					
4999	MWF	12:40-2:00pm	PS-113	Liu, C	8/11 - 12/15
	M	1:40-4:30pm	PS-19		
<b>PHYS-120H General College Physics I (Honors) - (LR) - 4 Units</b>					
<b>Prerequisite:</b> MATH-180 or MATH-190					
5000	MWF	12:40-2:00pm	PS-113	Liu, C	8/11 - 12/15
	M	1:40-4:30pm	PS-19		
<b>PHYS-130 General Physics I - (LR) - 4 Units</b>					
<b>Prerequisite:</b> MATH-191 (may be taken concurrently)					
5003	MWTHF	10:10-11:00am	PS-132	Celesia, J	8/11 - 12/15
	T	9:40-12:30pm	PS-19		
<b>PHYS-230 General Physics II - (LR) - 4 Units</b>					
<b>Prerequisite:</b> PHYS-130 and MATH-290. MATH-290 may be taken concurrently.					
5014	MWF	11:10-12:00pm	PS-113	Wong, M	8/11 - 12/15
	T	11:10-12:00pm	PS-132		
	TH	9:40-12:30pm	PS-19		
5004	MWF	11:10-12:00pm	PS-113	Wong, M	8/11 - 12/15
	T	11:10-12:00pm	PS-132		
	TH	2:10-5:00pm	PS-19		

sec	days	hrs	rm	instr	dates
<b>Political Science</b>					
<b>POLSC-125 Government of the United States - (SC) - 3 Units</b>					
0861	MW	8:10-9:30am	GE-214	Landeros, M	8/11 - 12/15
2431	MW	9:40-11:00am	GE-214	Gonzales, V	8/11 - 12/15
1590	MW	11:10-12:30pm	GE-214	Gonzales, V	8/11 - 12/15
2531	TTH	12:40-2:00pm	GE-214	Gonzales, V	8/11 - 12/15
1586	TTH	2:10-3:30pm	GE-214	Gonzales, V	8/11 - 12/15
0866	TH	6:40-9:30pm	GE-214	Landeros, M	8/11 - 12/15
<b>Online and Partially Online Sections</b>					
0867			ONLINE	Landeros, M	8/11 - 12/15
Section 0867 is an online course. Your instructor will send a college email to you prior to class. You may contact your instructor at mlanderos@contracosta.edu.					
<b>POLSC-140 Introduction to International Relations - (LR) - 3 Units</b>					
1200	TTH	9:40-11:00am	B-12	Gonzales, V	8/11 - 12/15
<b>POLSC-225 Dynamics of African American Politics in America - (SC) - 3 Units</b>					
1713	MW	9:40-11:00am	GE-312	Hodge, C	8/11 - 12/15
This class is a part of the AFRAM Studies program.					

## Psychology

<b>PSYCH-118 Psychology of Individual and Group Behavior - (SC) - 3 Units</b>					
<b>Online and Partially Online Sections</b>					
1209			ONLINE	Perez, D	9/11 - 12/15
Section 1209 is an online course. All instruction will be online. You will receive a college email prior to the start of class. You may contact your instructor at dperez@contracosta.edu.					
<b>PSYCH-120 Human Sexuality - (SC) - 3 Units</b>					
1546	TTH	12:40-2:00pm	GE-310	Arnold, M	8/11 - 12/15
Section 1546 utilizes the college's course management system, and requires students to have computer access to obtain homework and supplemental materials integral to the course.					
0935	T	6:40-9:30pm	GE-113	Haq, S	8/11 - 12/15
Section 0935 utilizes the college's course management system, and requires students to have computer access to obtain homework and supplemental materials integral to the course.					
<b>PSYCH-122 Individual Adjustment - (SC) - 3 Units</b>					
3122	MW	8:10-9:30am	GE-111	Staff, C	8/11 - 12/15
Section 3122 utilizes the college's course management system, and requires students to have computer access to obtain homework and supplemental materials integral to the course.					
<b>PSYCH-126 Child Development - (SC) - 3 Units</b>					
0947	TTH	11:10-12:30pm	GE-310	Arnold, M	8/11 - 12/15
Section 0947 utilizes the college's course management system, and requires students to have computer access to obtain homework and supplemental materials integral to the course.					
1530	TTH	5:10-6:30pm	GE-312	Luckey, B	8/11 - 12/15
Section 1530 utilizes the college's course management system, and requires students to have computer access to obtain homework and supplemental materials integral to the course.					
<b>Online and Partially Online Sections</b>					
0367			PART-ONL	Luckey, B	8/24 - 11/16
	TH	6:40-9:30pm	GE-111		
Section 0367 is offered in a partially online format, with mandatory meetings on Thursdays, 8/24, 9/28, 10/26, and 11/16 6:40-9:30pm in GE-111. Students should contact bluckey@contracosta.edu.					

sec	days	hrs	rm	instr	dates
<b>PSYCH-128 Life Span Development - (LR) - 3 Units</b>					
4832	M	2:10-5:00pm	GE-111	Haq, S	8/11 - 12/15
Section 4832 utilizes the college's course management system, and requires students to have computer access to obtain homework and supplemental materials integral to the course.					
<b>Online and Partially Online Sections</b>					
1197			ONLINE	Ounjian, J	8/11 - 11/19
Section 1197 is an online course. All instruction will be online. All instruction will be online. You will receive a college email prior to the start of class. You may contact your instructor at <a href="mailto:jounjian@contracosta.edu">jounjian@contracosta.edu</a> .					
1700			ONLINE	Ounjian, J	9/11 - 12/15
Section 1700 is an online course. All instruction will be online. You will receive a college email prior to the start of class. You may contact your instructor at <a href="mailto:jounjian@contracosta.edu">jounjian@contracosta.edu</a> .					

<b>PSYCH-130 Psychology of Personality and Growth - (SC) - 3 Units</b>					
0957	TTH	9:40-11:00am	GE-111	Ounjian, J	8/11 - 12/15
Section 0957 utilizes the college's course management system, and requires students to have computer access to obtain homework and supplemental materials integral to the course.					
<b>Online and Partially Online Sections</b>					
1198			ONLINE	Ounjian, J	8/11 - 11/20
Section 1198 is an online course, with a mandatory online orientation. All instruction will be online. You will receive a college email prior to the start of class. You may contact your instructor at <a href="mailto:jounjian@contracosta.edu">jounjian@contracosta.edu</a> .					

<b>PSYCH-132 Introduction to Abnormal Psychology - (SC) - 3 Units</b>					
5978	M	6:40-9:30pm	GE-113	Greer, S	8/11 - 12/15

<b>PSYCH-150 Introduction to Biological Psychology - (LR) - 3 Units</b>					
<b>Prerequisite:</b> PSYCH-220 or equivalent <b>Advisory:</b> College level reading and writing skills.					
<b>Online and Partially Online Sections</b>					
1046			ONLINE	Arnold, M	9/11 - 12/11
Section 1046 is offered online with a mandatory online orientation. All instruction will be online. You will receive a college email prior to the start of class. You may contact your instructor at <a href="mailto:marnold@contracosta.edu">marnold@contracosta.edu</a> .					

<b>PSYCH-205B Introduction to Research Methods in Psychology - (LR) - 4 Units</b>					
<b>Prerequisite:</b> PSYCH-220 and MATH-164 <b>Advisory:</b> College level reading and writing skills.					
<b>Online and Partially Online Sections</b>					
2050			PART-ONL	Staff, C	8/11 - 12/15
	TTH	2:10-3:30pm	CTC-128		
Section 2050 is a partially online class, requires three hours online each week. PSYCH-205B utilizes the college's course management system, Canvas, and requires students to have computer access to obtain homework and supplemental materials integral to the course. You will receive a college email prior to the class.					

sec	days	hrs	rm	instr	dates
<b>PSYCH-220 General Psychology - (SC) - 3 Units</b>					
0960	TTH	8:10-9:30am	GE-312	Staff, C	8/11 - 12/15
Section 0960 utilizes the college's course management system, and requires students to have computer access to obtain homework and supplemental materials integral to the course.					
6821	MW	9:40-11:00am	GE-111	Ounjian, J	8/11 - 12/15
Section 6821 utilizes the college's course management system, and requires students to have computer access to obtain homework and supplemental materials integral to the course.					
2205	MW	11:10-12:30pm	GE-111	Ounjian, J	8/11 - 12/15
2210	TTH	11:10-12:30pm	GE-314	Ounjian, J	8/11 - 12/15
2223	W	2:10-5:00pm	GE-112	Buffo, S	8/11 - 12/15
3150	TTH	4:10-5:30pm	GE-113	Greer, S	8/11 - 12/15
Section 3150 utilizes the college's course management system, and requires students to have computer access to obtain homework and supplemental material integral to the course.					

<b>Online and Partially Online Sections</b>					
2226			ONLINE	Buffo, S	8/28 - 12/11
Section 2226 is an online course with a mandatory online orientation. All instruction will be online. You will receive a college email prior to the start of class. You may contact your instructor at <a href="mailto:sbuffo@contracosta.edu">sbuffo@contracosta.edu</a> .					
1603			PART-ONL	Luckey, B	9/1 - 12/1
	F	6:40-9:30pm	GE-111		
Section 1603 is offered in a partially online format and utilizes the college's course management system, and requires students to have computer access to obtain homework and supplemental materials integral to the course. Meeting dates: 9/1, 10/6, 11/3, 12/1 in GE-111.					
1960			ONLINE	Arnold, M	9/11 - 12/11
Section 1960 is offered online with a mandatory online orientation. All instruction will be online. You will receive a college email prior to the start of class. You may contact your instructor at <a href="mailto:marnold@contracosta.edu">marnold@contracosta.edu</a> .					
6822			ONLINE	Arnold, M	9/11 - 12/11
Section 6822 is offered online with a mandatory online orientation. All instruction will be online. You will receive a college email prior to the start of class. You may contact your instructor at <a href="mailto:marnold@contracosta.edu">marnold@contracosta.edu</a> .					

<b>PSYCH-222 Culture and Ethnicity in Social Psychology - (SC) - 3 Units</b>					
<b>Online and Partially Online Sections</b>					
2220			ONLINE	Ounjian, J	9/11 - 12/15
Section 2220 is an online course with a mandatory online orientation. All instruction will be online. You will receive a college email prior to the start of class. You may contact your instructor at <a href="mailto:jounjian@contracosta.edu">jounjian@contracosta.edu</a> .					

## Real Estate

<b>RE-160 Real Estate Principles - (LR) - 3 Units</b>					
3316	M	6:40-9:30pm	CTC-113	Borgognoni, R	8/11 - 12/15

<b>RE-163 Real Estate Practice - (LR) - 3 Units</b>					
0129	W	6:40-9:30pm	CTC-113	Borgognoni, R	8/11 - 12/15

## Social Science

<b>SOCSC-140 Contemporary Women - (LR) - 3 Units</b>					
0796	MW	8:10-9:30am	GE-110	Rahman, M	8/11 - 12/15

sec	days	hrs	rm	instr	dates
<b>Sociology</b>					

<b>SOCIO-130</b>	<b>Introduction to Marriage and Family - (LR) - 3 Units</b>				
1246	TTH	8:10-9:30am	GE-110	Rahman, M	8/11 - 12/15

<b>SOCIO-142    Introduction to Gender - (LR) - 3 Units</b>					
<b>Short Term/Late Start</b>					
1651	TTH	4:00-6:50pm	GE-108	Walker, B	10/10 - 12/14

<b>SOCIO-220</b>	<b>Introduction to Sociology - (LR) - 3 Units</b>				
0888	MW	9:40-11:00am	GE-110	Cromartie, J	8/11 - 12/15
0890	MW	11:10-12:30pm	GE-110	Cromartie, J	8/11 - 12/15
1145	TTH	11:10-12:30pm	GE-110	Cromartie, J	8/11 - 12/15
1147	MW	12:40-2:00pm	GE-110	Cromartie, J	8/11 - 12/15
0892	TTH	12:40-2:00pm	GE-110	Cromartie, J	8/11 - 12/15

#### Online and Partially Online Sections

1250			PART-ONL	Cromartie, J	8/18 - 10/20
F		6:40-9:30pm	GE-110		

Section 1250 is offered in a partially online format with mandatory meetings on 8/18, 8/25, 9/8, 9/15, 10/13, and 10/20 from 6:40 to 9:30pm in GE-110. In addition to attending these six mandatory class meetings on campus, students will view videos on the internet, prepare for in-class examinations, and complete written assignments outside of class.

<b>SOCIO-221</b>	<b>Social Problems - (SC) - 3 Units</b>				
2397	TTH	9:40-11:00am	GE-110	Cromartie, J	8/11 - 12/15

<b>SOCIO-222 Introduction to Research Methods - (LR) - 3 Units</b>					
<b>Prerequisite:</b> SOCIO-220					
2229	F	9:10-12:00pm	GE-110	Staff, C	8/11 - 12/15

SOCIO-234 Intro to Statistics in Social Sciences Social Sciences - (LR) - 3 Units					
Prerequisite: MATH-120					
3234	TH	7:10-10:00pm	GE-110	Staff, C	8/11 - 12/15

<b>SOCIO-245</b>	<b>Sociology of Race and Ethnicity - (SC) - 3 Units</b>				
2398	W	6:40-9:30pm	GE-110	Rahman, M	8/11 - 12/15

## Spanish

<b>SPAN-120</b>	<b>First-Semester Spanish - (SC) - 5 Units</b>				
5714	MW	8:40-11:00am	AA-113	Stefanova, I	8/11 - 12/15
1222	TTH	8:40-11:00am	GE-108	Stefanova, I	8/11 - 12/15

<b>SPAN-121 Second-Semester Spanish - (SC) - 5 Units</b>					
<b>Prerequisite:</b> SPAN-120 with minimum grade C or placement test score at SPAN-121 level.					
1223	MW	11:10-1:30pm	AA-133	Stefanova, I	8/11 - 12/15
<b>Prerequisite:</b> SPAN-120 or placement at SPAN-121					

level. If you have not taken the prerequisite course but you believe you meet the requirements for entry into SPAN-121, please contact Prof. Irena Stefanova at [istefanova@contracosta.edu](mailto:istefanova@contracosta.edu) or at 510-215-4134 for information on how to challenge the pre-requisite.

sec	days	hrs	rm	instr	dates
-----	------	-----	----	-------	-------

<b>SPAN-220 Third-Semester Spanish - (SC) - 5 Units</b>					
<b>Prerequisite:</b> SPAN-121, min grade C. or placement test score at SPAN-220 level.					
1095	TTH	11:10-1:30pm	ELC-103	Stefanova, I	8/11 - 12/15
<b>Prerequisite:</b> SPAN-121 or placement at SPAN-220					

level. If you have not taken the prerequisite course but you believe you meet the requirements for entry into SPAN-220, please contact Prof. Irena Stefanova at [istefanova@contracosta.edu](mailto:istefanova@contracosta.edu) or at 510-215-4134 for information on how to challenge the prerequisite.

<b>SPAN-221 Fourth-Semester Spanish - (SC) - 5 Units</b>					
<b>Prerequisite:</b> SPAN-220 with minimum grade C or placement test score at SPAN-221 level.					
1115	TTH	11:10-1:30pm	ELC-103	Stefanova, I	8/11 - 12/15
<b>Prerequisite:</b> SPAN-220 or placement at SPAN-221 level. If you have not taken the prerequisite course but you believe you meet the requirements for entry into SPAN-221, please contact Prof. Irena Stefanova at <a href="mailto:istefanova@contracosta.edu">istefanova@contracosta.edu</a> or at 510-215-4134 for information on how to challenge the prerequisite.					

<b>SPAN-230 Spanish for Heritage Speakers I - (SC) - 5 Units</b>					
<b>Prerequisite:</b> SPAN-121 with minimum grade C.					
4230	TTH	8:40-11:00am	M-111	French-Rafael, J	8/11 - 12/15
<b>Prerequisite:</b> SPAN-121 or placement at SPAN-220 level. If you have not taken the prerequisite course but you believe you meet the requirements for entry into SPAN-230, please contact Prof. Irena Stefanova at <a href="mailto:istefanova@contracosta.edu">istefanova@contracosta.edu</a> or at 510-215-4134 for information on how to challenge the pre-requisite.					

## Speech

<b>SPCH-120</b>	<b>Public Speaking - (SC) - 3 Units</b>				
6237	TTH	8:10-9:30am	AA-113	Kane, J	8/11 - 12/15
2577	TTH	9:40-11:00am	AA-145	Kane, J	8/11 - 12/15
2066	MW	11:10-12:30pm	AA-113	Kellner, N	8/11 - 12/15
2067	TTH	11:10-12:30pm	AA-143	Padmanabhan, C	8/11 - 12/15
3680	TTH	11:10-12:30pm	AA-142	Kane, J	8/11 - 12/15

6183	MW	12:40-2:00pm	AA-145	Kellner, N	8/11 - 12/15
3582	TTH	12:40-2:00pm	AA-113	Carver, J	8/11 - 12/15
0247	M	6:10-9:00pm	HERCHS	Giusto, L	8/11 - 12/15
Section 0247 will be held at Hercules Middle School in room 510.					
3155	F	8:10-2:00pm	AA-103	Bauer, D	10/6 - 12/15
Section 3155 is a late-start class that meets on Fridays, beginning on 10/6					

<b>Online and Partially Online Sections</b>					
6238			ONLINE	Dwiggins-Beeler, R	8/11 - 10/6
Section 6238 is offered in a fully online format. Course information will be sent to your Insite email prior to the class start date. For more information, contact the instructor at <a href="mailto:rdwiggins@contracosta.edu">rdwiggins@contracosta.edu</a> .					
2564			PART-ONL	Bauer, D	8/15 - 10/10
	T	6:10-9:00pm	AA-113		
Section 2564 is offered in a partially online format with mandatory meetings on Tuesdays 8/15, 8/22, 8/29, 9/5, and 9/12 from 6:10-9pm in AA-113.					
6239			ONLINE	Dwiggins-Beeler, R	10/6 - 12/15
Section 6239 is offered in a fully online format. Course information will be sent to your Insite email prior to the class start date. For more information, contact the instructor at <a href="mailto:rdwiggins@contracosta.edu">rdwiggins@contracosta.edu</a> .					
5710			PART-ONL	Dwiggins-Beeler, R	10/12 - 12/15
	TH	6:10-9:00pm	AA-145		
Section 5710 is offered in a partially online format with mandatory meetings on Thursdays 10/12, 10/19, 10/26, 11/2, and 11/9 6:10-9:00pm in AA-145.					



sec	days	hrs	rm	instr	dates
-----	------	-----	----	-------	-------

**SPCH-121 Critical Thinking and Persuasion - (LR) - 3 Units**

**Advisory:** ENGL-001A or SPCH 120.

6700	TTH	9:40-11:00am	AA-113	Padmanabhan, C	8/11 - 12/15
3121	W	6:10-9:00pm	HERCHS	Giusto, L	8/11 - 12/15

Section 3121 will be held at Hercules Middle School in room 510.

**SPCH-121I Critical Thinking and Persuasion (igetc) - (LR) - 3 Units**

**Prerequisite:** English 1A with a grade of C or better

6701	TTH	9:40-11:00am	AA-113	Padmanabhan, C	8/11 - 12/15
3124	W	6:10-9:00pm	HERCHS	Giusto, L	8/11 - 12/15

Section 3124 will be held at Hercules Middle School in room 510.

**SPCH-122 Intercultural Communication - (SC) - 3 Units**

1605	MW	9:40-11:00am	GE-104	Kellner, N	8/11 - 12/15
5912	TTH	11:10-12:30pm	AA-113	Carver, J	8/11 - 12/15

**Online and Partially Online Sections**

1058			ONLINE	Bauer, D	8/11 - 12/15
------	--	--	--------	----------	--------------

Section 1058 is offered in an online format with a mandatory online orientation. All instruction will be online. For information contact the instructor at bauer@contracosta.edu.

**SPCH-128 Interpersonal Communication - (LR) - 3 Units**

2096	TTH	11:10-12:30pm	AA-133	Perez, J	8/11 - 12/15
2113	TH	6:40-9:30pm	AA-113	Frey, M	8/11 - 12/15

**Online and Partially Online Sections**

5726			PART-ONL	Frey, M	8/23 - 10/11
	W	6:10-9:00pm	AA-113		

Section 5726 is offered in a partially online format with mandatory meetings on Wednesdays 8/23, 8/30, and 10/4 from 6:10-9:00pm in AA-113.

2579			PART-ONL	Frey, M	10/18 - 11/29
	W	6:10-9:00pm	AA-113		

Section 2579 is offered in a partially online format with mandatory meetings on Wednesdays 10/18, 10/25, and 11/29 from 6:10 to 9:00pm in AA 113.

**SPCH-141 Argumentation & Debate - (SC) - 3 Units**

8223	TTH	2:10-3:30pm	AA-113	Carver, J	8/11 - 12/15
------	-----	-------------	--------	-----------	--------------

**SPCH-160A Speaking in the Community - (SC) - 1-3 Units**

6508	W	12:40-5:30pm	AA-113	Carver, J	8/11 - 12/15
------	---	--------------	--------	-----------	--------------

Section 6508 requires enrollment for a minimum of **1 unit**: must attend a minimum of 18 hours lecture or 54 hours laboratory. This course is open-entry/open-exit.

**SPCH-160B Forensics - (SC) - 1-3 Units**

6509	W	12:40-5:30pm	AA-113	Carver, J	8/11 - 12/15
------	---	--------------	--------	-----------	--------------

Section 6509 requires enrollment for a minimum of **1 unit**: students may register for up to 3 units. For 1 unit, students must attend a minimum of 18 hours lecture or 54 hours laboratory. This course is open-entry/open-exit.

sec	days	hrs	rm	instr	dates
-----	------	-----	----	-------	-------

**Tutoring**

**TUTR-200 Peer Tutoring Certification Level One - (SC) - .5 Unit**

**Weekend**

1695	S	10:10-1:00pm	GE-104	Gibson, B	9/23 - 10/21
------	---	--------------	--------	-----------	--------------

Section 1695 meets Saturdays, 9/23, 10/7, and 10/21. For additional information, please contact Brandy Gibson at bgibson@contracosta.edu.

**TUTR-201 Peer Tutoring Certification Level Two - (SC) - .5 Unit**

**Weekend**

1699	S	10:10-1:00pm	GE-104	Gibson, B	9/23 - 10/21
------	---	--------------	--------	-----------	--------------

Section 1699 meets Saturdays, 9/23, 10/7 and 10/21. For additional information, please contact Brandy Gibson at bgibson@contracosta.edu.

**Community Education Course**

**Badminton Recreational and Competitive Badminton**

This course is designed for badminton players at all levels of expertise to practice and improve their competitive badminton skills in friendly and supportive surroundings with 10 high-quality courts to play on. Students, please sign-up with instructor(s) at the class meetings.

**Mondays:** August 14 - December 11, 7:00-10:00pm, no class on September 4.

**Where:** CCC GYM

Instructor/s: Hok Gouw, John Hollender and Ed Tseng

Fees: \$10/session; \$3.00/evening drop-in fee.

# Online Courses FALL 2017

These courses are offered online. Reference the course listings on previous pages for more information or email the instructor. Check your 4cd.edu email regularly for course updates and instructions.

**Key:** **O** = All instruction is online **P** = Course is partially online, some in-person meetings required

KEY	PROGRAM	CLASS NAME	SECTION	INSTRUCTOR	DATES	INSTRUCTOR'S EMAIL
O	ADJUS-120	Introduction to Administration of Justice	3423	Ramos, R	8/11 - 12/15	rramos@contracosta.edu
O	ADJUS-122	Criminal Procedures	3427	Ramos, R	8/11 - 12/15	rramos@contracosta.edu
O	ADJUS-135	Law and Democracy	2173	McCarty-Snead, S	8/11 - 12/15	smccarty@contracosta.edu
O	ADJUS-221	Legal Aspects of Evidence	3419	Ramos, R	8/11 - 12/15	rramos@contracosta.edu
O	ANTHR-140	Introduction to Physical Anthropology	0946	Schwappach-Shirriff, L	8/11 - 12/15	lschwappach-shirriff@contracosta.edu
O	ART-117	Appreciation of Art & Architecture	0864	Holt, B	8/11 - 12/15	bholt@contracosta.edu
O	ART-132	Digital Art - Beginning I	3132	Gordon, C	8/11 - 12/15	cgordon@contracosta.edu
O	ART-194	Survey of Asian Arts	1418	Holt, B	8/29 - 12/15	bholt@contracosta.edu
P	BUS-186	Principles of Accounting I	1727	Viertel, C	8/11 - 12/15	cviertel@contracosta.edu
P	BUS-187	Principles of Accounting II	1728	Viertel, C	8/11 - 12/15	cviertel@contracosta.edu
P	CHEM-119	Introductory Chemistry	2124	Dang, T	8/11 - 12/15	tdang@contracosta.edu
P	CHIN-120	First-Semester Mandarin	1234	Teng, Y	8/11 - 12/15	yteng@contracosta.edu
P	CHIN-121	Second-Semester Mandarin	1090	Teng, Y	8/11 - 12/15	yteng@contracosta.edu
O	COUNS-108	Introduction to Educational Planning	1714	Boland Drain, S	8/14 - 8/21	sboland@contracosta.edu
O			2681	Boland Drain, S	12/1 - 12/8	sboland@contracosta.edu
O	COUNS-120	Managing College Success & Life Transitions	1710	Perez, D	8/11 - 12/15	dperez@contracosta.edu
O	COUNS-140	Job Search Strategies	4440	Boland Drain, S	10/9 - 12/13	sboland@contracosta.edu
P	DANCE-101	Introduction to Dance	1497	Tigner, L	10/13 - 12/15	ltigner@contracosta.edu
O	DRAMA-101	Introduction to Theatre	0735	Chavarria, C	8/28 - 12/15	cchavarria@contracosta.edu
O	DRAMA-103	Hist of Theatre: Pre-Greek-17th Century	3103	Chavarria, C	8/11 - 12/15	cchavarria@contracosta.edu
P	ECHD-120	Introduction to Principles & Practices Of Early Childhood Education	6999	Moore, S	8/11 - 12/15	smoore@contracosta.edu
P	ECHD-840N	Parent Education	2898	Benson, G	9/8 - 11/3	gbenson@contracosta.edu
O	ENGL-001A	Composition and Reading	1285	Eubanks, R	8/11 - 12/15	reubanks@contracosta.edu
O			4086	Nahas, L	8/11 - 12/15	lnahas@contracosta.edu
O			4087	Hansen, J	8/11 - 12/15	jhansen@contracosta.edu
O			1352	Eubanks, R	10/6 - 12/15	reubanks@contracosta.edu
O	GEOG-130	Cultural Geography	1703	Schillo, N	9/11 - 12/15	Nschillo@contracosta.edu
O	HED-115	Applied Nutrition	1440	Goehring, B	9/25 - 12/15	bgoehring@contracosta.edu
O	HED-120	Education for Healthful Living	0857	Johnson, M	8/11 - 12/15	mjohnson@contracosta.edu
O			5713	Ferguson, N	8/11 - 12/15	nferguson@contracosta.edu
O			3721	Ferguson, N	9/25 - 12/15	nferguson@contracosta.edu
P	HIST-120	History of the U.S. (Colonial - 1865)	1168	Tirado, P	8/11 - 12/15	ptirado@contracosta.edu
P	HIST-127	History of Latinos in the U.S. (1846 - Present)	1990	Palacios, A	8/24 - 12/14	
P	HIST-140	History of Western Civilization to the Renaissance	1333	Story, M	10/14 - 12/2	mstory@contracosta.edu
O	KINES-190	Introduction to Kinesiology	3190	Ferguson, N	10/16 - 12/15	nferguson@contracosta.edu

KEY	PROGRAM	CLASS NAME	SECTION	INSTRUCTOR	DATES	INSTRUCTOR'S EMAIL
P	KINES-191	Elementary Physical Education	2191	Valdehueva, T	10/16 - 12/11	tvaldehueva@contracosta.edu
O	KINES-197	Human Development Throughout the Lifespan	1323	Greenberg, M	9/25 - 12/15	mgreenberg@dvc.edu
P	KINES-199	Personal Fitness Training	1672	Barber, J	10 - 12/12	jbarber@contracosta.edu
P	LARAZ-113	Introduction to Analysis of	1133	Palacios, A	8/25 - 12/15	apalacios@contracosta.edu
P	LARAZ-127	History of Latinos in the U.S. (1846 - Present)	1991	Palacios, A	8/24 - 12/14	apalacios@contracosta.edu
P	LIBST-110A	Library and Information Research Skills	2916	Choi, A	8/11 - 12/15	achoi@contracosta.edu
P			2906	Jan, D	8/16 - 10/10	djan@contracosta.edu
P			2907	Williams, A	9/9 - 11/3	awilliams@contracosta.edu
P			2908	Becvar, K	9/21 - 11/15	kbecvar@contracosta.edu
P	MATH-118	Elementary Algebra	5348	Bersano, E	8/11 - 12/15	ebersano@contracosta.edu
P	MATH-120	Intermediate Algebra	5349	Lassonde, K	8/11 - 12/15	klassonde@contracosta.edu
P			1183	Bersano, E	8/11 - 12/15	ebersano@contracosta.edu
O	MATH-164	Introduction to Probability and Statistics	1130	Nguyen, T	8/11 - 12/15	tnguyen@contracosta.edu
O			1582	Nguyen, T	12/12 - 1/11	tnguyen@contracosta.edu
P	MEDIC-150	Medical Terminology	4611	Reno, S	8/11 - 12/15	sreno@contracosta.edu
P	NURS-212	Pharmacology for Nurses	2115	Salse, S	8/11 - 12/15	ssalse@contracosta.edu
O	PHILO-101	Introduction to Philosophy	5102	Kilivris, M	8/11 - 12/15	mkilivris@contracosta.edu
O	PHILO-120	Introduction to Ethics	1131	Kilivris, M	8/11 - 12/15	mkilivris@contracosta.edu
O	PHILO-130	Introduction to Critical Thinking	4130	Kabir, A	8/11 - 12/15	akabir@contracosta.edu
O	POLSC-125	Government of the United States	0867	Landeros, M	8/11 - 12/15	mlanderos@contracosta.edu
O	PSYCH-118	Psychology of Individual and Group Behavior	1209	Perez, D	9/11 - 12/15	dperez@contracosta.edu
P	PSYCH-126	Child Development	0367	Luckey, B	8/24 - 11/16	Bluckey@contracosta.edu
O	PSYCH-128	Life Span Development	1197	Ounjian, J	8/11 - 11/19	Jounjian@contracosta.edu
O			1700	Ounjian, J	9/11 - 12/15	Jounjian@contracosta.edu
O	PSYCH-130	Psychology of Personality and Growth	1198	Ounjian, J	8/11 - 11/20	Jounjian@contracosta.edu
O	PSYCH-150	Introduction to Biological Psychology	1046	Arnold, M	9/11 - 12/11	marnold@contracosta.edu
P	PSYCH-205B	Introduction to Research Methods in Psychology	2050	Staff, C	8/11 - 12/15	
O	PSYCH-220	General Psychology	2226	Buffo, S	8/28 - 12/11	sbuffo@contracosta.edu
P			1603	Luckey, B	9/1 - 12/1	bluckey@contracosta.edu
O			1960	Arnold, M	9/11 - 12/11	marnold@contracosta.edu
O			6822	Arnold, M	9/11 - 12/11	marnold@contracosta.edu
O	PSYCH-222	Culture and Ethnicity in Social Psychology	2220	Ounjian, J	9/11 - 12/15	Jounjian@contracosta.edu
P	SOCIO-220	Introduction to Sociology	1250	Cromartie, J	8/18 - 10/13	jcromartie@contracosta.edu
O	SPCH-120	Public Speaking	6238	Dwiggins-Beeler, R	8/11 - 10/6	rdwiggins@contracosta.edu
P			2564	Carver, J	8/15 - 10/10	jcarver@contracosta.edu
O			6239	Dwiggins-Beeler, R	10/6 - 12/15	rdwiggins@contracosta.edu
P			5710	Dwiggins-Beeler, R	10/12 - 12/15	rdwiggins@contracosta.edu
O	SPCH-122	Intercultural Communication	1058	Bauer, D	8/11 - 12/15	dbauer@contracosta.edu
P	SPCH-128	Interpersonal Communication	5726	Frey, M	8/23 - 10/11	mfrey@contracosta.edu
P			2579	Frey, M	10/18 - 11/29	mfrey@contracosta.edu



# CONTRA COSTA COLLEGE

## BUILDINGS, GROUNDS & PARKING

2600 MISSION BELL DRIVE

SAN PABLO, CA 94806



**NOTE:** ADA pathways  
are marked in bright red.

### SERVICES

Admissions & Records  
Assessment Center  
Athletics Office  
Bookstore  
Buildings & Grounds  
Business Office  
Campus Police  
Campus Dining  
• Aqua Terra Grill  
• Pronto  
• Student Cafeteria  
Cashier  
Center for Science Excellence  
Child Care Center  
Counseling  
Custodial Services

### ROOM

SSC-115  
SSC-104  
GA-90  
SAB-170  
R  
SAB-208  
CP  
SAB-130  
SAB-147  
SAB-159  
SSC-115  
PS-109  
ELC  
SSC-108  
C

### SERVICES

Disabled Students  
Programs & Services  
Economic & Workforce Development  
EOPS/CARE & CalWORKS  
Financial Aid  
Gateway to College  
International Students Office  
Middle College High School  
President's Office  
Scholarships  
Student Life/ASU  
Student Lounge  
Title IX Coordinator  
Tutoring  
Veterans Affairs  
Welcome Center

### ROOM

SSC-109  
SAB-223  
SSC-106  
SSC-102  
AA-219  
SSC-110  
AA-103B  
SAB-205  
SSC-102  
SAB-100  
SAB-120  
SAB-221  
LLRC-121  
SAB-109  
SSC-111

### BUILDING NAME

AA Applied Arts  
A Art  
AT Automotive Technology  
B Biological Sciences  
C Custodial  
CP Campus Police  
CTC Computer Technology Center  
ELC Early Learning Center  
FH Fireside Hall  
G Gymnasium  
GA Gym Annex (Athletic Office)  
GE General Education  
HS Health Sciences  
LA Liberal Arts  
LLRC Library and Learning Resource  
Center  
ML Men's Locker Room  
M Music  
PAC/KNOX John and Jean Knox  
Performing Arts Center  
PS Physical Sciences  
R Receiving/Buildings & Grounds  
SAB Student & Administration  
Building  
SSC Student Services Center:  
Admissions, Counseling,  
Financial Aid and Welcome Center  
WL Women's Locker Room