

Log into *Insite Portal*  
 1) Click *Student Planning*

2) Select *Student Planning*  
 3) Click #2 *Plan & Register*

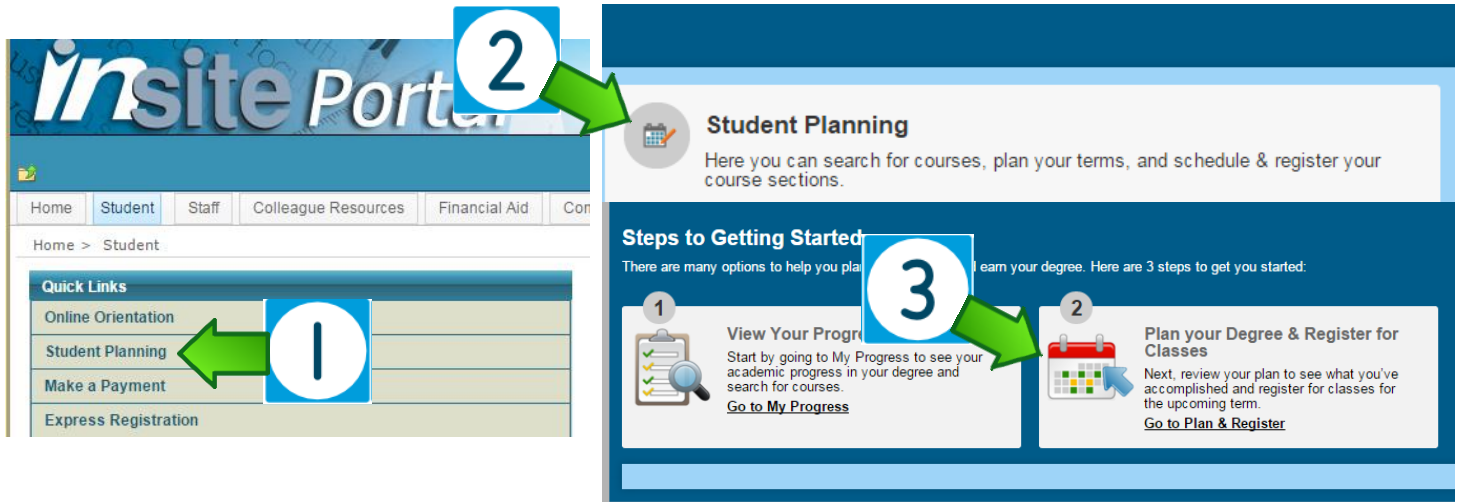

4) Search classes in *Course Search* (at top right of page)

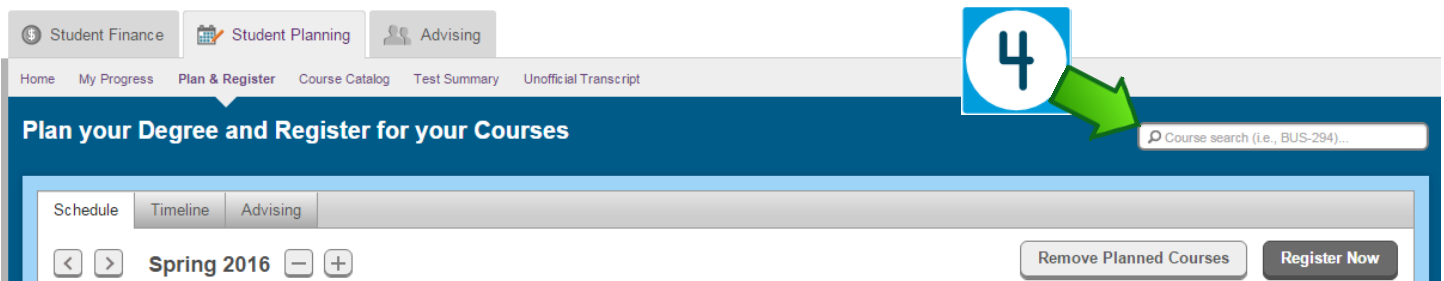

5) Click *Add Course to Plan*

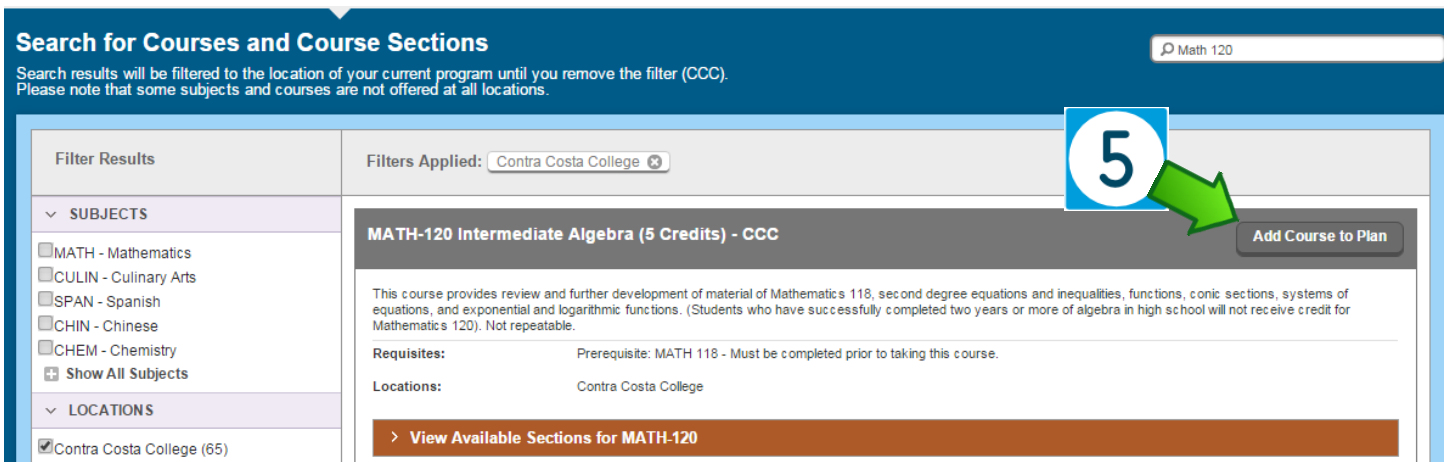

6) **Select a Term** from the dropdown menu

7) Click **Add Course to Plan**

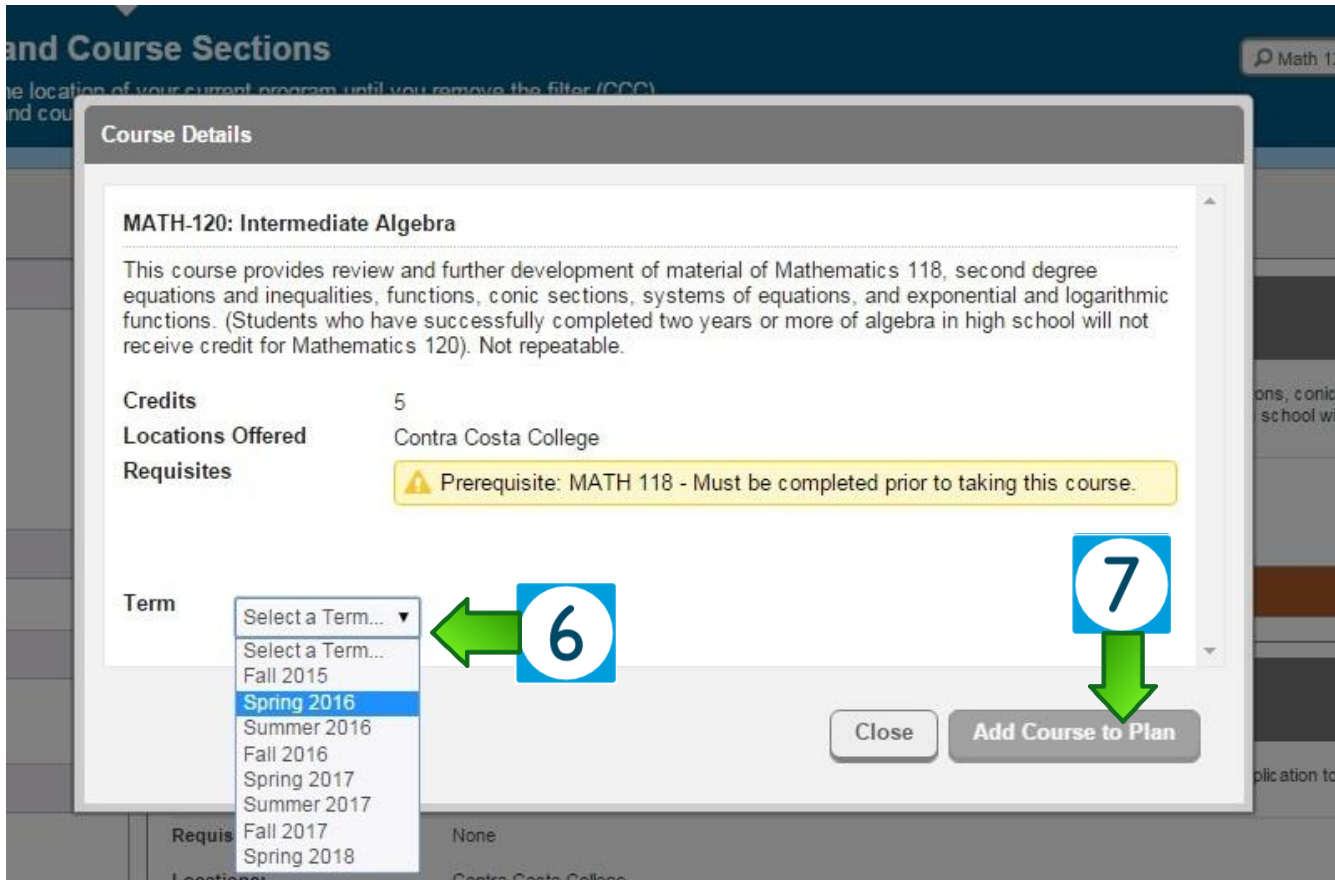

8) Return to **Plan & Register** Select the term using the arrows

9) Click **View other sections** to select a section for each class

10) Click **Register Now** after selecting your sections

